

FORM B - BUILDING SURVEY

MASSACHUSETTS HISTORICAL COMMISSION
Office of the Secretary, State House, Boston

1. Is this building historically significant to:
Town _____ Commonwealth _____ Nation _____

Building has historical connection with the following themes: (see also reverse side)

- | | |
|---------------|------------------------------|
| Scholar | Commerce/industry |
| Agriculture | Science/invention |
| Art/Sculpture | <u>Travel</u> /communication |
| Education | Military Affairs |
| Government | Religion/philosophy |
| Literature | Indians |
| Music | Other _____ |

Development of town/city _____

Architectural reason for inventorying: _____

2. Town Chelmsford

Street address 109 Billerica Road

Name J. S. Spaulding House

Use: original & present Tavern? - Residence

Present owner Dr. & Mrs. Benjamin Gaieski

Open to public _____

Date 1700's Style _____

Source of date _____

Architect _____

OR part of Area # _____

3. CONDITION Excellent Good Fair Deteriorated Moved Altered Added

4. DESCRIPTION

FOUNDATION/BASEMENT: High Regular Low _____ Material Basement wall - fiddstone with brick Tapping granite blocks - foundation

WALL COVER: Wood Lapped clapboard _____ Brick Stone Other butted - new addition

ROOF: Ridge Gambrel Flat Hip Mansard _____
Tower Cupola Dormer windows Balustrade Grillwork 1 on old ell

CHIMNEYS: 1 2 3 4 _____ Center End Interior Irregular Cluster Elaborate

STORIES: 1 2 3 4 ATTACHMENTS: Wings Ell Shed _____

PORCHES: 1 2 3 4 _____ PORTICO 1 Balcony _____

FACADE: Gable end: Front side Ornament _____

Entrance: Side Front Center Side Details: plasters side vertical windows (3 panes), 2 granite block step

Windows: Spacing: Regular Irregular Identical Varied 5 Bay x 2 Bay, Gable window over 6 panes

Corners: Plain Pilasters Quoins Cornerboards

5. Indicate location of building in relation to nearest cross streets and other buildings

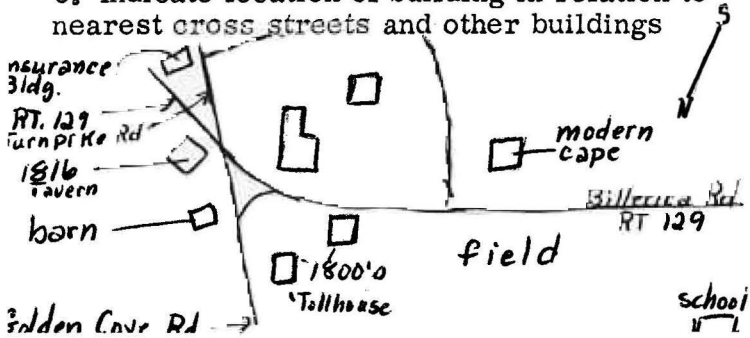

6. Footage of structure from street 18

Property has 371 feet frontage on street

Recorder Jane Drury

For Chelmsford Historical Commission

Photo # 3-14 Date 10/4/72

RELATION OF SURROUNDING TO STRUCTURE

1. Outbuildings old barn - corner boards, wooden pegs, weathered shingles (once painted red)

2. Landscape Features: Agriculture Open Wooded Garden: Formal/Informal
Predominant features field, shrubbery, trees, wooded in the rear
Landscape architect _____

3. Neighboring Structures
Style: Colonial Federal Greek Revival Gothic Revival Italian Villa Lombard Rom.
Venetian Gothic Mansard Richardsonian Modern early + mid 1800's
Use: Residential Commercial Religious Conditions: Excellent Good Fair Deteriorated

GIVE A BRIEF DESCRIPTION OF HISTORIC IMPORTANCE OF SITE (Refer and elaborate on theme circled on front of form)

Little is known about the early history of this house, but it is located at the junction of one of the early roads in town (Billerica Rd. - RT. 129) and the Middlesex Turnpike, which was chartered on June 15, 1805 and took travel between Boston and Nashua. According to Waters' History, Joseph Manning was keeping a Tavern in the house in 1816, when Jonathan Manning built another Tavern diagonally across the street. Benjamin Chamberlain succeeded Joseph and "supplied entertainment for man and beast at this place." The opening of the Boston and Lowell Railroad in 1835 took away much of the trade from the Turnpike and the Taverns.

BIBLIOGRAPHY AND/OR REFERENCE

Waters: History of Chelmsford (1917)
1831 map
1875 Beers Atlas

RESTRICTIONS _____

Original Owner: _____
Deed Information: Book Number _____ Page _____, _____ Registry of Deeds

J.S.Spaulding House
109 Billerica Rd.

Age:

Waters' "History" claims this house to be "one of the oldest in Chelmsford. The early deeds for this house are very confusing. The rear (left) ell is also quite old, as evidenced by its purlin roof, $\frac{1}{2}$ log cellar stairs and granite slab cellar stairs (granite has been quarried in Chelmsford since the early days of the town), strap hinges on doors, lapped clapboard, etc. The small addition on the right rear was added in the early 1900's, according to the present owner.

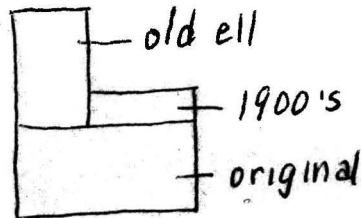

Roof:

Original house - looks older than the old ell roof but is not purlin. Wooden pegs in beams. Wide floorboards.
Old ell - purlin. Dormer window.

Chimneys: 3

1. Rear of old ell - serves no present function; stops at 1st floor ceiling.
2. Left (original house) - supported by big brick arch in basement, containing 2 drying ovens in excellent condition. One of these ovens is very large: 6'9" high x 3'3" deep x 2'4" wide (inside measurements)
3. Right (original house) - unable to see bottom of chimney; no basement there.

Attachments:

Old ell - contains the kitchen with fireplace and brick oven. It's ceiling was uncovered by the present owners, revealing rough beams; many cornhusks were between the layers of ceiling. Behind the kitchen is a shed room, which contained a few animal stalls. The presently used $\frac{1}{2}$ log, pegged stairs to the cellar leave from this room as well as do the old granite slab stairs, which leave via a hatchway in the floor. At the rear of the ell is a four seat privy and stairs to the 2nd floor and to the ell attic. This attic is not accessible from the main attic.
New addition - built in the early 1900's, contains bath and den.

Barn:

Old, cornerposts, wooden pegs in beams, wide floorboards.
Cellar - under left third of barn; fieldstone and mortar walls except on right wall, where blocks (granite) are just piled up with no mortar.

Other architectural features:

Stone lined well in the basement similar to a now filled-in well under the driveway. "Indian shutters" in the two front downstairs rooms. Five fireplaces, all different. Wide floor boards in attic; irregular sizes elsewhere. Beautifully preserved beehive oven in kitchen. "Inner room" on first & second floors behind the so-called "Captains Staircase", between left & right front rooms. There is a door into it from the right rooms; downstairs, the "inner room left wall has been removed - the owner theorizes that this may have been the location of the tavern's bar. There is poorer workmanship in this room. The staircase has the original plain balusters or a very good reproduction.

109 Billerica Road
Middlesex North District Registry of Deeds

| | | |
|-------------------|------------|---|
| Bk. 2059, pg. 300 | 04/09/1973 | Benjamin J. Gaieski to Constance F. Gaieski, 109 Billerica Rd. love & affection 41,310 sq. ft. & buildings north side Billerica Rd., southwest side Turnpike Rd. Peters plan, plan. bk. 96, pl. 20 same: Peters deed, bk. 1543, pg. 174 |
| Bk. 1543, pg. 74 | 01/05/1962 | Richard W. & Mary F. Peters to Benjamin J. & Constance F. Gaieski consideration paid 41,310 sq. ft. & buildings north side Billerica Rd., southwest side Turnpike Rd. Peters plan, plan. bk. 96, pl. 20 same: Myrick 1957 deed, bk. 1382, pg. 328 |
| Bk. 1382, pg. 328 | 09/19/1957 | Roger D. & Marjorie T. Myrick to Richard W. & Nancy F. Peters, Tyngsborough consideration paid land & buildings: south side Billerica St. & west side Turnpike Rd. Monahan plan, plan bk. 74, plan 30. subject: taxes & rights of Lowell Electric Light Corp. Reg. bk. 1371, 117 same: Gordon 1949 deed, bk. 1110, pg. 341 |
| Bk. 10, pg. 341 | 02/25/1949 | Josephine Gordon, unmarried, to Roger D. & Marjorie T. Myrick, Melrose consideration paid land & buildings: south side Billerica St. & west side Turnpike Rd. Monahan plan, plan bk. 74, plan 30. same: part of Worthen 1946 deed, bk. 1058, pg. 386 |
| Bk. 102, pg. 377 | 10/09/1948 | Walter E. & Priscilla A. Bedell to Josephine Gordon consideration paid land & buildings: south side Billerica St. & west side Turnpike Rd. Monahan 1948 plan, plan bk. 74, plan 30. same: part of Worthen 1946 deed, bk. 1058, pg. 386 |
| Bk. 1058, pg. 386 | 11/24/1946 | Maurie R. Worthen, Waterbury, Conn., unmarried, to Walter E. & Priscilla A. Bedell, Wilmington 6 acres land & buildings: south side Billerica St. subject: N.E. Power Engineering & Service Co. 1931 grant bk. 655, pg. 253 Minot Lovering: died 1942 1935 agreement, bk. 866, pg. 225, right to occupy premises during his life |

| | | |
|---|------------------------|--|
| Bk. 655, pg. 253 | 1/16/1921 | Minot H. Lovering; Ruth L. Ryan, Waltham; Bessie T. Montgomery, Los Angeles, Cal. to Meurle R. Worthen consideration paid 6 acres land & buildings: south side Billerica St. same: Spalding 1892 deed, bk. 242, pg. 499 except: 1915 taking by Co. Commissioners, Reg. bk. 549, pg. 495 Mary S. Lovering died intestate |
| Bk. 242, pg. 499 | 12/31/1892 | Jacob Spalding to Mary S. Lovering \$2300 6 acres land & buildings: south side Rd. from Chelmsford to Billerica same: part of 1863 Harvey deed, bk. 33, pg. 246 |
| Bk. 33, pg. 246 | 04/03/1863 | Samuel W. Harvey, yeoman, to Jacob Spalding, yeoman \$2500 23 acre farm: dwelling house, barn, sheds: Rd. leading from Chelmsford to Billerica 10 acres & 53 sq. rods meadow & upland: near Golden Cove Brook |
| Bk. 9, pg. 276 | 04/28/1857 | Lydia B. Hunt, Lawrence, single woman, to Samuel W. Harvey, yeoman \$1800 23 acres land & buildings 1) land bounded the Road & old Middlesex Turnpike 2) beginning at intersection of Road leading from Joseph Mannings same: 1855 Chamberlain deed, bk. 2, pg. 358 |
| Bk. 2, pg. 358 | 07/03/1855 | Benjamin Chamberlain, Wilton, New Hampshire, yeoman, to Lydia B. Hunt, Westminster \$500 23 acres land & buildings: near center of Chelmsford |
| North: bk. 14, p. 596 South: bk. 488, p. 410 | 10/08/1845 mortgage | Thomas Howe, trader, to Lydia B. Hunt, Lowell \$880 23 acres & buildings 1) land bounded by land of Joseph Manning & Middlesex Turnpike 2) land bounded by Middlesex Turnpike |
| | 06/18/1852 | Lydia B. Hunt made open & peaceable entry for a breach of conditions |
| North: bk. 15, p. 596 | 10/08/1845 mortgage | Thomas Howe, trader, to Lydia B. Hunt, Lowell \$1880 2 pieces of land: 23 acres & buildings |
| North: bk. 14, p. 345 | 07/09/1839 mortgage | Thomas Howe, Boston, trader, to Benjamin Chamberlain, yeoman \$2900 6 pieces of land: 85 acres & buildings |
| | 09/02/345 | Benjamin Chamberlain made entry for purposes of foreclosing mortgage |
| North: bk. 14, p. 343 | 07/ /1839 | Benjamin Chamberlain, yeoman, to Thomas Howe. Boston, trader \$3600 6 pieces of land: 85 acres & buildings [includes both 109 Billerica & 47 Golden Cove Rds.] |

| | | |
|--|------------|---|
| North: bk. 13, p. 255 | 02/01/1834 | Benjamin Chamberlain, yeoman, to Joseph Manning, yeoman \$2000 3 lots 1) 1½ acres & buildings reserving: right to pass on said land 2) 2 acres & store 3) [another lot] |
| North: bk. 8, p. 423 South: bk. 213, p. 61 | 09/27/1815 | Royal Makepeace, Cambridge, merchant, to Benjamin Chamberlain, trader \$800 2 lots 1) 1½ acres & buildings 2) ½ acre & store same: Fiske & Bridge deed, bk. 9, pg. 521 |
| North: bk. 9, p. 521 South: bk. 196, p. 410 | 12/19/181 | William Fiske & Willaim Stoddard Bridge, traders, to Royal Makepeace, Cambridge, merchant \$1800 1) 1½ acres & buildings 2) ½ acre & buildings reserving: lease to Thomas Harrison until 4/10/1813 |
| North: bk. 9, p. 100 South: bk. 155, p. 372 | 01/19/1804 | Benjamin King Haggar, mathematical instrument maker, to Benjamin Fiske & William Stoddard bridge, traders \$1000 1) 1½ acres & buildings 2) ½ acre & buildings 3) 10 acres land |
| North: bk. 9, p. 108 | 07/16/1803 | Azariah Spalding, yeoman, to Benjamin King Haggar, mathematical instrument maker \$500 1) 1½ acres & buildings 2) 10 acres land |

MORE DEED WORK NEEDED

Jonathan Manning
Exerpts from Rev. Ebenezer Bridge's Diary

- Dec. 3, 1777 Walked out before dinner as far as William Abbots Jonathan Mannings upon business.
- June 4, 1781 Went out as far as Jonathan Mannings upon business AM
- July 12, 1781 Went as far as Bill Abbots upon business, was in, at Jonathan Mannings - and at Doct^r Hasting's, and David Danforth's, upon business.
- July 18, 1781 Rode out AM as far as Jonathan Manning's upon business.
- Aug. 15, 1781 Visited Jonathan Manning AM a daughter of his sick and prayed with them.
- Aug. 27, 1781 Visited Jonathan Manning, his children several of them having been ill, but better.
- Sept. 17, 1781 Visited Jonathan Osgood, sick of a fever at Jonathan Manning's, and prayed with them.
- March 21, 1782 Walked out AM and visited Ephraim Peirce, Oliver Parker Jonathan Manning - the Doct^r.
- June 2, 1782 Baptised Lydia daughter of Jonathan & Martha Manning.
- Aug. 10, 1782 Walked as far as Jonathan Manning's upon business AM, as also to the Widow Gra. Fletcher's.
- June 26, 1786 Rode as far as Mr. Manning's ~~upon-business-AM,-as-also-~~ with my son the Colonel in chaise and gave a short visit there and at Azariah Spaulding's, while my son was about business at the tann house then rode the back way, and came home by late Col. Spaulding's house & etc.....
- June 26, 1787 Walked down as far as Jonathan Manning's A. Stopped at Mrs. Cory's upon business.
- Nov. 4, 1790 Mr. Osgood a young preacher who used to live in this town as a tanner (but since has had a liberal education at New Haven) visited me. Mr. Osgood preached.

J.S.Spaulding House
109 Billerica Rd.

Waters, History of Chelmsford

Pg. 397 "The substantial colonial building at the Town Farm was built by Jonathan Manning, in 1816. Joseph Manning kept a hostelry at this place, as did Messrs. Larcom, Wyman, Moseley and Piper, previously. The opening of the Boston and Lowell railroad, in 1835, took away the trade from this, as well as other taverns. It closed in 1838. Across the Billerica road, from the Manning Tavern, at what is known as the Lovering place, (one of the oldest houses in Chelmsford), Joseph Manning had kept a tavern. Benjamin Chamberlain succeeded him and supplied entertainment for man and beast at this place. #

Records of First Congregational Society of Chelmsford, pg. 5

Pg. 5 "1831 Voted: Selectmen - Otis Adams, Charles Barber, Joel B. Constable - James Pitts
Clerk of Society - Dr. John C. Dalton
Standing Committee - Major Joseph Manning

Waters, History of Chelmsford

Pg. 683 "March 1, 1831. Dr. John C. Dalton was chosen clerk; Capts. Otis Adams, Caleb Abbott and Maj. Joseph Manning were chosen a standing committee."

Beers Atlas (1875): owner is J. Spaulding.

Lowell Weekly Journal:

Thursday, March 7, 1895 - A. Fletcher Spaulding of Lexington, who died this week, was the son of our venerable townsman, Mr. Jacob Spaulding, and formerly resided here. Those who were acquaintances of his earlier years cherish very pleasant memories of him.

June 30, 1899 - Centenarians are not yet common, and are few who reach four score and ten. One of the latter is Mr. Jacob Spaulding of Chelmsford, who Monday observed his 90th birthday at his home in Billerica street which is presided over by his widowed daughter, Mrs. Mary S. Lovering. Mr. Spaulding is a native of Billerica but Chelmsford has been his home for nearly half a century and here his honorable and industrious life has won the respect and esteem of his fellow townsmenMr. Spaulding received in his rolling chair as for nearly two years he has been unable to walk. His general health is good and his mind clear.

Lowell Courier-Citizen:

Feb. 28, 1909 - Miss Esenath Manning Chamberlain, a life long resident of Chelmsford, died early on Sunday morning at the home of her nepegew, E.C. Wright, aged 80 years, eight months, 21 days. For more than four years past Miss Chamberlain, or Aunt 'Senath, as she was familiarly known by a wide circle of friends, had been confined to her bed as the result of a shock of paralysis. She was the daughter of Benjamin Chamberlain and was born at the house on Billerica street now occupied by Mrs. Mary Lovering. She is survived by two nephews, E.C. Wright and George B.B. Wright of Chelmsford, a neice, Mrs. A.M. Page of South Framingham, and two cousins, Mrs. Julia E. Warren of Chelmsford and Mrs. Jane Short of Lowell.

Jan. 31, 1910 - Mrs. Mary Lovering is in a serious condition at her home at the corner of Billerica street and the Turnpike road, as the result of a shock received early on Sunday morning.

Mrs. Lovering, who has been in her usual health, was overcome as she was dressing, and when found, was in an unconscious condition. The left side was affected and through the day she did not rally very much, but had today been able to converse a little.

Feb. 7, 1910 - Mrs. Mary S. Lovering who had been in a critical condition for the past week from a shock, died at her home on the Billerica street early this morning, aged 77 years, 11 months, and four days. Mrs. Lovering was among the older residents of the town and was held in regard by all who knew her for her many excellent qualities. She was born in West Billerica and removed to Chelmsford with her father, the late Jacob Spaulding, more than 40 years ago. She is survived by a son Minot H. Lovering and two brothers, Gardner Spaulding and Leonard Spaulding all of Chelmsford. A notice of the funeral appears in another column.

Chelmsford Newsweekly
July 8, 1954



HOUSE MAY BE MOVED---On July 19th the Board of Selectmen will meet with the County Commissioners to learn about plans to move the house shown in this picture back about 50 feet or to learn some other plan. At this particular point Billerica Road Golden Cove Road and Turnpike Road meet with this house blinding the view of traffic. With the new school to be located in the back ground behind the brush, the Selectmen see the need for making this hazard more safe for buses with children to travel.

NEWSWEEKLY, THURSDAY, OCTOBER 11, 1970



CMFD-VISITING HER OLD HOME on October 4 was Mrs. Ida Lovering Foster, now of Benton, La., but for many years a resident of the Westlands section here. As a child, she lived in the house at the corner of Billerica and Turnpike Roads now restored and occupied by Dr. and Mrs. Benjamin Galeski. Here Mrs. Galeski and Mrs. Foster inspect the old oven in the kitchen of the former Lovering home, once a tavern on the turnpike between Boston and New Hampshire. (Photo by Regina Linsley)

May 20, 2004

Building Inspector
Town Hall
Billerica Road
Chelmsford, Ma 01824

Sir,

The barn at 109 Billerica Road has been reviewed. Pictures have been taken. While the barn is old and is historic it has no special significance. Demolition may proceed.

Sincerely,



George L. Merrill
Historic Commission





109

8/8/2004 F. Merriam



9/10/2004 E. Merriam



