

FORM B - BUILDING

MASSACHUSETTS HISTORICAL COMMISSION
 MASSACHUSETTS ARCHIVES BUILDING
 220 MORRISSEY BOULEVARD
 BOSTON, MASSACHUSETTS 02125

Assessor's Number USGS Quad Area(s) Form Number

84/334/2/1 Billerica 056

Town Chelmsford

Place (neighborhood or village) Chelmsford Center

Photograph



Sketch Map

Draw a map showing the building's location in relation to the nearest cross streets and/or major natural features. Show all buildings between inventoried building and nearest intersection or natural feature. Label streets including route numbers, if any. Circle and number the inventoried building. Indicate north.

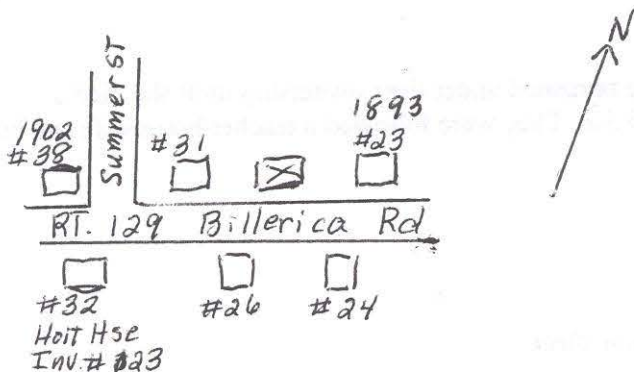

Address 27 Billerica Rd.

Historic Name Holt/MacElroy House

Uses: Present residence

Original residence

Date of Construction summer of 1911

Source Lowell Daily Courier, Oct. 13, 1911
 tax records

Style/Form Victorian

Architect/Builder

Exterior Material:

Foundation fieldstones

Wall/Trim clapboard

Roof hip/shingles

Outbuildings/Secondary Structures none

Major Alterations (with dates)

enclosed 1 story porch added at rear (west); date unknown;
 has cement foundation
 dormer on front side an addition?
 small bay window on south side an addition? perhaps
 between 1971 & 2001

Condition excellent

Moved no yes Date

Acres 10,848 sq. ft.

Setting residential

Recorded by Jane B. Drury

Organization for Chelmsford Historical Commission

Date (month / year) December 2003

BUILDING FORM

ARCHITECTURAL DESCRIPTION *see continuation sheet*

Describe architectural features. Evaluate the characteristics of this building in terms of other buildings within the community.

This single family residence at 27 Billerica Rd. is typical of many other houses constructed in Chelmsford during the early part of the 20th century. It originally contained six rooms, but in 2003 it has eight room, including 3 bedrooms and 1 ½ baths. The front porch has columns at each corner and one beside the stairs. Fancy brackets are attached between the porch roof and the columns but none at the main roof and the eaves. Cornerboards are on all four sides of the house. A small window to the right of the front door has patterned panes. Inside the house the walls are said to be made of horsehair plaster.

HISTORICAL NARRATIVE *see continuation sheet*

Discuss the history of the building. Explain its associations with local (or state) history. Include uses of the building, and the role(s) the owners/occupants played within the community.

Born in Laconia, NH, Miss Emma Etta Holt lived with her parents, Horace and Nancy Holt, in an old house across the street from 27 Billerica Rd. She continued to reside in the old house for four years after inheriting it from her widowed mother in 1907. During the summer of 1911 she sold it with much of the land. However, she reserved a building lot on the southerly side of the street for herself. By August foundations were being "put in for a six room house with modern improvements." The new owner of the old house took occupancy of that residence in November of 1911. Emma's house at 27 Billerica Rd. was completed by then and she probably moved in about the same time. She remained at 27 Billerica Rd. until she was found dead in her home on Sept. 10, 1931. She was then 73 years old.

Bertha M. and Archibald G. MacElroy were the next owners, and the house remained under their ownership until she died a widow in 1991. Her husband, who had died 30 years earlier, was an electrician. They were followed a teacher/housewife and her husband, an electrical engineer.

BIBLIOGRAPHY and/or REFERENCES *see continuation sheet*

Lowell Daily Courier, Oct. 13, 1911
Lowell Courier Citizen, Aug. 1, 1911
Chelmsford Assessors' records; Town Clerk's records
Middlesex North District Registry of Deeds: Bk. 476, pg. 213, Sept. 30, 1911
Chelmsford St. Directories
Exterior house visit: 2001 by T. Prescott & F. Gullion
Mrs. Mary Cleven, neighbor

Recommended for listing in the National Register of Historic Places. *If checked, you must attach a completed National Register Criteria Statement form.*

INVENTORY FORM CONTINUATION SHEET

Town
CHELMSFORD

Property Address
27 BILLERICA RD.

MASSACHUSETTS HISTORICAL COMMISSION
MASSACHUSETTS ARCHIVES BUILDING
220 MORRISSEY BOULEVARD
BOSTON, MASSACHUSETTS 02125

Area(s) Form No.

Assessors' Records

June 4, 1971

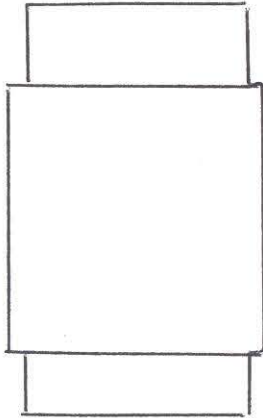

1996, 2001

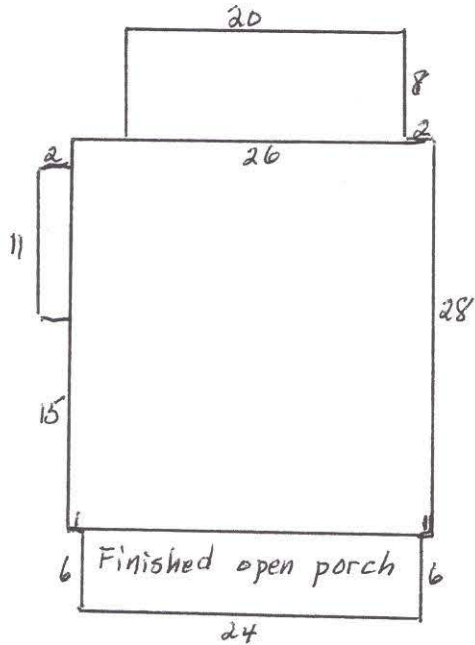

*Basement, attic unfinished
Reroof 1996*

27 Billerica Road
Middlesex North District Registry of Deeds

Bk. 8500, pg. 073	04/01/1997	Christopher M. & Shannon J. King, 27 Billerica Rd. to Brian C. Hewitt, 225 Main St., North Chelmsford \$146,000 10,847 & 78/100 sq. ft. & buildings 1911 Emma Holt plan subject: easement of same date to Martha McClure, 23 Billerica Rd. 1977 Howe plan 193, pg. 110 same: 1991 Stewart deed
Bk. 5635, pg. 145	09/03/1991	Estate of Bertha M. Macelroy to Christopher M. & Shannon J. King, 27 Billerica Rd. \$125,000 10,847 & 78/100 sq. ft. & buildings Bertha M. MacElroy d. January 10, 1991 Archibald G. MacElroy d. 1961 same: 1 st parcel 1955 Bertha M. to Bertha M. & Archibald G. MacElroy, bk. 1305, pg. 11. See also Bk. 807, pg. 214
Bk. 1305, pg. 11	08/18/1955	Bertha M. MacElroy to Archibald G. & Bertha M. MacElroy 2 parcels: 1. 10,847.78 sq. ft. – 1911 Emma Holt plan 2. 31,954 sq. ft. – 1937 MacElroy plan
Bk. 807, pg. 214	09/24/1931	Estate of Emma E. Holt to Bertha M. MacElroy \$3600 10,847.78 sq. ft. & buildings thereon – 1911 Emma Holt plan
Bk. 476, pg. 213	09/30/1911	L. Maude Holt, Tilton, NH to Emma E. Holt 2 parcels: 1. north side of Billerica Rd. 0.51 acres & buildings thereon 2. south side Billerica Rd. 9.89 acres & 10847.78 sq. ft. – 1911 Holt plan L. Maude Holt – granddaughter of Nancy E. Holt & unnamed in will
Middlesex Probate Docket #74850	d. 5/10/1907	Estate of Nancy E. Holt to Emma E. Holt, daughter
Middlesex Probate Docket #4782	d. 5/25/1898	Estate of Horace Holt to Nancy E. Holt, wife
Bk. 24, pg. 181	06/02/1860	Isaac Reed, Acton, to Horace Holt, Deening, NH \$2200 12 acres & buildings thereon – both sides of Billerica Rd.

27 Billerica Road

Lowell Daily Courier:

Oct. 13, 1911 - Final papers have been passed by Byam Bros. for Miss Emma Holt, for the transfer of her property in Billerica street, to Mr. Harry Mozeley of Wakefield Highlands. Mr. Mozeley, who has mining interests in the west, buys for occupancy and is to take possession about November 1. The property consists of a 2-story, old fashioned farm house with L, and large barn, all in excellent condition and about 12 acres of improved land. Miss Holt reserved a building lot on the southerly side of the street next to the residence of Robert E. Murphy and during the summer has had erected an attractive house of six rooms with modern conveniences.

Chelmsford Assessors' Office, Sept. 1979:

plat 128, lot 13, block 36

1972 owner: Macelroy, Bertha M., 27 Billerica Rd.
1084 sq. ft \$3450
house 16050

8/19/1955 deed, Bk. 1305, pg. 11 grantor: Bertha M. Mac Elroy
Notes: As tenants by entirety 4/30/1960, Bk. 1841, pg. 197
to Town of Chelmsford, part of Lot 11 (for road)
6/6/1968, Bk. 1845, pg. 709 to Robert Grant and Ellen
Macelroy, Lot 11, Bk. 60, Plan 69.



27 Billerica Road

3/13/2005 F. Merriam



27 Billerica Road

3/13/2005 F. Merriam

