

FORM B - BUILDING

MASSACHUSETTS HISTORICAL COMMISSION
Office of the Secretary, State House, Boston

In Area no.	Form no.
	221

1 Town Chelmsford

Address 55 Boston Road

Name Lucinda Manning House

Present use Residence

Present owner James E. Scarth

3 Description

Date 1860 - 1862

Source deeds, tax lists

Style _____

Architect _____

Exterior wall fabric siding

not old

Outbuildings (describe) 2 garages (1 car ea.

Other features land at rear of house

divided by 4 stonewall terraces

Altered _____ Date _____

Moved no Date _____

5 Lot size

One acre or less x Over one acre
24,850 sq. ft.

Approximate frontage 110 feet

Approximate distance of building from street

25 feet

6. Recorded by Jane B. Drury

Organization Chelmsford Hist. Commission

Date June 26, 1976

2. Photo (3x3" or 3x5")
Staple to left side of form
Photo number _____

4 Map. Draw sketch of building location
in relation to nearest cross streets and
other buildings. Indicate north.

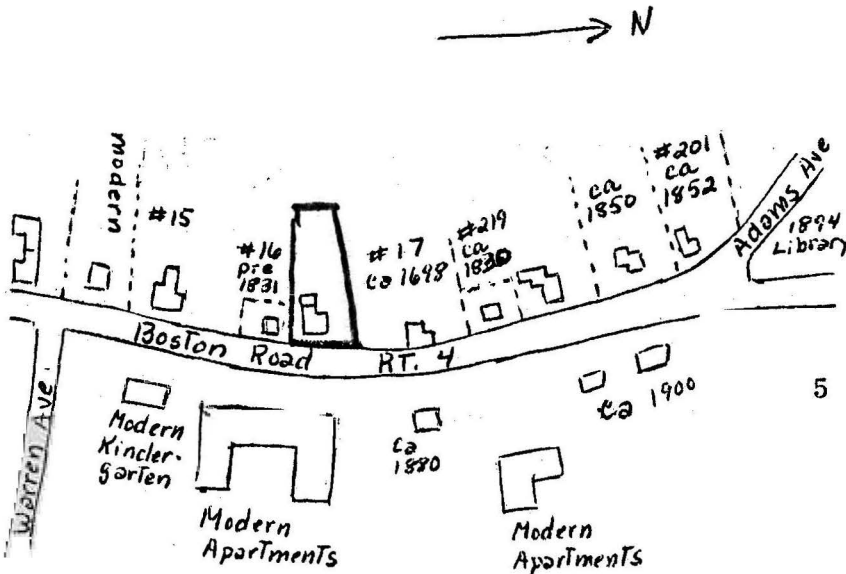

DO NOT WRITE IN THIS SPACE
USGS Quadrant _____

MHC Photo no. _____

(over)

7. Original owner (if known) Miss Lucinda Manning

Original use residence

Subsequent uses (if any) and dates _____

8. Themes (check as many as applicable)

- | | | | |
|-----------------------|----------------------------|-------------------------------------|-------------------------|
| Aboriginal | Conservation | | Recreation |
| Agricultural | Education | <input checked="" type="checkbox"/> | Religion |
| Architectural | Exploration/
settlement | <input type="checkbox"/> | Science/
invention |
| The Arts | Industry | <input type="checkbox"/> | Social/
humanitarian |
| Commerce | Military | <input type="checkbox"/> | Transportation |
| Communication | Political | <input type="checkbox"/> | |
| Community development | | | |

9. Historical significance (include explanation of themes checked above) This house was built between 1860-1862, its first owner being Lucinda Manning, on land bought from her cousin Joseph Manning, who lived nearby at 65 Boston Rd. (#15). Lucinda was born in 1790 in the old Manning Tavern (see Billerica inventory) and taught school for 30 years. In the final years of her life she left the old Billerica homestead to reside in her new house at 55 Boston Rd., where she died Aug. 10, 1880, unmarried, of old age.

Lucinda Manning willed the house to her neice Lucinda Parkhurst, who was the daughter of John Parkhurst and grew up at 167 North Rd. (#47). She also died a spinster on Nov. 10, 1892, and she willed the house to her sister Jerusha Jane.

Jerusha Jane Parkhurst was the youngest of 12 children of John and Surviah (Manning) Parkhurst. She and her husband, John S. Shed, lived across Boston Road in a house now (1976) gone. She died in 1900 at age 73 years, having been a widow for 3 years. Her executors sold the house at 55 Boston Rd. out of the family in 1906. The new owner was Emma George, the wife of David George, a pattern maker.

10. Bibliography and/or references (such as local histories, deeds, assessor's records, early maps, etc.)

- 1856 Walling's map
- 1875 Beers Atlas
- Middlesex North District Registry Deeds, Book 20, pg. 394
- Joseph Manning to Lucinda Manning, 7/26/1859
- Chelmsford Tax Valuation List, 1863
- The Manning Family Genealogy, by William H. Manning (1902)



55 Boston Road
Middlesex North District Registry of Deeds

Book 1941, pg. 234 11/13/1970 Anthony G. Macone to
John F. & Cecilia M. Paul
96 sq. rods & buildings

Book 1203, pg. 95 8/19/1952 Eleanor M. Cluett (formerly leighton) to
Anthony G. Macone
96 sq. rods & buildings

Book 924, pg. 447 12/30/1938 Estate of William James Marshall to
Ralph J. & Eleanor M. Leighton
96 sq. rods & buildings

Book 836, pg. 9 10/ 2/1933 Ella M. Melvin to
William J. Marshall
96 sq. rods & buildings
well restriction

Book 398, pg. 398 12/11/1906 Emma George to
Ella M. Melvin
96 sq. rods & buildings
well restriction

Book 330, pg. 546 1901 Estate of Jerusha J. Shed to
Emma George
96 sq. rods
well restriction
\$1525

Probate

Estate of Lucinda Parkhurst to
Jerusha J. Shed

Book 20, pg. 394 7/26/1859 Joseph Manning to
Lucinda Manning, Billerica
96 sq. rods land
well restriction
\$120

Book 20, pg. 182 6/17/1859 Edwin H. Warren to
Joseph Manning
10 acres land & buildings
100 rods south of Meeting House
well restriction
\$1500

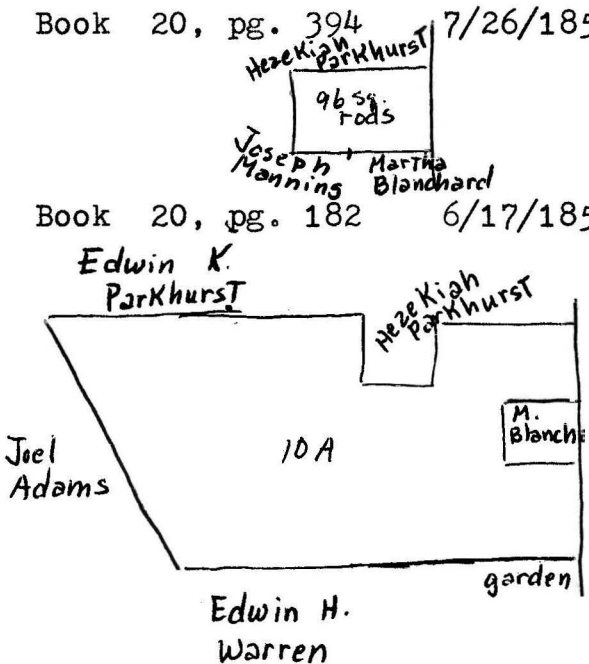

The first owner of the house at 55 Boston Road was Miss Lucinda Manning, the daughter of William and Sarah Manning of Billerica. She was born in the Manning Manse in Billerica, and this old homestead remained in the possession of Lucinda and her 7 unmarried brothers and sisters while they lived, adding year after year to the second century that it had been in the family. While old age fell heavily upon the house, one by one the brothers and sisters passed away. Miss Lucinda was the last survivor, and by her will the house was left to trustees who were to devote the annual income to religious instruction. Lucinda was a schoolteacher for thirty years, and in the final years of her life, she left the old Billerica homestead and built the house at 55 Boston Road in Chelmsford ~~from her cousin~~, where she died August 10, 1880.

Lucinda bought the land at 55 Boston Road from her cousin, Joseph Manning. Lucinda willed it to her ~~sister~~ niece, Lucinda Parkhurst, who in turn willed it to her ~~sister~~ sister, Jerusha Jane Parkhurst. Jerusha Jane was the widow of John Spaulding Shed, and they lived across the street in a house now gone. When she died, the house was sold to Emma George, the wife of David George, a pattern maker.



8/7/2004 F. Merriam