

FORM B – BUILDING

Assessor's Number USGS Quad Area(s) Form Number

MASSACHUSETTS HISTORICAL COMMISSION
MASSACHUSETTS ARCHIVES BUILDING
220 MORRISSEY BOULEVARD
BOSTON, MASSACHUSETTS 02125

39/ 117/ 5/ 1	Billerica		CLM.49
---------------	-----------	--	--------

Town/City: Chelmsford

Place: (*neighborhood or village*):

Photograph



Address: 5 Davis Rd (formerly 212 North Road)

Historic Name: Henry Spaulding III House

Uses: Present: Single-family dwelling

Original: Single-family dwelling

Date of Construction: c. 1801

Source: 2005 MHC Survey form

Style/Form: No style

Architect/Builder: Not known

Exterior Material:

Foundation: Stone, cut; Poured concrete

Wall/Trim: Vinyl siding/ Vinyl trim

Roof: Asphalt shingles

Outbuildings/Secondary Structures: None

Major Alterations (*with dates*): Extensive alterations since 2005 survey.

Condition: Fair

Moved: no yes **Date:**

Acreage: 0.92

Setting: The house is located on a major north-south state route in a mixed commercial and residential setting. Nearby houses range in date from the 18th through the 20th centuries.

Locus Map

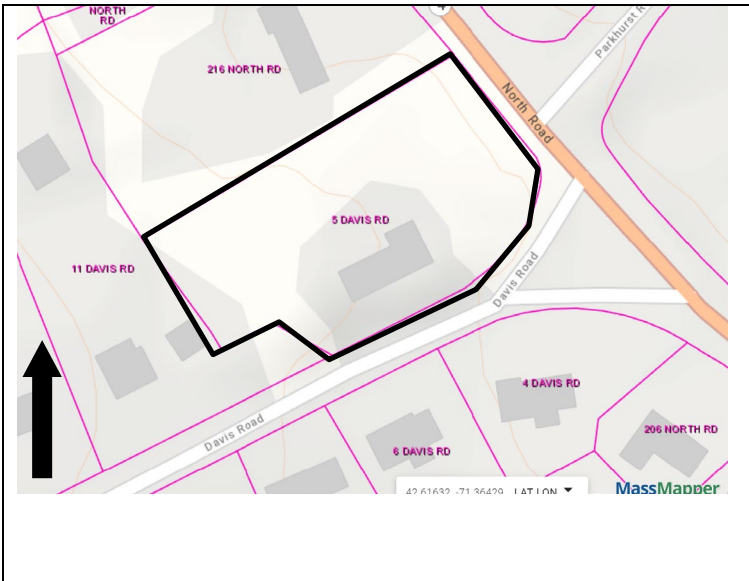

Recorded by: Stacy Spies, Historic Preservation Cons.

Organization: for Chelmsford Historical Commission

Date: March 2022

INVENTORY FORM B CONTINUATION SHEET

CHELMSFORD

5 DAVIS RD

MASSACHUSETTS HISTORICAL COMMISSION

220 MORRISSEY BOULEVARD, BOSTON, MASSACHUSETTS 02125

Area(s) Form No.

CLM.49

 Recommended for listing in the National Register of Historic Places.*If checked, you must attach a completed National Register Criteria Statement form.*

Use as much space as necessary to complete the following entries, allowing text to flow onto additional continuation sheets.

ARCHITECTURAL DESCRIPTION:

Describe architectural features. Evaluate the characteristics of this building in terms of other buildings within the community.

The house is located on a small rise overlooking the intersection of North Road (Route 4) and Davis Road. The T-plan house is oriented toward North Road to the east. The rectangular lot is planted in grass with mature trees near the perimeter of the lot. A wide paved driveway leads from Davis Road to the attached garage at the west end of the house.

The house has been extensively altered since it was last surveyed in 2005. It appears that the original house has been retained. The ell, however, has been removed and replaced with new construction that is similar in volume and size to its predecessor, if not materials or details.

The original house is the side-gabled block facing North Road. The block is five bays wide; the side elevations have been altered to now contain two bays of windows instead of one. Windows and doors throughout the original block are recent replacements that match the new construction at the ell. Details removed include the Greek Revival architrave located at the main entrance and paired Italianate cornice brackets.

A two-story, two-part ell extends from the rear of the west (rear) elevation. The center section has a gable roof with overhanging eaves. The west section of the ell has an asymmetrical gable roof with a cross-gabled dormer on the south elevation above the two garage bays. The ell rests on a poured concrete foundation. A shed-roof porch extends along the eastern two thirds of the south elevation (*i.e.*, along the main block and the east end of the ell.). The porch is supported by square-section posts and a wood floor. Windows and doors are of recent construction, consistent with the age of the ell.

HISTORICAL NARRATIVE

Discuss the history of the building. Explain its associations with local (or state) history. Include uses of the building, and the role(s) the owners/occupants played within the community.

Please see 2005 inventory form.

BIBLIOGRAPHY and/or REFERENCES

Beers, F.W. *County Atlas of Middlesex County*. New York: J.B. Beers & Co. 1875.

Chelmsford Tax Assessor records. 2021.

City Directories. Ancestry.com.

Findagrave.com.

Hales, John G. Plan of Chelmsford. 1831.

Middlesex North Registry of Deeds.

Middlesex South Registry of Deeds.

Massachusetts Census. Ancestry.com.

Massachusetts Vital Records. Ancestry.com.

Massachusetts Marriage records. Ancestry.com.

United States Census. Ancestry.com.

Walker, George H. & Co., *Atlas of Middlesex County*. Boston: George H. Walker & Co., 1889.

Walling, Henry Francis. *Map of Middlesex County*. Boston: Smith & Bumstead, 1856.

Waters, Rev. Wilson. *History of Chelmsford, Massachusetts*. Lowell: Courier-Citizen Company. 1917.

INVENTORY FORM B CONTINUATION SHEET

CHELMSFORD

5 DAVIS RD

MASSACHUSETTS HISTORICAL COMMISSION
220 MORRISSEY BOULEVARD, BOSTON, MASSACHUSETTS 02125

Area(s) Form No.

CLM.49

SUPPLEMENTARY INFORMATION



View looking west from North Road.



View looking northeast from Davis Road.

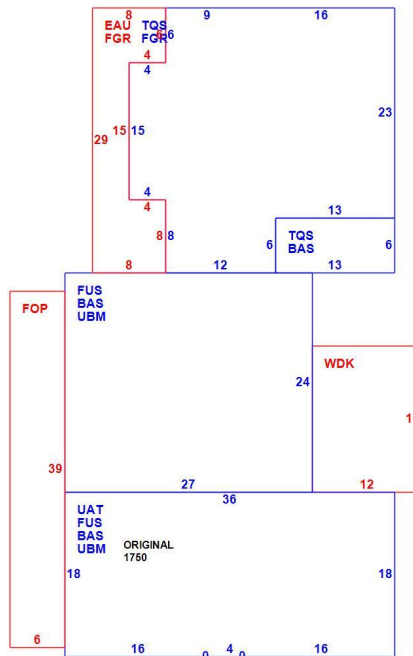

Assessor's sketch