

FORM B - BUILDING

MASSACHUSETTS HISTORICAL COMMISSION

In Area no.	Form no.
	84



town Chelmsford

Address 189 Main Street

Name Brick House

Present use residence: single famil

Present owner Francis & Dorothy Clog

Description \_\_\_\_\_

Date ca 1828

Source deeds, tax records

Style Georgian

Architect \_\_\_\_\_

Exterior wall fabric brick, painted

Outbuildings (describe) none

Other features 5 fireplaces; "Dutch" oven

Altered rear porch added Date 1970

Moved no Date \_\_\_\_\_

5. Lot size: 9600 sq. ft.

One acre or less  Over one acre \_\_\_\_\_

Approximate frontage 91.7 ft.

Approximate distance of building from street ca 24 ft.

6. Recorded by Diane Fay & Jane Drury

Organization Chelmsford Hist. Commissio

Date October 20, 1977

4. Map. Draw sketch of building location in relation to nearest cross streets and other buildings. Indicate north.

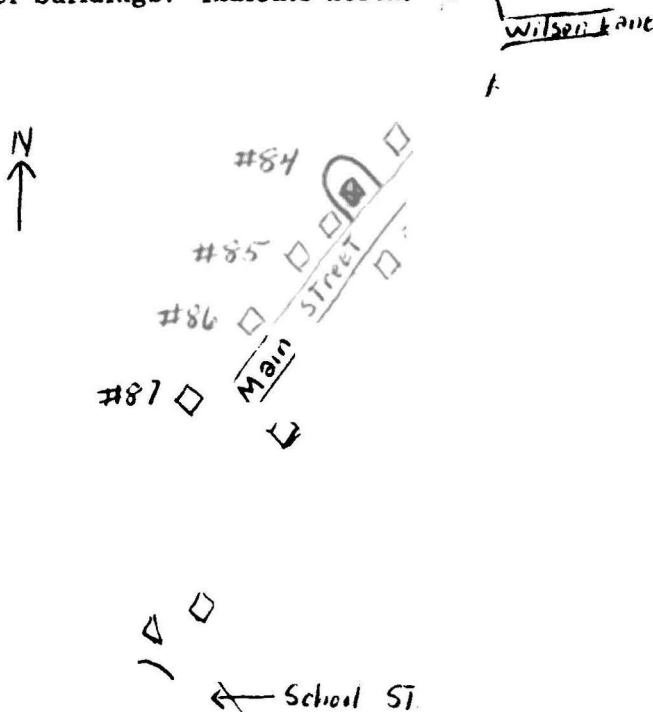

DO NOT WRITE IN THIS SPACE
USGS Quadrant _____
MHC Photo no. _____

(over)

7. Original owner (if known) Elias Messenger

Original use residence

Subsequent uses (if any) and dates \_\_\_\_\_

8. Themes (check as many as applicable)

Aboriginal	_____	Conservation	_____	Recreation
Agricultural	_____	Education	_____	Religion
Architectural	_____	Exploration/ settlement	_____	Science/ invention
The Arts	_____	Industry	_____	Social/ humanitarian
Commerce	_____	Military	_____	Transportation
Communication	_____	Political	_____	
Community development	<u>x</u>			

9. Historical significance (include explanation of themes checked above)

West Chelmsford as a village began with the building in the 1820s of 4 houses on the west side of Main St. and a nearby factory. This is one of the houses.

In March 1828 Elias Messenger purchased the house lot, and sometime before June 1830 he, a brick layer, built the 2-story brick dwelling. He and his brother George were employees of Deacon John Farwell, who had come from Fitchburg shortly after 1820 and started a scythe factory on Stony Brook, opposite the house. In 1836 Elias Messenger, then a trader living in Lowell, sold the house. Three months later the Farwells purchased it, and its ownership remained with the factory owners until 1924.

10. Bibliography and/or references (such as local histories, deeds, assessor's records, early maps, etc.)

1831 map; 1875 Beers Atlas

Waters, History of Chelmsford, page 672

Chelmsford Assessors' records, tax valuation lists

Middlesex North District Registry Deeds: Bk. 12, pg. 402 (1828); Bk. 12, pg 404 (1830), Plan Bk. 79, Plan 45 (1898)

INVENTORY FORM CONTINUATION SHEET

MASSACHUSETTS HISTORICAL COMMISSION  
Office of the Secretary, Boston

Community: . Chelmsford	Form No: 84
Property Name:	

Indicate each item on inventory form which is being continued below

Alterations:

1875 Beers Atlas

1898 Plar book 7 Plan

84.8

144.3

1970 Chelmsford Assessors' Evaluation Card

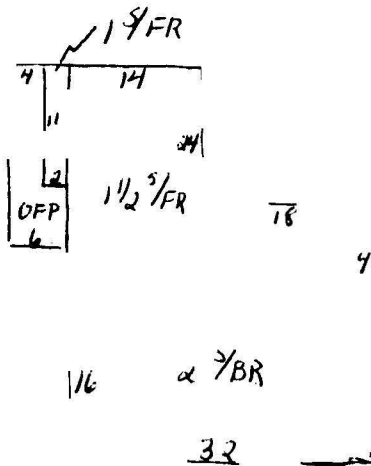

good condition in & out  
dwelling 2 S/FR  
garage - none  
single family  
stone foundation  
full basement  
walls - brick on masonry  
gable roof, asphalt shingles  
common floors  
fireplaces - 5  
no. rooms: 1st-5; 2nd-4  
framing - wood joists 3x4  
timber beams & cols  
wood rafters

Staple to Inventory form at bottom

189 Main Street

Book 1213, pg. 34	12/17/1952	Thyra L. Hudgings, Westford, unmarried, to Francis E. & Dorothy A. Clogston land & buildings thereon southeast portion of Lot E - Plan Book 45, Plan 79 (1898)
Book 1213, pg. 33	6/10/1952	Josephine Skelley, Westford, unmarried, to Thyra L. Hudgings, Westford land & buildings thereon southeast portion of Lot E - 1898 Plan
Book 1197, pg. 288	5/23/1952	Ana H. Clark, formerly Ana H. Nebes, Venice, Cal. to Josephine Skelley, Westford land & buildings thereon southeast portion of Lot E - 1898 plan
Book 1003, pg. 216	1/11/1944	Elizabeth L. Nes, Baltimore, Md. to Albert & Ana H. Nebes 17,225 sq. ft. & buildings thereon Lot E - 1898 plan
Book 716, pg. 313	11/28/1924	George C. Moore, Jr. to Elizabeth Linda Griffin, New York $\frac{1}{2}$ portion 1. land & buildings Lot E - 1898 plan 2. land & buildings southside of road, near Jonas Longley's house lot (Scythe factory)
Book 257, pg. 22	7/13/1894	Estate Charles G. Sargent, Westford, to George C. Moore \$4000 $\frac{1}{2}$ portion 1. near Jonas Longley's house lot (Scythe factory) 2. 10,000 sq. ft. & dwelling house and barn Excepting - land conveyed to John H. Whidden

-----  
Scythe factory deeds

Book 72, pg. 165	6/29/1869	George Stark, Nashua, N.H. to J.W.P. Abbott & Charles G. Sargent, both of Westford; & Josiah Gates, Lowell; & Christopher Roby \$10,000 1. Scythe factory 2. land & brick dwelling house
------------------	-----------	---

Book 58, pg. 416	9/27/1867	Jabez A. Sawyer, Cambridge, assignee of Christopher Roby, a bankrupt, to George Stark, Nashua, N.H. \$2,000 land, factory, buildings, water privilege, etc.
North: Bk. 16, pg. 163 South: Bk. 495, pg. 115	9/30/1846  (189 Main) (193 Main)	Frederick T. Sawyer to Christopher Roby, Gentleman \$6000 1. 15 A. - Scythe Manufactory & other buildings 2. 58 sq. rods - bounding lot 3 3. 71½ sq. rods & buildings - adjoining lot 2
North: Bk. 16, pg. 160 South: Bk. 495, pg. 113	9/28/1846  189 Main) 193 Main)	Lincoln Drake, Easton, to Frederick T. Sawyer, No. Chelmsford \$6000 1. 15 A. - Scythe Manufactory & other buildings 2. 58 sq. rods - bounding lot 3 3. 71½ sq. rods & buildings - adjoining lot 2
North: Bk. 16, pg. 128	8/ 1/1846  (189 Main) (193 Main)	John T. Farwell, Fitchburg, yeoman, to Lincoln Drake, Easton \$6000 1. 15 A. - Scythe Manufactory & other buildings 2. 58 sq. rods - easterly of above 3. 71½ sq. rods & buildings - adjoining lot 2
North: Bk. 13, pg. 515	6/ 8/1839 MORTGAGE	John Farwell, Chelmsford, & John T. Farwell, Fitchburg, Gentlemen, to Joseph Fletcher, Westford \$600 58 sq. rods & buildings
North: Bk. 14, pg. 66 South: Bk. 358, pg. 66	5/26/1836	George W. Perham, Lowell, Trader, to John T. Farwell & John Farwell, Gentlemen \$1500 58 sq. rods & buildings
North: Bk. 13, pg. 359	2/ 5/1836	Elias Messenger, Lowell, Trader, to George W. Perham, Lowell, Hatter \$1600 58 sq. rods & buildings

North: Bk. 12, pg. 404  
 South: Bk. 299, pg. 236

6/10/1830  
 MORTGAGE

Elias Messinger, bricklayer, to  
 Thomas J. Adams, inn-keeper  
 \$400  
 58 sq. rods land & 2 story brick house

North: Bk. 12, pg. 402  
 South: Bk. 299, pg. 234

3/17/1828

Jonas Keyes, Westford, yeoman to  
 Elias Messinger, bricklayer  
 58 sq. rods land

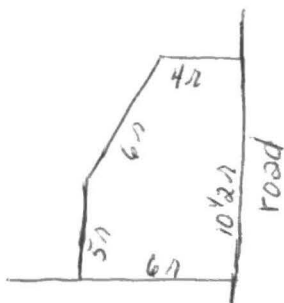



189 MAIN ST. &  
BARN CONVERTED TO A RESIDENCE, NOW 185 MAIN ST

Hoberman



189 Main Street







