

FORM B – BUILDING

MASSACHUSETTS HISTORICAL COMMISSION
MASSACHUSETTS ARCHIVES BUILDING
220 MORRISSEY BOULEVARD
BOSTON, MASSACHUSETTS 02125

Assessor's Number USGS Quad Area(s) Form Number

13/19/15	Nashua South	G	CLM.139
----------	--------------	---	---------

Town/City: Chelmsford

Place: (*neighborhood or village*): North Chelmsford

Photograph



Address: 34 Middlesex Street

Historic Name: Dr. Fred E. Varney House

Uses: Present: single-family dwelling

Original: multiple-family dwelling

Date of Construction: 1901

Source: 7/14/1901 article from the *Lowell Courier*

Style/Form: Neoclassical/Foursquare

Architect/Builder: unknown

Exterior Material:

Foundation: granite

Wall/Trim: wood siding/wood

Roof: asphalt shingle

Outbuildings/Secondary Structures:

Carriage house

Major Alterations (*with dates*):

See original CLM.139 Inventory Form for complete list

Condition: Fair

Moved: no yes **Date:**

Acreage: .31 A

Setting: The house is located at the northeast corner of Middlesex St. and Kennedy Dr., approximately 35' north of Middlesex St. A paved drive east of the house leads to the carriage house. The remaining lot is flat with mature trees. The surrounding area includes 19th and 20th c. residential development. The post office is to the north of the house.

Locus Map

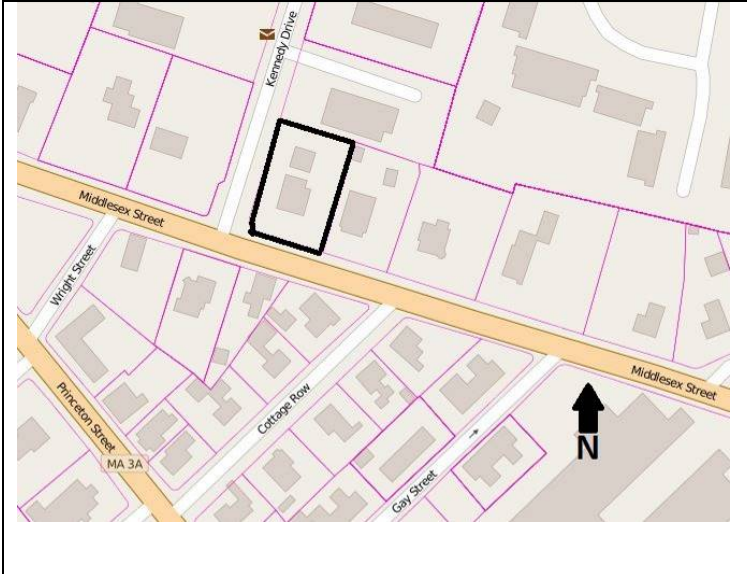

Recorded by: Jennifer Burden, Gray & Pape, Inc.

Organization: Chelmsford Historical Commission

Date (*month / year*): June 2016

INVENTORY FORM B CONTINUATION SHEET

CHELMSFORD

34 MIDDLESEX STREET

MASSACHUSETTS HISTORICAL COMMISSION

220 MORRISSEY BOULEVARD, BOSTON, MASSACHUSETTS 02125

Area(s) Form No.

G

CLM.139

Recommended for listing in the National Register of Historic Places.

If checked, you must attach a completed National Register Criteria Statement form.

Use as much space as necessary to complete the following entries, allowing text to flow onto additional continuation sheets.

ARCHITECTURAL DESCRIPTION:

Describe architectural features. Evaluate the characteristics of this building in terms of other buildings within the community.

This building is located on the northeast corner of Middlesex Road and Kennedy Drive. It is a two-story, wood frame, American Foursquare type house with Neoclassical detailing. Fenestration throughout the house consists largely of replacement six-over-one and four-over-one double-hung windows. The exterior walls are clad with wood clapboard with wood trim. The house rests atop a granite foundation. Internal brick chimneys are located on the rear and east slopes of the roof. The primary (south) façade features a large gabled dormer with a Palladian window and gable returns. Each of the other three sides of the house include a hipped dormer. The primary façade, which faces Middlesex Street, is divided into three symmetrical bays with the front entrance located directly in the center and a three-sided bay window located immediately east of the front door. A wrap-around porch with a flat roof extends across the two bays on the west side of the façade and one bay on the west side of the house. Like the primary façade on the south, the east and west walls of the house are divided into three symmetrical bays. The north side of the house includes a short wing that extends northward. The wing features a hipped roof, like the other three sides of the house. The apex of the roof is adorned with a widow's walk, complete with turned balusters and corner posts. The soffit is adorned with numerous modillions.

A two-story carriage house with a pyramidal roof is located just north of the house. The carriage house has been converted into a two-car garage. The pyramidal roof is topped with a square-shaped cupola. Fenestration around the carriage house consists of two-over-two double-hung windows. An enclosed breezeway addition connects the carriage house to the house. The exterior walls of the carriage house and breezeway are clad with clapboard.

The house is an altered example of an early twentieth century residence that retains historic integrity of location, setting, feeling, and association.

HISTORICAL NARRATIVE

Discuss the history of the building. Explain its associations with local (or state) history. Include uses of the building, and the role(s) the owners/occupants played within the community.

The original Inventory Form for this property that was completed by Jane Drury of the Chelmsford Historical Commission in September 2004 provides a thorough history of the property's owners, including original owner Dr. Fred E. Varney (1861-1944). Since this date the property was sold by the Chelmsford Housing Authority to current owner Leo R. Forcier in 2005, thus saving the building from an uncertain fate. The building continues to be a multiple-unit residence under the name of Prime Properties, Inc.

BIBLIOGRAPHY and/or REFERENCES

Geo. H. Walker & Co. *Atlas of Middlesex County, Massachusetts*. Geo. H. Walker & Co., Boston, MA. 1889.

Merriam, Fred. *Images of America: North and West Chelmsford*. Arcadia Publishing, Charleston, South Carolina. 2016.

Middlesex North Registry of Deeds. www.lowelldeeds.com.

INVENTORY FORM B CONTINUATION SHEET

CHELMSFORD

34 MIDDLESEX STREET

MASSACHUSETTS HISTORICAL COMMISSION

220 MORRISSEY BOULEVARD, BOSTON, MASSACHUSETTS 02125

Area(s) Form No.

G	CLM.139
---	---------

National Register of Historic Places Criteria Statement Form

Check all that apply:

- Individually eligible Eligible **only** in a historic district
- Contributing to a potential historic district Potential historic district

Criteria: **A** **B** **C** **D**

Criteria Considerations: **A** **B** **C** **D** **E** **F** **G**

Statement of Significance

The area of North Chelmsford was determined eligible for inclusion in the NRHP by MHC in 1987 for its local level of historical significance. The historic district boundary of Area G roughly includes resources along Middlesex and Princeton streets between Wright Street, Gay Street, and Edwards Avenue. The district is eligible for inclusion in the NRHP at the local level under Criterion A for its association with the industrialization of North Chelmsford in the mid- to late-nineteenth century and under Criterion C for its examples of workers' cottages, modest single-family houses, and elaborate residences owned by local industrialists. Resource CLM.139 retains sufficient historic integrity to contribute to this potential historic district.

INVENTORY FORM B CONTINUATION SHEET

CHELMSFORD

34 MIDDLESEX STREET

MASSACHUSETTS HISTORICAL COMMISSION
220 MORRISSEY BOULEVARD, BOSTON, MASSACHUSETTS 02125

Area(s) Form No.

G	CLM.139
---	---------



Converted carriage house, facing southeast. May 2016.



Undated photograph of 34 Middlesex Street. (Chelmsford Historical Society.)