

(Attach photo here)

83

FORM B - BUILDING SURVEY

MASSACHUSETTS HISTORICAL COMMISSION  
Office of the Secretary, State House, Boston

1. Is this building historically significant to:  
Town \_\_\_\_\_ Commonwealth \_\_\_\_\_ Nation \_\_\_\_\_

Building has historical connection with the following themes: (see also reverse side)

- Scholar \_\_\_\_\_
- Agriculture \_\_\_\_\_
- Art/Sculpture \_\_\_\_\_
- Education \_\_\_\_\_
- Government \_\_\_\_\_
- Literature \_\_\_\_\_
- Music \_\_\_\_\_
- Commerce/industry \_\_\_\_\_
- Science/invention \_\_\_\_\_
- Travel/communication \_\_\_\_\_
- Military Affairs \_\_\_\_\_
- Religion/philosophy \_\_\_\_\_
- Indians \_\_\_\_\_
- Other \_\_\_\_\_

Development of town/city \_\_\_\_\_

Architectural reason for inventorying: \_\_\_\_\_

2. Town North Chelmsford

Street address 35 Middlesex Street

Name Hall House

Use: original & present Residential

Present owner Charlotte Carnel

Open to public No

Date about 1840 Style \_\_\_\_\_

Source of date Deed Books

Architect \_\_\_\_\_

OR part of Area # \_\_\_\_\_

3. CONDITION Excellent Good Fair Deteriorated Moved Altered Added ell pre-1900; porch later  
dormers after 1900

4. DESCRIPTION

FOUNDATION/BASEMENT: High Regular Low \_\_\_\_\_ Material Granite, with brick in front

WALL COVER: Wood Clapboard Brick Stone Other \_\_\_\_\_

ROOF: Ridge Gambrel Flat Hip Mansard \_\_\_\_\_  
Tower Cupola Dormer windows Balustrade Grillwork added after 1900

CHIMNEYS: 1 2 3 4 \_\_\_\_\_ Center End Interior Irregular Cluster Elaborate

STORIES: 1 1/2 3 4 ATTACHMENTS: Wings Ell Shed pre-1900

PORCHES: 1 2 3 4 added after 1900 PORTICO \_\_\_\_\_ Balcony \_\_\_\_\_

FACADE: Gable end: Front/side Ornament \_\_\_\_\_

Entrance: Side Front: Center/Side Details: Small roof over panel door

Windows: Spacing: Regular/Irregular Identical/Varied \_\_\_\_\_  
5 Bay front, regular, Sides 3 bay irregular

Corners: Plain Pilasters Quoins Cornerboards

5. Indicate location of building in relation to nearest cross streets and other buildings

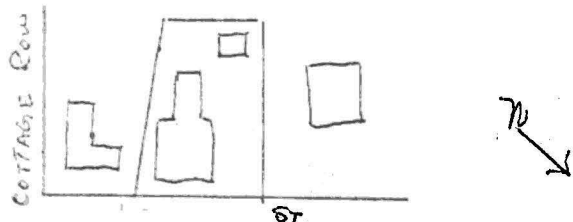

6. Footage of structure from street - 12 feet  
Property has 56 feet frontage on street  
sidewalk - 6 feet

Recorder Norma Faas Thompson

For Chelmsford Historical Comm.

Photo # \_\_\_\_\_ Date June 14, 1973

SEE REVERSE SIDE

# RELATION OF SURROUNDING TO STRUCTURE

1. Outbuildings Modern Garage
2. Landscape Features: Agriculture Open Wooded Garden: Formal/Informal  
Predominant features \_\_\_\_\_  
Landscape architect \_\_\_\_\_
3. Neighboring Structures  
Style: Colonial Federal Greek Revival Gothic Revival Italian Villa Lombard Rom.  
Venetian Gothic Mansard Richardsonian Modern and of the same (1840-50) era.  
Residential Commercial Religious Conditions: Excellent Good Fair Deteriorated

GIVE A BRIEF DESCRIPTION OF HISTORIC IMPORTANCE OF SITE (Refer and elaborate on theme circled on front of form)

Original small paned windows have been removed. House was altered to accommodate doctor's offices about 1918 for Dr. Fred E. Varney and later Dr. Frank E. Phillips, who were owners of this house. A door was added on one side and an entry created between two rooms. The dormers to add two upstairs bedrooms and bath were probably also added about this time.

## BIBLIOGRAPHY AND/OR REFERENCE

In Deed Book 13, page 298 - Nathaniel Blood granted this property with a new stable built by Benjamin to Benjamin Blood February 2, 1835,

In Deed Book 17, page 417 - Benjamin Blood granted to Caleb Blood his property... together with the buildings... May 3, 185

## RESTRICTIONS

Original Owner: Benjamin Blood

Deed Information: Book Number 13 Page 298, Northern Registry of Deeds  
Middlesex

George Eliott Carriel to Charlotte S. Carriel  
 Sept. 21, 1936 Book 887 page 570

Joseph and Stella Donavan to George E. Carriel  
 July 13, 1928 Book 765, page

Anna M. Phillips to Joseph F. and Stella A. Donavan  
 August 25, 1924 Book 710, page

Fred E. Varney to Anna M. Phillips  
 April 20, 1920 Book 624, page

Lizzie Patterson to Fred E. Varney  
 December 14, 1918 Book 595, page

Amos O. and Ethel M. Dickinson to Charles F. and Lizzie Patterson  
 January 30, 1913 Book 499, page 580

Charlotte Hall to Amos O. and Ethel M. Dickinson  
 September 26, 1910 Book 457, page 65

Herman W. Flint to John S. Hall  
 January 22, 1889 Book 203, page 46

Ann M. and Sylvanns Bartlett to Herman W. Flint  
 May 11, 1887 Book 188, page

Eliza H. Harlow to Ann Maria Bartlett  
 September 1, 1886 Book 183, page

Horace W. Woodward to Eliza H. Harlow  
 August 22, 1872 Book 88, page 338

James Redmond to Horace W. Woodward  
 August 9, 1872 Book 88, page 230

Henry F. Bickford and Mary J. Bickford to James Redmond  
 April 9, 1872 Book 85, page 208

Nathan B. Edwards to Henry F. Bickford  
 August 9, 1858 Book 16, page 44

Benjamin Blood to Caleb Blood  
 May 3, 1851 Book 17, page 417

Nathaniel Blood to Benjamin Blood  
 February 4, 1835 Book 13, page

Lincoln Drake to Nathaniel Blood  
 December 26, 1834 Book 13, page 270









HALL  
HOUSE  
C 1834

35