

# FORM B – BUILDING

MASSACHUSETTS HISTORICAL COMMISSION  
MASSACHUSETTS ARCHIVES BUILDING  
220 MORRISSEY BOULEVARD  
BOSTON, MASSACHUSETTS 02125

Assessor's Number USGS Quad Area(s) Form Number

13/19/18	Nashua South	G	CLM.387
----------	--------------	---	---------

**Town/City:** Chelmsford

**Place:** (*neighborhood or village*): North Chelmsford

## Photograph



**Address:** 42 Middlesex Street

**Historic Name:** Luther and H. Ellen Sargent House

**Uses:** Present: single-family dwelling

Original: single-family dwelling

**Date of Construction:** 1894

**Source:** Deed research

**Style/Form:** Queen Anne

**Architect/Builder:** unknown

**Exterior Material:**

Foundation: stone

Wall/Trim: wood clapboard and shingle/wood

Roof: slate

**Outbuildings/Secondary Structures:**  
none

**Major Alterations** (*with dates*):

Ca. 1990 replacement sash

Ca. 1960 rear addition

**Condition:** Good

**Moved:** no  yes  **Date:**

**Acreage:** .42 A

**Setting:** The house is located approximately 45' north of Middlesex St. across from Cottage Row. Asphalt drives are along the east and west sides of the house. A pool with deck is behind the house. The lot is flat and grassy with a few trees. The surrounding area includes 19<sup>th</sup> and 20<sup>th</sup> c. residential and industrial development.

## Locus Map

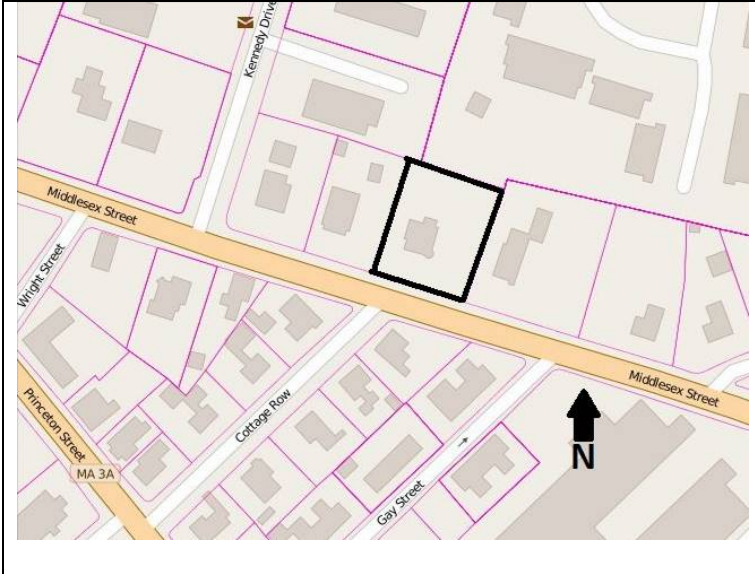

**Recorded by:** Jennifer Burden, Gray & Pape, Inc.

**Organization:** Chelmsford Historical Commission

**Date** (*month / year*): June 2016

# INVENTORY FORM B CONTINUATION SHEET

CHELMSFORD

42 MIDDLESEX STREET

MASSACHUSETTS HISTORICAL COMMISSION

220 MORRISSEY BOULEVARD, BOSTON, MASSACHUSETTS 02125

Area(s) Form No.

G

CLM.387

Recommended for listing in the National Register of Historic Places.

*If checked, you must attach a completed National Register Criteria Statement form.*

*Use as much space as necessary to complete the following entries, allowing text to flow onto additional continuation sheets.*

## ARCHITECTURAL DESCRIPTION:

*Describe architectural features. Evaluate the characteristics of this building in terms of other buildings within the community.*

This building is located on the northern side of Middlesex Street, across from Cottage Row. It is a two-story house with a hipped roof and a large cross gable on the west side of the house. Fenestration consists largely of pairs of replacement, one-over-one, double-hung windows. Fenestration in the hipped dormers consists of series of three, wood, six-over-one double-hung windows. The roof is covered with slate shingles. An internal brick chimney is along the rear slope of the roof. The exterior walls are clad with clapboard with wood trim. The house rests atop a stone foundation. The primary (south) façade, which faces Middlesex Street, is divided into four asymmetrical bays, with a large, hexagonal turret comprising the southeast corner of the façade. A hipped roof dormer is located above the center of the façade. The front entrance is located near the center of the façade. A one-story wrap-around porch with a hipped roof extends the width of the two bays on the west side of the façade, and two bays on the west side of the house. The porch roof rests atop a series of six, square, wooden columns. The porch is adorned with spindles and curved brackets on either side of each column. The east wall of the house features a three-sided, two-story bay that projects slightly from the side of the house. The bay is surmounted by a large, hipped wall dormer. A small, one-story addition is at the rear of the house, but is not visible from the street.

The house is a good example of the Queen Anne style that retains historic integrity of location, setting, design, feeling, and association.

## HISTORICAL NARRATIVE

*Discuss the history of the building. Explain its associations with local (or state) history. Include uses of the building, and the role(s) the owners/occupants played within the community.*

Deed research traced the ownership history to 1894 when Clara A.H. Adams sold the lot to H. Ellen Sargent. The 1889 map of North Chelmsford shows that no building was at this location then, but the 1907 Sanborn map shows a building matching this footprint and setback; therefore, the house was likely constructed shortly after the 1894 sale. The 1896 city directory lists Luther H. Sargent living on Main Street (the then name of Middlesex Street) and employed as the paymaster for the Silver & Gay Company. The 1900 US Population Census lists Luther (1842-1903) living with wife H. Ellen (born ca. 1844), servant Mary Brown (born ca. 1882), and boarder Ethel Stratton (born ca. 1873). By 1910 Luther passed away and Ellen continued to live on Middlesex Street with son-in-law Charles Butterfield, daughter Nellie Butterfield (both born ca. 1868), and their three children, Jesse (born ca. 1890), Nellie (born ca. 1892), and Hazel (born ca. 1894). At this date Charles was a bank teller and Jesse was a bookkeeper in an office. When H. Ellen died in 1924, the property passed to her daughter Nellie. When Nellie died in 1935, the property was granted to her three children. Immediately, Jesse and Nellie, granted the property to their sister Hazel, who was by this date married to George Swallow. The 1940 census lists the family living on Middlesex Street with George as the part-owner of an oil company. George died in 1975 and Hazel died in 1982, leaving the property to their children, George III, Sally, and Jeanne. Sally Delmore and Jeanne McAndrew assumed full ownership of the property in 1995. In 2006 they sold the property to current owners Stephen and Amy Hughes, marking the first time the property was not under Sargent/Butterfield/Swallow family ownership since the house was built in 1894.

# INVENTORY FORM B CONTINUATION SHEET

CHELMSFORD

42 MIDDLESEX STREET

MASSACHUSETTS HISTORICAL COMMISSION

220 MORRISSEY BOULEVARD, BOSTON, MASSACHUSETTS 02125

Area(s) Form No.

G

CLM.387

## BIBLIOGRAPHY and/or REFERENCES

Chelmsford Public Library. Royal Shawcross Photographs Collection. Available at <https://www.flickr.com/photos/chelmsfordpubliclibrary/sets/72157600000139715/>.

Genealogical research, including U.S. and Massachusetts census records; birth, marriage, and death records; and city directory records from ancestry.com.

Geo. H. Walker & Co. *Atlas of Middlesex County, Massachusetts*. Geo. H. Walker & Co., Boston, MA. 1889.

Merriam, Fred. *Images of America: North and West Chelmsford*. Arcadia Publishing, Charleston, South Carolina. 2016.

Middlesex North Registry of Deeds. [www.lowelldeeds.com](http://www.lowelldeeds.com).

Sanborn Fire Insurance Maps of Lowell, MA. 1907 and 1950.

Waters, Dr. Wilson. *The History of Chelmsford, Massachusetts*. Lowell, Mass., 1917.



Undated photograph of 42 Middlesex Street. (Chelmsford Public Library.)

# INVENTORY FORM B CONTINUATION SHEET

CHELMSFORD

42 MIDDLESEX STREET

MASSACHUSETTS HISTORICAL COMMISSION

Area(s) Form No.

220 MORRISSEY BOULEVARD, BOSTON, MASSACHUSETTS 02125

G	CLM.387
---	---------

---

## National Register of Historic Places Criteria Statement Form

Check all that apply:

- Individually eligible       Eligible **only** in a historic district
- Contributing to a potential historic district       Potential historic district

Criteria:     **A**     **B**     **C**     **D**

Criteria Considerations:     **A**     **B**     **C**     **D**     **E**     **F**     **G**

### Statement of Significance

The area of North Chelmsford was determined eligible for inclusion in the NRHP by MHC in 1987 for its local level of historical significance. The historic district boundary of Area G roughly includes resources along Middlesex and Princeton streets between Wright Street, Gay Street, and Edwards Avenue. The district is eligible for inclusion in the NRHP at the local level under Criterion A for its association with the industrialization of North Chelmsford in the mid- to late-nineteenth century and under Criterion C for its examples of workers' cottages, modest single-family houses, and elaborate residences owned by local industrialists. The building at 42 Middlesex Street retains sufficient historic integrity to contribute to this potential historic district.