

# FORM B – BUILDING

MASSACHUSETTS HISTORICAL COMMISSION  
MASSACHUSETTS ARCHIVES BUILDING  
220 MORRISSEY BOULEVARD  
BOSTON, MASSACHUSETTS 02125

Assessor's Number USGS Quad Area(s) Form Number

13/19/19	Nashua South	G	CLM.388
----------	--------------	---	---------

**Town/City:** Chelmsford

**Place:** (*neighborhood or village*): North Chelmsford

## Photograph



**Address:** 48 Middlesex Street

**Historic Name:** Oliver and Lydia Greene House

**Uses:** Present: multiple-family dwelling

Original: single-family dwelling

**Date of Construction:** ca. 1887

**Source:** Deed research and 1889 map of North Chelmsford

**Style/Form:** no style

**Architect/Builder:** unknown

**Exterior Material:**

Foundation: stone

Wall/Trim: wood siding/wood

Roof: slate

**Outbuildings/Secondary Structures:**

Carriage house

**Major Alterations** (*with dates*):

Ca. 2000 replacement windows

**Condition:** Good

**Moved:** no  yes  **Date:**

**Acreage:** .58 A

**Setting:** The house is located approximately 45' north of Middlesex St. across from Gay St. A paved drive along the east side of the house leads to the carriage house. The lot is flat and grassy with a few mature trees. The surrounding area includes 19<sup>th</sup> and 20<sup>th</sup> c. industrial and residential development.

## Locus Map

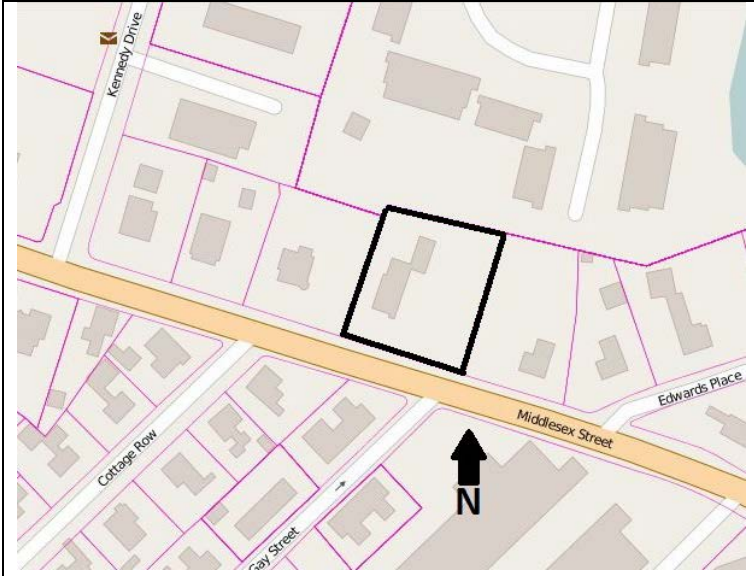

**Recorded by:** Jennifer Burden, Gray & Pape, Inc.

**Organization:** Chelmsford Historical Commission

**Date** (*month / year*): June 2016

# INVENTORY FORM B CONTINUATION SHEET

MASSACHUSETTS HISTORICAL COMMISSION

220 MORRISSEY BOULEVARD, BOSTON, MASSACHUSETTS 02125

CHELMSFORD

48 MIDDLESEX STREET

Area(s) Form No.

G

CLM.388

Recommended for listing in the National Register of Historic Places.

*If checked, you must attach a completed National Register Criteria Statement form.*

*Use as much space as necessary to complete the following entries, allowing text to flow onto additional continuation sheets.*

## ARCHITECTURAL DESCRIPTION:

*Describe architectural features. Evaluate the characteristics of this building in terms of other buildings within the community.*

This building is located on the north side of Middlesex Street, between Cottage Row and Gay streets. Built ca. 1887, the house is a two and-a-half story, wood frame, front-gabled house. The roof is covered with slate shingles. The exterior walls are covered with wood shingles. The house rests atop a stone foundation. The primary (south) façade, which faces Middlesex Street, is divided into two bays, with a three-sided, two-story bay comprising the bay to the west of the facade. The front entrance is located in the bay on the east side of the façade. The front entrance includes a small porch with a hipped canopy set atop narrow, wood columns. The front door includes sidelights and a transom. The east and west side of the roof each include a single, gabled dormer. A three-sided, two-story bay is located near the center of the east side of the house. Fenestration consists of one-over-one and two-over-two double-hung windows. A one and-a-half story carriage house is located to the rear of the house. The carriage house has been converted into a one-car garage. The carriage house is connected to the main house by a rear extension of the house.

The building is a slightly altered example of a late nineteenth century residence that retains historic integrity of location, setting, design, feeling, and association.

## HISTORICAL NARRATIVE

*Discuss the history of the building. Explain its associations with local (or state) history. Include uses of the building, and the role(s) the owners/occupants played within the community.*

Deed research traced the ownership history of the property to 1887 when Lucy Woodward, widow of Horace Woodward, subdivided her parcel and sold the new parcel to Oliver Greene. The building is not shown on the 1875 map of North Chelmsford, but is present on the 1889 map of the area; therefore, the house was likely constructed soon after Greene's purchase of the lot. The 1910 US Population Census lists Oliver (ca. 1827-1915) living on Middlesex Street with wife Lydia (ca. 1835-1918), daughter Viola Mitchell (ca. 1878-1910), her son George (born ca. 1901), and servant Abbie Downs (born ca. 1872). The 1912 city directory lists Oliver as a pattern maker. Lydia remained in the house until her death in 1918. A search for George Mitchell in city directories yielded no results. The property was granted to Wilfred Greene (ca. 1858-1936), who was a son of Oliver and Lydia. In 1910 Wilfred and Harriet Greene were living in Waltham and Wilfred was working in a watch factory. The 1942 Chelmsford city directory shows that Harriet remained at this address and living with her was Augusta Fiske. In 1944 Harriet Greene sold the property to Vernon Morris, marking the end of the 57-year ownership of the Greene family. Morris (1903-1975) is listed in the 1949 city directory as living at 29 Middlesex St. and the president of the Morris Bros Granite Co. The 1949 directory lists Thomas and Hanora Quinlan, and their children Garrett and Ann at 48 Middlesex with Thomas and Garrett working as coopers and Ann as a secretary. The property eventually passed to Morris's daughter Louise, who retained it until 1995. The property was sold two additional times after this date.

## BIBLIOGRAPHY and/or REFERENCES

- Beers, F.W. *County Atlas of Middlesex, Massachusetts*. J.B. Beers & Co., New York. 1875.
- Genealogical research, including U.S. and Massachusetts census records; birth, marriage, and death records; and city directory records from ancestry.com.
- Geo. H. Walker & Co. *Atlas of Middlesex County, Massachusetts*. Geo. H. Walker & Co., Boston, MA. 1889.
- Merriam, Fred. *Images of America: North and West Chelmsford*. Arcadia Publishing, Charleston, South Carolina. 2016.
- Middlesex North Registry of Deeds. [www.lowelldeeds.com](http://www.lowelldeeds.com).
- Sanborn Fire Insurance Maps of Lowell, MA. 1907 and 1950.
- Waters, Dr. Wilson. *The History of Chelmsford, Massachusetts*. Lowell, Mass., 1917.

# INVENTORY FORM B CONTINUATION SHEET

MASSACHUSETTS HISTORICAL COMMISSION  
220 MORRISSEY BOULEVARD, BOSTON, MASSACHUSETTS 02125

CHELMSFORD

48 MIDDLESEX STREET

Area(s) Form No.

G	CLM.388
---	---------

---

## National Register of Historic Places Criteria Statement Form

Check all that apply:

- Individually eligible       Eligible **only** in a historic district  
 Contributing to a potential historic district       Potential historic district

Criteria:     **A**     **B**     **C**     **D**

Criteria Considerations:     **A**     **B**     **C**     **D**     **E**     **F**     **G**

### Statement of Significance

The area of North Chelmsford was determined eligible for inclusion in the NRHP by MHC in 1987 for its local level of historical significance. The historic district boundary of Area G roughly includes resources along Middlesex and Princeton streets between Wright Street, Gay Street, and Edwards Avenue. The district is eligible for inclusion in the NRHP at the local level under Criterion A for its association with the industrialization of North Chelmsford in the mid- to late-nineteenth century and under Criterion C for its examples of workers' cottages, modest single-family houses, and elaborate residences owned by local industrialists. The building at 48 Middlesex Street retains sufficient historic integrity to contribute to this potential historic district.