

FORM B – BUILDING

MASSACHUSETTS HISTORICAL COMMISSION
MASSACHUSETTS ARCHIVES BUILDING
220 MORRISSEY BOULEVARD
BOSTON, MASSACHUSETTS 02125

Assessor's Number USGS Quad Area(s) Form Number

14/46/4	Nashua South		CLM.391
---------	--------------	--	---------

Town/City: Chelmsford

Place: (*neighborhood or village*): North Chelmsford

Photograph



Address: 79 Middlesex Street

Historic Name: Patrick Ward, Jr. House

Uses: Present: single-family dwelling

Original: single-family dwelling

Date of Construction: between 1831 and 1856

Source: 1831 and 1856 maps of Chelmsford

Style/Form: Gothic Revival

Architect/Builder: unknown

Exterior Material:

Foundation: stone

Wall/Trim: wood siding/wood

Roof: asphalt shingle

Outbuildings/Secondary Structures: none

Major Alterations (*with dates*):

Ca. 2000 replacement windows

Condition: Good

Moved: no yes **Date:**

Acreage: .17 A

Setting: The house is located approximately 40' south of Middlesex Street, west of Church Street. A paved drive is along the east side of the house. Shrubs are along the north and east sides of the lot and mature trees are along the west and rear sides. The surrounding area includes 19th c. industrial and residential developments.

Locus Map

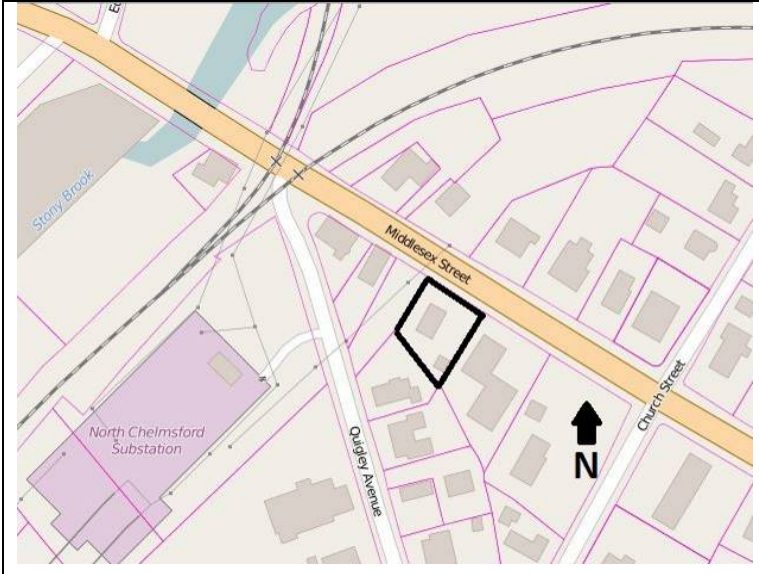

Recorded by: Jennifer Burden, Gray & Pape, Inc.

Organization: Chelmsford Historical Commission

Date (*month / year*): June 2016

INVENTORY FORM B CONTINUATION SHEET

CHELMSFORD

79 MIDDLESEX STREET

MASSACHUSETTS HISTORICAL COMMISSION

220 MORRISSEY BOULEVARD, BOSTON, MASSACHUSETTS 02125

Area(s) Form No.

CLM.391

Recommended for listing in the National Register of Historic Places.

If checked, you must attach a completed National Register Criteria Statement form.

Use as much space as necessary to complete the following entries, allowing text to flow onto additional continuation sheets.

ARCHITECTURAL DESCRIPTION:

Describe architectural features. Evaluate the characteristics of this building in terms of other buildings within the community.

This building is located on the south side of Middlesex Street between Quigley Avenue and Church Street. Built ca. 1840, it is a one-and-a-half story front-gable house built of wood frame construction. The roof of the house is covered with asphalt shingles and the exterior walls are clad with clapboard. The house rests atop a stone foundation. The primary (north) façade, which faces Middlesex Street, is divided into three bays on the first story. The front entrance is located in the first bay on the west side of the façade. There is a pair of one-over-one double-hung windows to the east of the front entrance. A pair of one-over-one double-hung windows are located in the gable of the upper half story. A small section of scrollwork adorns the peak of the gable. A hipped porch roof extends the full width of the façade. The roof rests atop a series of four, turned columns. The porch roof frieze board is adorned with small brackets. There is a small, one story, side-gabled addition at the rear end of the east side of the house. The addition includes a single pedestrian door and a modern bay window.

The building is a good example of a mid-nineteenth residence that retains all aspects of historic integrity.

HISTORICAL NARRATIVE

Discuss the history of the building. Explain its associations with local (or state) history. Include uses of the building, and the role(s) the owners/occupants played within the community.

The house is not present on the 1831 map of Chelmsford, but is shown on the 1856 map of the area; therefore, it was constructed between these dates. The 1856 map lists P. Ward the 2nd as the owner of the property; other members of the Ward family also owned the two properties to the west. P. Ward appears to be Patrick Ward, Jr. Patrick Ward, Sr. owned the property at 71 Middlesex St (CLM.390). Patrick, Jr. (born ca. 1820 in Ireland) is listed in the 1860 US Population Census as living in Chelmsford with wife Ellen (born ca. 1820 in Ireland), and six children born between 1843 and 1857 in Massachusetts. At this date Patrick was a moulder. Deed research did not discover when Patrick sold the property, but by 1875 William Hackett was listed as the property's owner. A search of Chelmsford census records did not yield information on Hackett. By 1889 S. Leavitt owned the property. The 1880 census lists Stephen B. Leavitt (born ca. 1824) living in Chelmsford and working a machinist. His sister Abby Young (born ca. 1843) and young niece Maude Young were living with him at this date. In the early 1890s Leavitt granted the property to Thomas Plunkett, who sold it in 1893 to Edward and Samuel Seymour. After another transaction in 1895, the property was deeded to Edward (born ca. 1845 in New York) and Julia (born ca. 1850 in Canada) Seymour. The 1900 census lists the Seymours in Chelmsford with their five children born between 1872 and 1889 in Massachusetts. At this date Edward and eldest son Samuel were carpenters, middle son George was a cigar maker, elder daughter Lavina was a wool twister, and younger daughter Lilla was employed in a dry goods store. Edward died in 1918 and Julia and the children retained the property until 1925. That year they sold the property to Jason Delponte. The 1931 city directory lists Loretta (born ca. 1865), daughter Louise (born ca. 1901 in England), and son Joseph (born ca. 1904 in England) living on Middlesex Street; therefore, it appears Jason had passed away by this date. The 1940 census lists only Louise, working as a drawer in the worsted mill, and Joseph, employed as a tractor operator in a stone quarry, living on Middlesex Street. The property remained in the Delponte family until 1988, making them the owners of the property for the longest period (1925-1988).

INVENTORY FORM B CONTINUATION SHEET

CHELMSFORD

79 MIDDLESEX STREET

MASSACHUSETTS HISTORICAL COMMISSION

220 MORRISSEY BOULEVARD, BOSTON, MASSACHUSETTS 02125

Area(s) Form No.

	CLM.391
--	---------

BIBLIOGRAPHY and/or REFERENCES

Beers, F.W. *County Atlas of Middlesex, Massachusetts*. J.B. Beers & Co., New York. 1875.

Genealogical research, including U.S. and Massachusetts census records; birth, marriage, and death records; and city directory records from ancestry.com.

Geo. H. Walker & Co. *Atlas of Middlesex County, Massachusetts*. Geo. H. Walker & Co., Boston, MA. 1889.

Hales, John G. *Plan of the Town of Chelmsford in the County of Middlesex*. Surveyed in 1831 by John G. Hales.

Middlesex North Registry of Deeds. www.lowelldeeds.com.

Perham, Henry S. *A Sketch of the History of Chelmsford, Massachusetts*. Philadelphia, PA, J.W. Lewis. 1890.

Sanborn Fire Insurance Maps of Lowell, MA. 1907 and 1950.

Walling, Henry F. *Map of Middlesex County, Massachusetts*. Smith & Bumstead, Boston, MA. 1856.

Waters, Dr. Wilson. *The History of Chelmsford, Massachusetts*. Lowell, Mass., 1917.