

# FORM B – BUILDING

MASSACHUSETTS HISTORICAL COMMISSION  
MASSACHUSETTS ARCHIVES BUILDING  
220 MORRISSEY BOULEVARD  
BOSTON, MASSACHUSETTS 02125

Assessor's Number USGS Quad Area(s) Form Number

97/328/8

Billerica

Town Chelmsford

Place (neighborhood or village)

Address 278 Mill Road

Historic Name Sweetser/Loucraft House

Uses: Present Residence- 1 family

Original Resedence- one family

Date of Construction 1909

Source taxes

Style/Form conventional

Architect/Builder Herbert C. Sweetser/ builder

Exterior Material: Wooden clapboards

Foundation stone

Wall/Trim Wood

Roof Asphalt

Outbuildings/Secondary Structures

Major Alterations (with dates)

Condition poor

Moved  no  yes Date

Acreage 21278 sq. ft.

Setting at the edge of an industrial park set back from a county road



Sketch Map



Recorded by Linda V. Prescott, Chmn.

Organization Chelmsford Historical commission

Date June 2006

## BUILDING FORM

### ARCHITECTURAL DESCRIPTION *see continuation sheet*

*Describe architectural features. Evaluate the characteristics of this building in terms of other buildings within the community.*

The house on 278 Mill Road is a very typical home of the early 20<sup>th</sup> century. It is a 1 ½ story house with side gables. The roof has asphalt shingles. The exterior is covered with clapboard and the windows are 2 over 2's. Attached on the back of the house is a shed. The foundation is of field stone. The last home owner built a deck on the right side with a sliding glass door. The eaves are wide and have brackets and moldings boards.

### HISTORICAL NARRATIVE *see continuation sheet*

*Discuss the history of the building. Explain its associations with local (or state) history. Include uses of the building, and the role(s) the owners/occupants played within the community.*

According to deeds, Herbert C. Sweetser, partner in the Sweetser and Day Mill, in Chelmsford Centre, purchased 24 acres of wood land called Rocky Hill Sprout on the Road to Russell's Mill, for one dollar and other considerations, from his family in 1909. The sale was part of an inheritance settlement from the estate of Charles Sweetser. By 1908 Herbert Sweetser had sold 2 acres of that land to John O'Hara and in July of 1908, Herbert Sweetser filed with the town a plan to develop five lots along Road to Russell's Mill (Mill Road) and the Road from Billerica (Rte. 129), the land in Elizabeth Drive on Mill Road to Lothar Fuch's property on Mill Road. In 1909, on lot #2, Herbert Sweetser built a farmhouse with an attached shed and a hen house to be occupied by Charles Loucraft. In 1910 Charles Loucraft, a local carpenter, bought the house with 2 acres of land. The 1910 census lists Charles Loucraft as a carpenter who builds houses living in the house with his wife Sarah and 2 children and a brother Frank. Sometime between 1912 and 1920, Charles Loucraft died, Sarah and family moved to Lowell and the house was purchased by his brother Frank Loucraft. Frank Loucraft sold the house in May 1915 to Guiseppi Pierro. Guiseppi Pierro lived in the house until his death, in July of 1950, the house was sold to Albert Pierro from Henderson, Nevada. The house was sold in 1954 to James McCusker and Donald McInnis and was surveyed for a subdivision. The house changed hands several more times before finally passing to the hands of M.T.C Construction of Woburn, MA. On June 13, 2006, the Historical commission granted permission to demolish the house for an office building.

### BIBLIOGRAPHY and/or REFERENCES *see continuation sheet*

North Middlesex Registry of Deeds  
Town of Chelmsford Tax Records  
Ancestry- census  
Waters "History of Chelmsford"  
Town of Chelmsford Cemetery Archives  
Photographics by Fred Merriam

Recommended for listing in the National Register of Historic Places. *If checked, you must attach a completed National Register Criteria Statement form.*

# 1908 Plan

PLAN OF LAND  
IN CHELMSFORD, MASS.  
BELONGING TO  
**H. C. SWEETSER,**  
JULY 1908.

August 25 09  
27  
*Horace S. Sweetser*

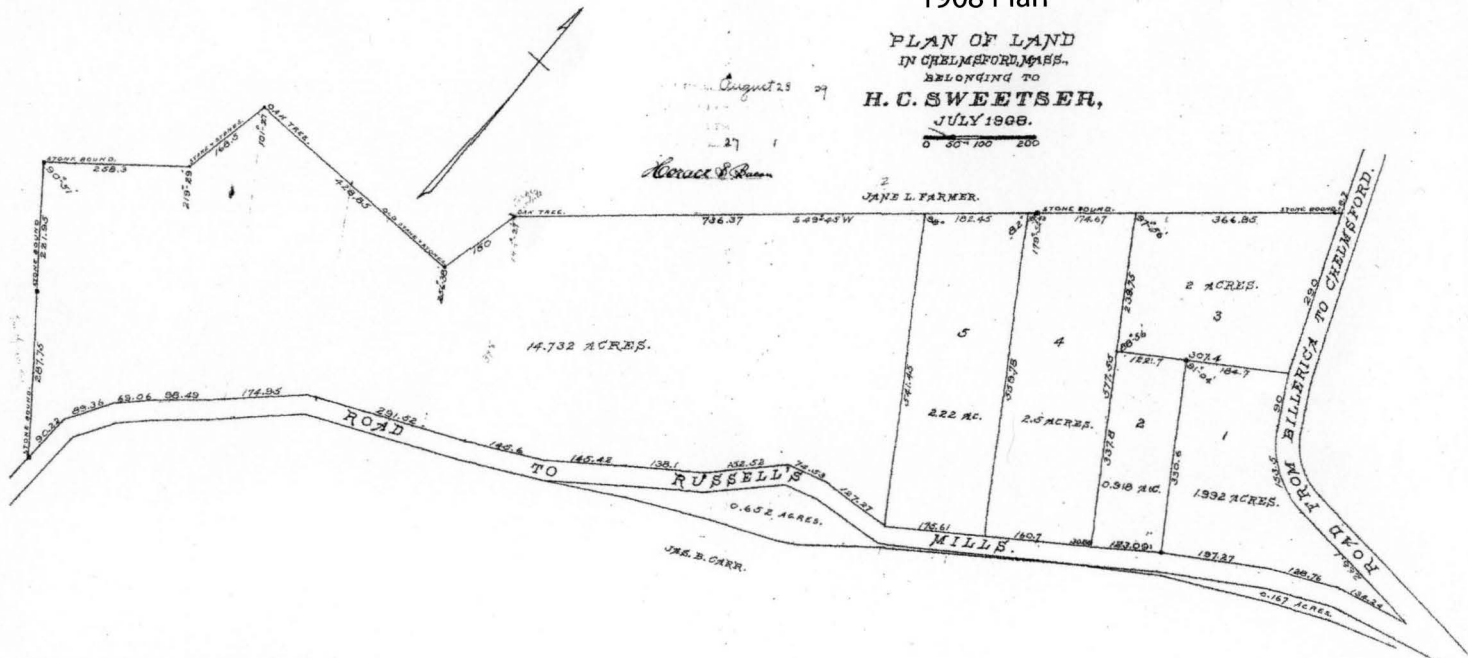
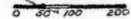

# INVENTORY FORM CONTINUATION SHEET

CHELMSFORD 278 MILL ROAD

MASSACHUSETTS HISTORICAL COMMISSION  
MASSACHUSETTS ARCHIVES BUILDING  
220 MORRISSEY BOULEVARD  
BOSTON, MASSACHUSETTS 02125

Area(s) Form No.

--	--

## Locational Information



278 Mill road from [www.local.live.com](http://www.local.live.com)

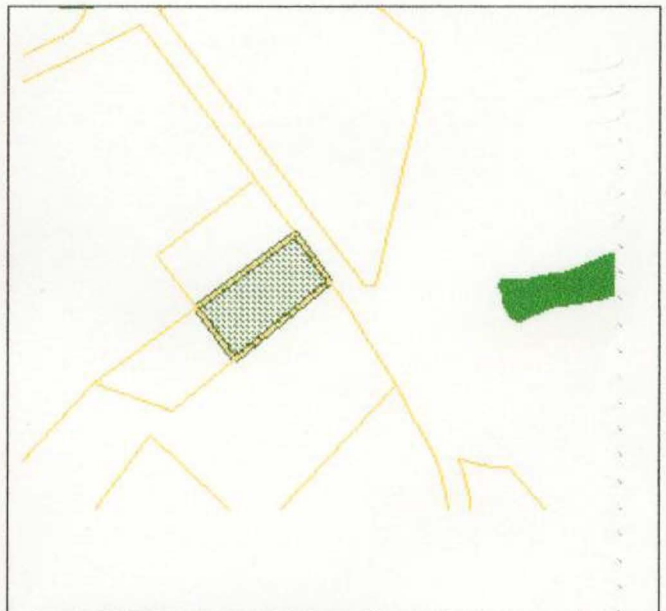

278 Mill Road from Assessor's Maps

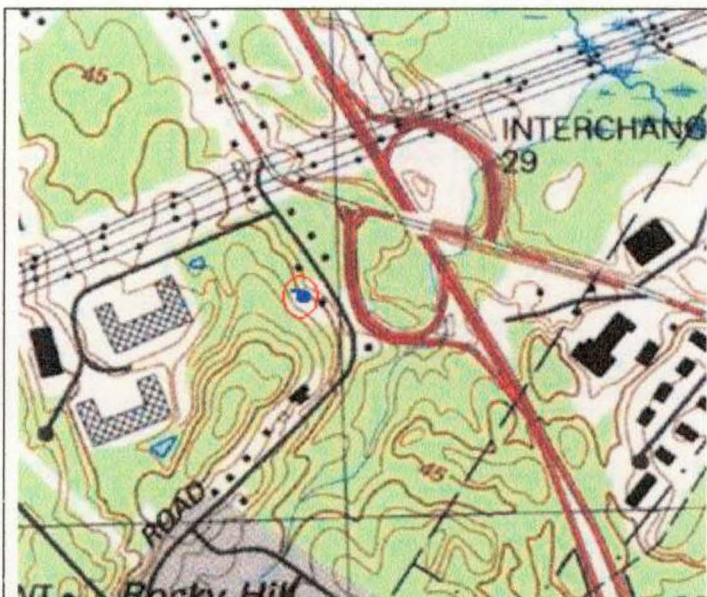

Topozone excerpt from Billerica USGS quadrangle.

Decimal coordinates as provided by Topozone: 42°35'16" W 71°18'58" N

Town Of Chelmsford  
50 Billerica Road  
Chelmsford, MA 01824



Chelmsford Historical Commission  
Delay of Demolition  
**Determination of Applicability**

The Chelmsford Historical Commission finds the application for demolition of:

Property: 278 Mill Rd.  
*Address of property - description, i.e., type of structure*

as presented by: MTC Construction II, LLC  
*Owner or contractor*

7 Cedar St., Woburn, MA 01801  
*Address of owner/contractor*

on: 6.13.06  
*date*

to be within the guideline of the Demolition Delay bylaw, Ch. 16, Town of Chelmsford, and has notified the Town of Chelmsford Inspector of Buildings of said determination. The Inspector of Buildings may issue a permit for demolition.

Linda V. Prescott  
*Signature of Historical Commission Representative*

6.13.06  
*date*

Linda V. Prescott  
*Print name of Historical Commission Representative*

cc: Inspector of Buildings  
Town Manager