

FORM B – BUILDING

Assessor's Number USGS Quad Area(s) Form Number

26/ 90/ 2/ 1

Billerica

CLM.433

MASSACHUSETTS HISTORICAL COMMISSION
MASSACHUSETTS ARCHIVES BUILDING
220 MORRISSEY BOULEVARD
BOSTON, MASSACHUSETTS 02125

Town/City: Chelmsford

Place: (*neighborhood or village*): North Chelmsford

Photograph



View looking north from North Road.

Address: 357 North Rd

Historic Name: Owen and Mary McEnany House

Uses: Present: Multiple-family dwelling

Original: Single-family dwelling

Date of Construction: circa 1848

Source: Deed

Style/Form: No style

Architect/Builder: Not known

Exterior Material:

Foundation: Stone, uncut; Concrete cinderblock

Wall/Trim: Vinyl siding/ Vinyl trim

Roof: Asphalt shingles

Outbuildings/Secondary Structures: None

Major Alterations (*with dates*): Large addition to south in mid-20th century; vinyl siding; replacement windows (20th C).

Condition: Fair

Moved: no yes **Date:**

Acreage: 0.27

Setting: The house is located on a major north-south state route in a mixed commercial and residential setting. Nearby houses range in date from the 18th through the 20th centuries.

Locus Map

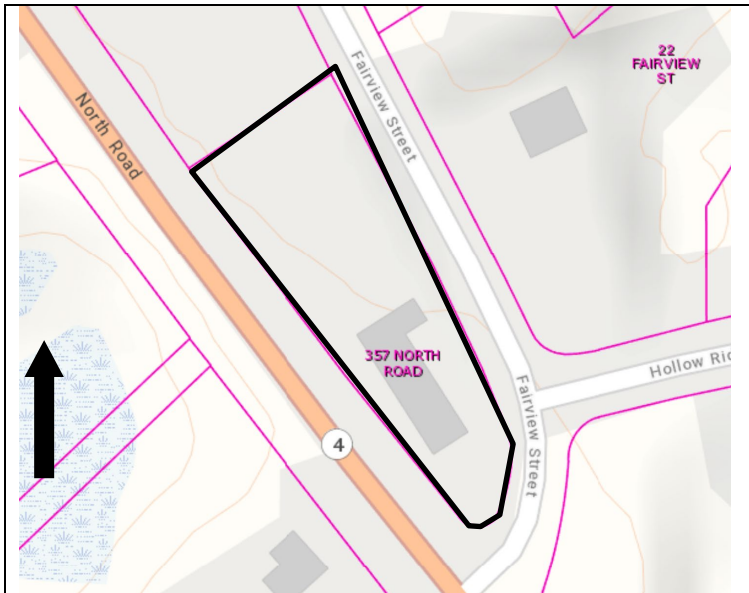

Recorded by: Stacy Spies, Historic Preservation Cons.

Organization: for Chelmsford Historical Commission

Date: March 2022

INVENTORY FORM B CONTINUATION SHEET

CHELMSFORD

357 NORTH RD

MASSACHUSETTS HISTORICAL COMMISSION

Area(s) Form No.

220 MORRISSEY BOULEVARD, BOSTON, MASSACHUSETTS 02125

CLM.433

 Recommended for listing in the National Register of Historic Places.*If checked, you must attach a completed National Register Criteria Statement form.*

Use as much space as necessary to complete the following entries, allowing text to flow onto additional continuation sheets.

ARCHITECTURAL DESCRIPTION:

Describe architectural features. Evaluate the characteristics of this building in terms of other buildings within the community.

The house is located on a triangular lot bounded by North Road (Route 4) and Fairview Street. The house is located close to the street and historically was oriented toward North Road. At present, the driveway and entrances to the house are located on the less-traveled Fairview Street. A grassy yard surrounds the house.

The house was constructed in several phases. The 2-story frame building rests on a fieldstone foundation at the north end and a concrete block foundation at the south end. The second story overhangs the first floor. The side-gabled roof has overhanging eaves. A slender brick interior chimney rises from the east slope of the north section of the house. A one-story garage is attached to the south end of the house. A one-story ell wraps around the north elevation of the main block. The building is covered with vinyl siding and contains replacement windows.

The oldest section of the house appears to be the north section that has a slightly lower roof height than the south section. This original block has a fieldstone foundation. The second sections to be constructed appear to be the northwest corner of the house – perhaps an enclosed former porch – and the center section immediately south of the door on the west elevation. These sections also rest on fieldstone foundations that differ slightly in configuration to that of the original block. The one- and two-story sections at the south end of the house are mid-20th-century additions and rests on a concrete block foundation.

Extensive renovations to the house have resulted in the loss of identifying exterior details that could aid discernment of an original construction date. Interior inspections were beyond the scope of this survey, but a closer examination of surviving framing, floorplans, and interior features and finishes by an architectural historian could provide additional insights into a likely original construction date and on the physical evolution of the building over time.

HISTORICAL NARRATIVE

Discuss the history of the building. Explain its associations with local (or state) history. Include uses of the building, and the role(s) the owners/occupants played within the community.

The house at 357 North Road is located at what was once the intersection of a town road and the Middlesex Turnpike. The building's form has evolved over time, obscuring physical exterior details that might aid in pinpointing a construction date. Primary-source research points to a construction date possibly as early as 1848.

The Middlesex Turnpike was chartered in 1805 but construction was slow to start and didn't reach this part of Chelmsford until 1823.¹ In this part of Chelmsford, the turnpike became North Road / Route 4. The turnpike investors believed that the turnpike's straight alignment would allow faster travel time, thereby justifying the toll charged. The public did not agree. The route fell into disuse and was abandoned by 1840. Some sections, like those in North Chelmsford, became local roads. An 1831 map (See below) indicates a crossroads at this location, as shown by the widened roadway. No house is shown at 357 North Road in 1831.

A house owned by "O. McEnna" appears in this location on the 1855 map. In 1848, Irish immigrant Owen McEnany purchased this ¼-acre lot at the intersection of North Road and Fairview Street for \$12.50.² At the time of the 1850 census, Owen McEnany (1807-1883) worked as a foundry watchman. He lived in Chelmsford with his wife, Mary (ca. 1810-before 1880), their

¹ Waters: 843.

² Middlesex South Registry of Deeds Book 545, p. 192.

INVENTORY FORM B CONTINUATION SHEET

CHELMSFORD

357 NORTH RD

MASSACHUSETTS HISTORICAL COMMISSION

220 MORRISSEY BOULEVARD, BOSTON, MASSACHUSETTS 02125

Area(s) Form No.

CLM.433

eight children, and two members of the Deary family, who appear to be family members. By 1870, Owen McEnany was working as a farm laborer, while his son, John, worked in the iron foundry, and his daughter, Mary Jane, worked at a woolen mill. The property passed on to daughter Mary Jane McEnany (1847-) after her parents' deaths and remained in the McEnany family until 1924.³

Joseph T. Fallon purchased the property in 1924. Joseph T. Fallon (ca. 1887-) lived here with his wife, Gertrude (ca. 1899-) and their five children. In 1940, Joseph Fallon worked as a "stationary fire man" at a quarry while Gertrude worked as a social worker. Robert worked as an apprentice wool sorter, Edward worked as a carder at a rayon mill, and Bertha worked as a packer in a cracker factory. Daughters Pauline and Patricia were still in school at the time. The property was passed on Bertha Fallon Sadowski (1924-2006) in 1961.⁴ The Sadowski family are the current owners of the property.

BIBLIOGRAPHY and/or REFERENCES

Beers, F.W. *County Atlas of Middlesex County*. New York: J.B. Beers & Co. 1875.

Chelmsford Tax Assessor records. 2021.

City Directories. Ancestry.com.

Findagrave.com.

Hales, John G. *Plan of Chelmsford*. 1831.

Middlesex North Registry of Deeds.

Middlesex South Registry of Deeds.

Massachusetts Census. Ancestry.com.

Massachusetts Vital Records. Ancestry.com.

Massachusetts Marriage records. Ancestry.com.

United States Census. Ancestry.com.

Walker, George H. & Co., *Atlas of Middlesex County*. Boston: George H. Walker & Co., 1889.

Walling, Henry Francis. *Map of Middlesex County*. Boston: Smith & Bumstead, 1856.

Waters, Rev. Wilson. *History of Chelmsford, Massachusetts*. Lowell: Courier-Citizen Company. 1917.

Wood, Frederic James. *The Turnpikes of New England and Evolution of the Same Through England, Virginia, and Maryland*. Boston: Marshall Jones Company. 1919.

SUPPLEMENTARY INFORMATION



View looking northwest from Fairview Street.



View looking south from Fairview Street.

³ Middlesex North Registry of Deeds Book 711, p. 167

⁴ <https://www.findagrave.com/memorial/18165386/bertha-sadowski>. Accessed Jan. 12, 2022 AND Middlesex North Registry of Deeds Book 1506, p. 152.

INVENTORY FORM B CONTINUATION SHEET

CHELMSFORD

357 NORTH RD

MASSACHUSETTS HISTORICAL COMMISSION
220 MORRISSEY BOULEVARD, BOSTON, MASSACHUSETTS 02125

Area(s) Form No.

CLM.433

Annotated assessor's sketch. 2022.

Late 20th C

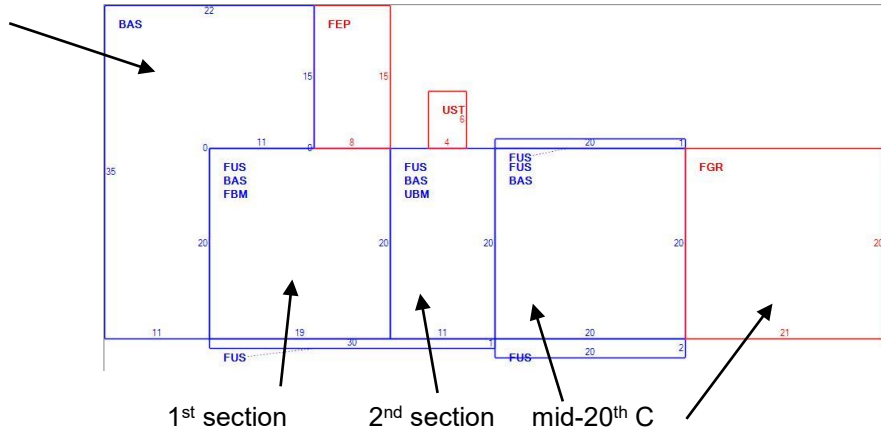

House location on 1831 Map.

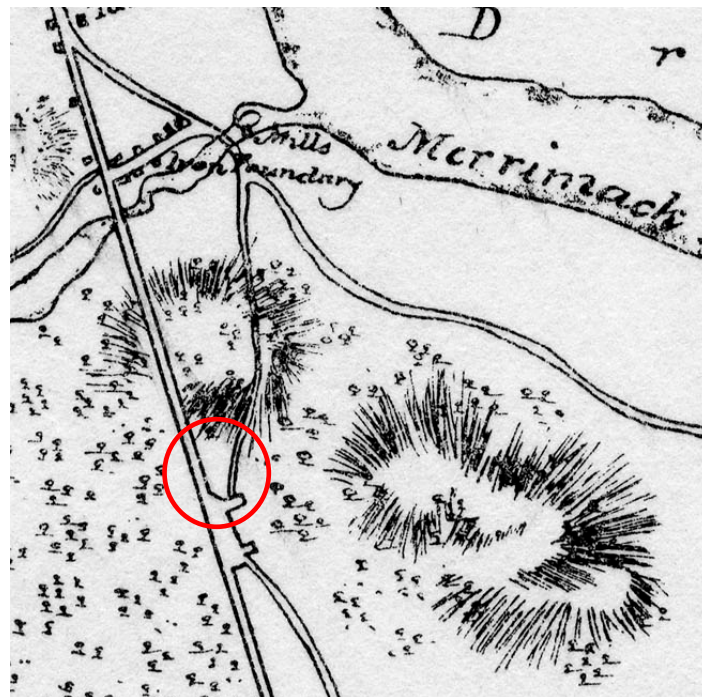

Middlesex Turnpike