

FORM B – BUILDING

Assessor's Number USGS Quad Area(s) Form Number

MASSACHUSETTS HISTORICAL COMMISSION
MASSACHUSETTS ARCHIVES BUILDING
220 MORRISSEY BOULEVARD
BOSTON, MASSACHUSETTS 02125

126/ 449/ 1/ /	Billerica, MA		CLM.440
----------------	------------------	--	---------

Town/City: Chelmsford

Place: (*neighborhood or village*): South Chelmsford

Photograph



Address: 126 Proctor Road

Historic Name: Rufus and Sarah Harwood House

Uses: Present: Single-family dwelling

Original: Single-family dwelling

Date of Construction: ca. 1851

Source: Deed

Style/Form: Greek Revival

Architect/Builder: Not known

Exterior Material:

Foundation: Stone, cut

Wall/Trim: Wood clapboard / Wood trim

Roof: Asphalt shingles

Outbuildings/Secondary Structures: Attached shed/garage and barn

Major Alterations (*with dates*): Concrete porch added.
Replacement windows (Late 20th or early 21st C)

Condition: Good

Moved: no yes **Date:**

Acreage: 0.92

Setting: The house is located on a narrow, winding road in a wooded area. Nearby houses date from the 18th-20th centuries and are located on wooded lots.

Locus Map

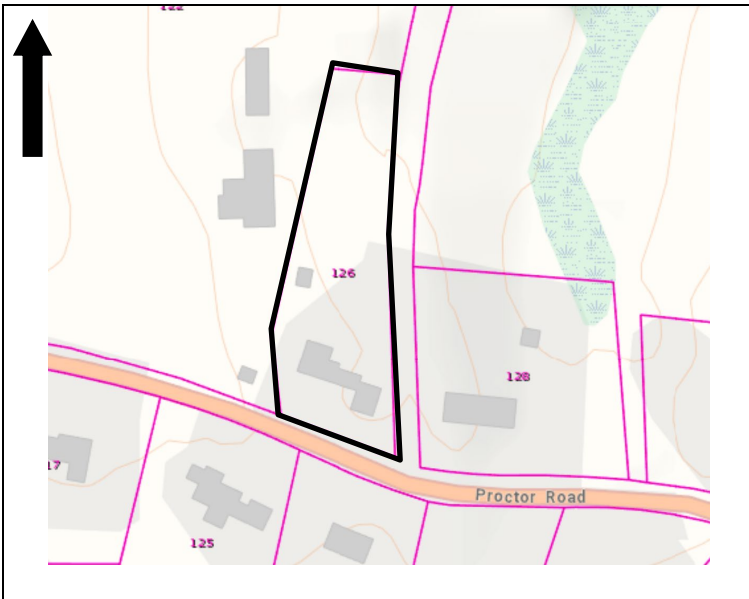

Recorded by: Stacy Spies, Historic Preservation Cons.

For: Chelmsford Historical Commission

Date: March 2022

INVENTORY FORM B CONTINUATION SHEET

CHELMSFORD

126 PROCTOR RD

MASSACHUSETTS HISTORICAL COMMISSION

220 MORRISSEY BOULEVARD, BOSTON, MASSACHUSETTS 02125

Area(s) Form No.

CLM.440

 Recommended for listing in the National Register of Historic Places.*If checked, you must attach a completed National Register Criteria Statement form.*

Use as much space as necessary to complete the following entries, allowing text to flow onto additional continuation sheets.

ARCHITECTURAL DESCRIPTION:

Describe architectural features. Evaluate the characteristics of this building in terms of other buildings within the community.

The house is oriented to the south and parallel to Proctor Road. The house is separated from Proctor Road by a shallow yard. The level lot is planted in grass; mature trees line the east lot line. A wide, shallow asphalt-paved driveway fills the area between the road and the shed/garage and barn.

The 1 ½-story frame house is two-over-three bays wide with a side hall plan and three bays deep. The building rests on a cut stone slab foundation. The front-gabled roof has overhanging eaves. A slender brick interior chimney rises from the east roof slope; a similar chimney rises from the northwest corner of the house. The building is clad with wood clapboards and trimmed with a wide frieze and skirtboard. Corner pilasters rise to meet the gable-end cornice returns. A shed-roof porch with Eastlake-style turned wood brackets shelters the entrance. The Colonial-Revival-style front door is a late 20th-century replacement. The concrete front steps feature a wrought-iron railing. Windows throughout the house are 1/1 vinyl replacements. The operable, louvered wood shutters are restrained by metal shutter dogs.

The shed/garage ell is attached to the northwest corner of the house. The one-story, side-gabled structure rests on a stone foundation and is covered with wood shingles. The east end of the ell contains a late 20th-century bay window and a wood deck that leads to a full-light door. In the center bay is located a double-leaf, side-hung, vertical board door. The west end of the ell contains a vehicle pass-through that provides access to the back yard.

The barn is attached to the west elevation of the ell. The front-gabled roof has overhanging eaves. The building rests on a concrete block foundation. The barn is covered with vertical boards and batten. The large center door is constructed of miter-cut boards inset with six-light fixed windows. A sash window is located in the gable peak. A frame cupola rests atop the roof ridge.

HISTORICAL NARRATIVE

Discuss the history of the building. Explain its associations with local (or state) history. Include uses of the building, and the role(s) the owners/occupants played within the community.

The house at 126 Proctor Road was likely constructed circa 1851 for Rufus Harwood. Milkman and farmer Rufus Harwood owned the house and property from 1851 until 1860.¹ Rufus Harwood (ca. 1817-) lived here with his wife, Sarah (ca. 1816-) and their three young children. In addition to physical characteristics that point to a mid-19th-century construction date, Harwood purchased the property for \$500 and sold it for \$1,525 nine years later, indicating a substantial improvement (such as a house) to the property.

In 1873, farmer William Redmond (or Redman) purchased the house and 17 acres.² William (1842-) and his wife, Mary (1855-) were both born in Ireland and married in 1873. At the time of the 1900 census, the couple was living here with their adult sons and daughter: William (25), a farm laborer, Sadie (23), and John (21), a milkman. The Redmond family owned the property until 1920.³

¹ Middlesex North Registry of Deeds Book 19, p. 172 and Book 23, p. 168.

² Middlesex North Registry of Deeds Book 98, p. 358.

³ Middlesex North Registry of Deeds Book 628, p. 348.

INVENTORY FORM B CONTINUATION SHEET

CHELMSFORD

126 PROCTOR RD

MASSACHUSETTS HISTORICAL COMMISSION

220 MORRISSEY BOULEVARD, BOSTON, MASSACHUSETTS 02125

Area(s) Form No.

CLM.440

In 1923, Peter and Josefa Wojtas purchased the property.⁴ The Wojtas family are the present-day owners of the property. Peter (ca. 1886-) and Josefa (also known as Josephine) (ca. 1886-) Wojtas were both born in Poland and immigrated in 1901 and 1890, respectively. At the time of the 1930 census, Peter was working as a farmer and the household included their two young nephews, Frank and Steve. Frank Wojtas lived here with his aunt and uncle through the 1940s.

BIBLIOGRAPHY and/or REFERENCES

Chelmsford Tax Assessor records. 2021.

City Directories. Chelmsford Historical Commission and Ancestry.com.

Findagrave.com.

French, Frederick. Plan of Chelmsford. 1794.

Hales, John G. Plan of Chelmsford. 1831.

Massachusetts Census. Ancestry.com.

Massachusetts Birth Records. Ancestry.com.

Massachusetts Death Records. Ancestry.com.

Massachusetts Marriage Records. Ancestry.com.

Middlesex North Registry of Deeds.

Middlesex South Registry of Deeds.

United States Census. Ancestry.com.

Walker, George H. & Co., *Atlas of Middlesex County*. Boston: George H. Walker & Co., 1889.

Walling, Henry Francis. *Map of Middlesex County*. Boston: Smith & Bumstead, 1856.

Waters, Rev. Wilson. *History of Chelmsford, Massachusetts*. Lowell: Courier-Citizen Company. 1917.

SUPPLEMENTARY IMAGES



Shed/garage. View looking north from Proctor Road.

⁴ Middlesex North Registry of Deeds Book 691, p. 526.

INVENTORY FORM B CONTINUATION SHEET

CHELMSFORD

126 PROCTOR RD

MASSACHUSETTS HISTORICAL COMMISSION
220 MORRISSEY BOULEVARD, BOSTON, MASSACHUSETTS 02125

Area(s) Form No.

	CLM.440
--	---------



Barn. View looking north from Proctor Road.

Building Layout

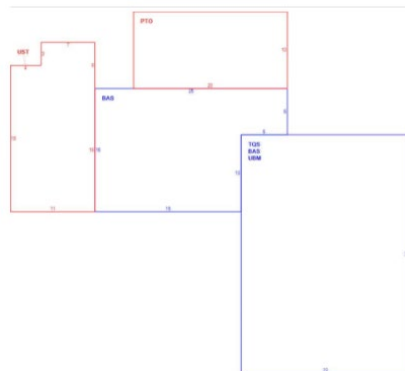

Assessor's Sketch 2022.