

# FORM B – BUILDING

Assessor's Number USGS Quad Area(s) Form Number

125/ 462/ 7/ 1

Billerica,  
MA

CLM.439

MASSACHUSETTS HISTORICAL COMMISSION  
MASSACHUSETTS ARCHIVES BUILDING  
220 MORRISSEY BOULEVARD  
BOSTON, MASSACHUSETTS 02125

**Town/City:** Chelmsford

**Place:** (*neighborhood or village*): South Chelmsford

## Photograph



View looking south.

**Address:** 47 Proctor Road

**Historic Name:** Ebenezer Parker House

**Uses:** Present: Single-family dwelling

Original: Single-family dwelling

**Date of Construction:** ca. 1736

**Source:** Waters

**Style/Form:** No style

**Architect/Builder:** Not known

**Exterior Material:**

Foundation: Stone, cut

Wall/Trim: Wood clapboard / wood trim

Roof: Asphalt shingles

**Outbuildings/Secondary Structures:** None.

**Major Alterations** (*with dates*): Large side and rear ells constructed after 1983.

**Condition:** Good

**Moved:** no  yes  **Date:**

**Acreage:** 0.92

**Setting:** The house is located on a narrow, winding road in a wooded area. Nearby houses date from the 18<sup>th</sup>-20<sup>th</sup> centuries and are located on wooded lots. A nature preserve located across the street to the south is former pastureland associated with this house and farm.

## Locus Map



**Recorded by:** Stacy Spies, Historic Preservation Cons.

**For:** Chelmsford Historical Commission

**Date:** March 2022

# INVENTORY FORM B CONTINUATION SHEET

CHELMSFORD

47 PROCTOR RD

MASSACHUSETTS HISTORICAL COMMISSION

Area(s) Form No.

220 MORRISSEY BOULEVARD, BOSTON, MASSACHUSETTS 02125

CLM.439

 Recommended for listing in the National Register of Historic Places.*If checked, you must attach a completed National Register Criteria Statement form.*

Use as much space as necessary to complete the following entries, allowing text to flow onto additional continuation sheets.

## ARCHITECTURAL DESCRIPTION:

Describe architectural features. Evaluate the characteristics of this building in terms of other buildings within the community.

The house is oriented to the northeast and parallel to Proctor Road. The wooded lot slopes down to the northeast toward the reforested pastureland across the street. An asphalt-paved drive leads from the road past the north elevation toward the rear of the lot. The house consists of a two-story main block with large one-story frame ells that extend from the southeast and northwest elevations.

The two-story frame main block is five bays wide and two bays deep; a single window is located in each gable peak. The building rests on a cut stone slab foundation. The side-gabled eaves have overhanging eaves. The building is clad with clapboard with cornerboards. A pair of interior brick chimneys rise from the north and south ends of rear roof slope.

The façade contains a center entrance sheltered by a frame porch. The porch features a compound molded cornice and shallow wood cornice brackets. The porch's shed roof encompasses two flanking box-bay windows at the first floor. These box bay windows contain two 2/2 wood sash windows on the northeast (façade) elevation and a single 2/2 wood sash window on the side elevations. The windows have wide, flat surrounds. Board and batten panels are located beneath the windows. At the center of the porch is located a projecting cross-gable that shelters the entrance. The porch features jigsaw brackets with trefoil and foliated designs. A jigsaw dogtooth valance echoes the dogtooth details that extend along the box-bay window cornices. The porch floor is of frame construction. The paneled wood double-leaf entry door has tall, slender lights in the top half.

2/2 wood sash windows are also located at the northwest (side) elevation of the main block. At the main block's second story, the 1/1 sash windows are smaller than those at the first level and tucked up against the roof plate. Shutters throughout the main block are of operable louvered wood construction.

The two-story rear ell contains a shed-roof porch on its northwest elevation and shed dormers at the upper level side (south) is a side-gabled block attached to the main block by a one-story hyphen. A row of clerestory windows is located at the eaves.

## HISTORICAL NARRATIVE

Discuss the history of the building. Explain its associations with local (or state) history. Include uses of the building, and the role(s) the owners/occupants played within the community.

47 Proctor Road was likely constructed in the second half of the 18<sup>th</sup> century for a member of the Parker family. In 1794, Ebenezer Parker purchased land in this area from Daniel Parker.<sup>1</sup> The purchase included 35 acres on the north side of what appears to be Proctor Road and another large parcel on the south side of the road. The property descriptions align with general descriptions of this property in later deeds. Also, this house appears to be the residence of Ebenezer Parker that was used to describe schoolhouse locations in 1800: "Near Ebenezer Parker's, South Chelmsford, now District 3."<sup>2</sup>

Ebenezer Parker (1760-1843)<sup>3</sup> was married two times, first to Hannah Fletcher (1767-1790) in 1787 and second to Rebekah Roby (1765-1844) in 1792. Ebenezer and Rebekah Roby Parker had at least four children: daughters Hannah, Louisa, and

<sup>1</sup> Middlesex South Registry of Deeds Book 116, p. 122.

<sup>2</sup> Waters: 560. Also, on the 1831 map, a schoolhouse is depicted a short distance east of this house on Proctor Road.

<sup>3</sup> <https://www.findagrave.com/memorial/126558951/ebenezer-parker>. Accessed Jan. 10, 2022.

# INVENTORY FORM B CONTINUATION SHEET

CHELMSFORD

47 PROCTOR RD

MASSACHUSETTS HISTORICAL COMMISSION

220 MORRISSEY BOULEVARD, BOSTON, MASSACHUSETTS 02125

Area(s) Form No.

CLM.439

Charlotte, and son Jephtha Parker (1795-1848).<sup>4</sup> Jephtha Parker served on the Chelmsford Board of Selectmen in 1839, 1840, 1845, 1846 and 1847.

In 1850, "singlewoman" Charlotte Parker (1806 or 1809-1891) purchased the property, "to wit the old Parker farm, so called," and the buildings upon it from Jephtha Parker's estate.<sup>5</sup>

In 1854, Charlotte Parker sold the Parker "homestead" to Thomas Atherton.<sup>6</sup> The 1856 map indicates that "G. Atherton" was the owner of the property. This appears to be English-born George Atherton (ca. 1822-1865), who is recorded in the 1855 and 1860 censuses in this neighborhood working as a farmer. Atherton and his wife, Eliza, had four children.

In 1870, Arthur Scoboria purchased the house and 18 acres of land: eight acres on the south/west side of the road and ten acres on the north/east side of the road that included a barn and hog yard.<sup>7</sup> Arthur Scoboria (1824-1908)<sup>8</sup> lived here with his wife, Eunice (1842-1908) and their children. Arthur worked as a carpenter, according to census records. From 1875-1879, Arthur and Eunice Scoboria also owned 43 Proctor Road.<sup>9</sup> In 1878, Arthur Scoboria sold half of his property to John Scoboria.<sup>10</sup> After Arthur Scoboria's death, the property passed in 1910 to his son, John, and John's wife, Susan Scoboria.<sup>11</sup> Census records indicate that John also worked as a house carpenter and contractor. The couple had two children.

The property remained in the Scoboria family until 1975, when it was sold to Raymond Kroll and Edward Larter.<sup>12</sup> The Krolls donated land for the Chelmsford Land Conservation Trust's Kroll, Calder, Larter Pasture property across the street, which was historically part of the Proctor farm.

## BIBLIOGRAPHY and/or REFERENCES

- Chelmsford Tax Assessor records. 2021  
City Directories. Chelmsford Historical Commission and Ancestry.com.  
Findagrave.com.  
French, Frederick. Plan of Chelmsford. 1794.  
Hales, John G. Plan of Chelmsford. 1831.  
Massachusetts Census. Ancestry.com.  
Massachusetts Birth Records. Ancestry.com.  
Massachusetts Death Records. Ancestry.com.  
Massachusetts Marriage indices. Ancestry.com.  
Middlesex North Registry of Deeds.  
Middlesex South Registry of Deeds.  
United States Census. Ancestry.com.  
Walker, George H. & Co., *Atlas of Middlesex County*. Boston: George H. Walker & Co., 1889.  
Walling, Henry Francis. *Map of Middlesex County*. Boston: Smith & Bumstead, 1856.  
Waters, Rev. Wilson. *History of Chelmsford, Massachusetts*. Lowell: Courier-Citizen Company. 1917.

<sup>4</sup> <https://www.findagrave.com/memorial/18168955/jephtha-parker>. Accessed March 6, 2022.

<sup>5</sup> Middlesex South Registry of Deeds Book 584, p. 351.

<sup>6</sup> Middlesex South Registry of Deeds Book 693, p. 214.

<sup>7</sup> Middlesex North Registry of Deeds Book 75, 189.

<sup>8</sup> <https://www.findagrave.com/memorial/18164251/arthur-scoboria>. Accessed Dec. 8, 2021.

<sup>9</sup> Middlesex North Registry of Deeds Book 111, p. 131 and Book 133, p. 212.

<sup>10</sup> Middlesex North Registry of Deeds Book 132, p. 9.

<sup>11</sup> Middlesex North Registry of Deeds Book 460, p. 273, Book 460, p. 273.

<sup>12</sup> Middlesex North Registry of Deeds Book 2167, p. 456.

# INVENTORY FORM B CONTINUATION SHEET

CHELMSFORD

47 PROCTOR RD

MASSACHUSETTS HISTORICAL COMMISSION  
220 MORRISSEY BOULEVARD, BOSTON, MASSACHUSETTS 02125

Area(s) Form No.

CLM.439

## SUPPLEMENTARY IMAGES



Facade. View looking south.



House footprint, as shown on 1983 Plan. Plan Book 141, Plan 144.

Building Layout

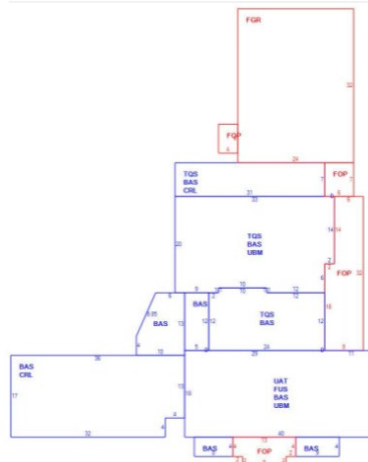

Assessor's Sketch 2022.