

FORM B – BUILDING

MASSACHUSETTS HISTORICAL COMMISSION
MASSACHUSETTS ARCHIVES BUILDING
220 MORRISSEY BOULEVARD
BOSTON, MASSACHUSETTS 02125

Assessor's Number USGS Quad Area(s) Form Number

35/145/7	Westford		CLM.310
----------	----------	--	---------

Town/City: Chelmsford

Place: (*neighborhood or village*): West Chelmsford

Photograph



Address: 32 School Street

Historic Name: Whidden/Olson House

Uses: Present: single-family dwelling

Original: single-family dwelling

Date of Construction: 1862-1863

Source: Chelmsford tax/real estate valuation records

Style/Form: Greek Revival

Architect/Builder: unknown

Exterior Material:

Foundation: stone

Wall/Trim: wood clapboard/wood

Roof: asphalt shingle

Outbuildings/Secondary Structures:
Shed

Major Alterations (*with dates*):

1986: interior changes and additions

2006 dormer addition

Condition: Fair

Moved: no yes **Date:**

Acreage: .49 A

Setting: The house is located approximately 40' northeast of School St. The West Chelmsford Cemetery is behind the parcel. A parking area is at the rear of the house and is accessible via Cemetery Ln. The lot is flat and grassy with several mature trees. The surrounding area includes 19th and 20th c. residential development and the cemetery.

Locus Map

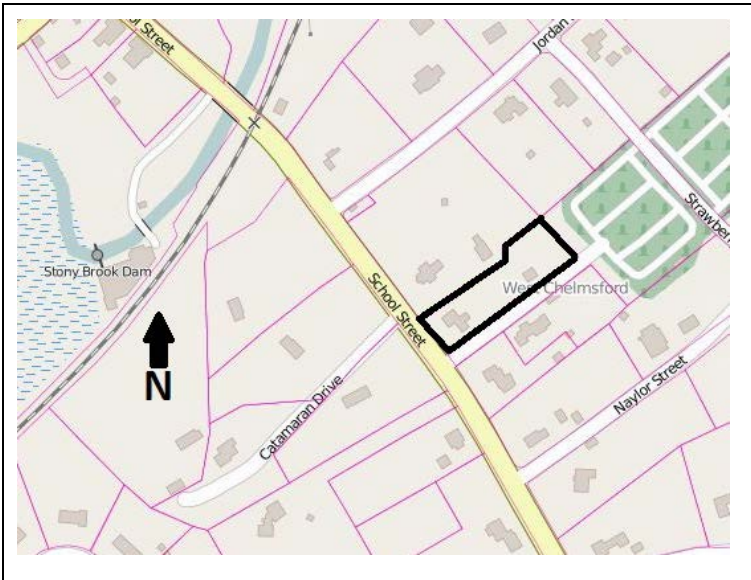

Recorded by: Jennifer Burden, Gray & Pape, Inc.

Organization: Chelmsford Historical Commission

Date (*month / year*): June 2016

INVENTORY FORM B CONTINUATION SHEET

CHELMSFORD

32 SCHOOL

STREET

MASSACHUSETTS HISTORICAL COMMISSION
220 MORRISSEY BOULEVARD, BOSTON, MASSACHUSETTS 02125

Area(s) Form No.

CLM.310

Recommended for listing in the National Register of Historic Places.
If checked, you must attach a completed National Register Criteria Statement form.

Use as much space as necessary to complete the following entries, allowing text to flow onto additional continuation sheets.

ARCHITECTURAL DESCRIPTION:

Describe architectural features. Evaluate the characteristics of this building in terms of other buildings within the community.

This building is located on the eastern side of School Street, just south of Cemetery Lane. It is an upright and wing house. Built of wood frame construction and stands one and-a-half stories in height. The roof is covered with asphalt shingles and the exterior walls are clad with wood clapboard. The building rests atop a granite foundation. The primary (southwest) façade faces toward School Street. The façade of the upright portion of the house is divided into three bays with a door located in the first bay on the south side of the façade. Most of the fenestration consists of historic, two-over-two, wood, double-hung windows. Some of the other windows are modern replacements or additions. The wing, which extends to the south of the upright portion of the house, is divided into three bays with a door located in the center of the wing. A recessed porch extends the width of two bays. The third bay, located at the southern end of the wing, is a recent addition. The siding appears to be replacement, but it is consistent with historical wood clapboard.

The house is an altered example of a mid-nineteenth century residence that retains historic integrity of location, setting, feeling, and association.

HISTORICAL NARRATIVE

Discuss the history of the building. Explain its associations with local (or state) history. Include uses of the building, and the role(s) the owners/occupants played within the community.

A thorough history of the property is provided on the original inventory form that Jane B. Drury completed in February 2007 for the Chelmsford Historic Commission. No changes to the property have occurred since this date.

BIBLIOGRAPHY and/or REFERENCES

Drury, Jane B. Massachusetts Historical Commission Inventory Form CLM.310. February 2007. Available at the Massachusetts Historical Commission Office, Boston, MA.

INVENTORY FORM B CONTINUATION SHEET

CHELMSFORD

32 SCHOOL

STREET

MASSACHUSETTS HISTORICAL COMMISSION
220 MORRISSEY BOULEVARD, BOSTON, MASSACHUSETTS 02125

Area(s) Form No.

	CLM.310
--	---------

National Register of Historic Places Criteria Statement Form

Check all that apply:

- Individually eligible Eligible **only** in a historic district
 Contributing to a potential historic district Potential historic district

Criteria: **A** **B** **C** **D**

Criteria Considerations: **A** **B** **C** **D** **E** **F** **G**

Statement of Significance

The area of West Chelmsford is eligible for inclusion in the National Register of Historic Places as a locally significant historic district under Criterion A for the development of this area around the Roby Manufacturing Company and Chelmsford Woolen Mills as well as under Criterion C for its intact examples of mid-nineteenth through early twentieth century residential architecture. The boundary of the proposed district would include resources built during the period of significance along Main Street from approximately Loisselle Lane in the north to the Westford Town Line, as well as resources along School Street between Main Street and Graniteville Road. This building at 32 School Street would be a contributing resource to that district as an example of residential architecture constructed during its period of significance that retains some historic integrity.