

FORM B – BUILDING

MASSACHUSETTS HISTORICAL COMMISSION
MASSACHUSETTS ARCHIVES BUILDING
220 MORRISSEY BOULEVARD
BOSTON, MASSACHUSETTS 02125

Assessor's Number USGS Quad Area(s) Form Number

47/149/1

Westford

CLM 411

Town/City: Chelmsford

Place: West Chelmsford

Photograph



Address: 59 School Street

Historic Name: William and Agnes Hill House

Uses: Present: single-family dwelling

Original: single-family dwelling

Date of Construction: 1853

Source: Tax Records, Deeds and Maps

Style/Form: Greek Revival

Architect/Builder: unknown

Exterior Material:

Foundation: stone

Wall/Trim: wood Clapboard/wood

Roof: Asphalt shingle

Outbuildings/Secondary Structures:

Detached garage

Major Alterations (with dates):

Unknown date: porch addition

Condition: Good

Moved: no yes **Date:**

Acreage: .92

Setting: The house is located approximately 100' southwest of School St. A gravel drive south of the house leads to the detached garage. The lot is flat and grassy with mature trees and shrubs along the perimeter. The surrounding area includes 19th and 20th c. residential development.

Locus Map

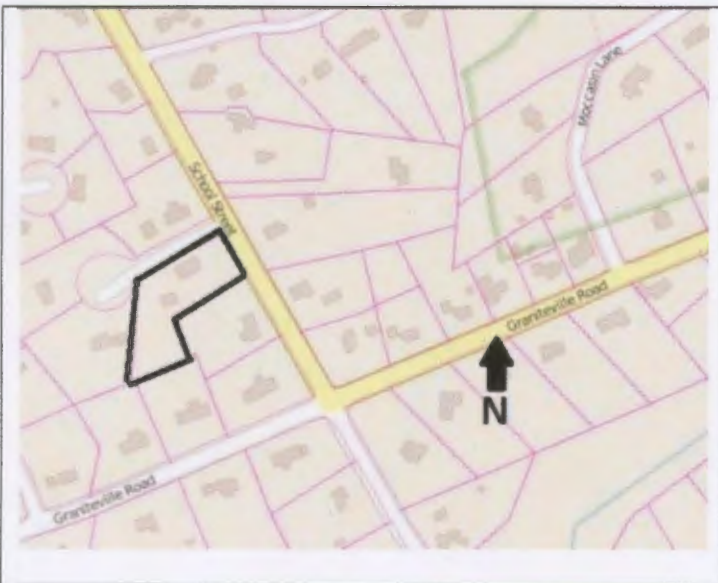

Recorded by: Linda V. Prescott

Organization: Chelmsford Historical Commission

Date: September, 2024

INVENTORY FORM B CONTINUATION SHEET

CHELMSFORD

59 SCHOOL STREET

MASSACHUSETTS HISTORICAL COMMISSION

220 MORRISSEY BOULEVARD, BOSTON, MASSACHUSETTS 02125

Area(s) Form No.

CLM.411

Recommended for listing in the National Register of Historic Places.

If checked, you must attach a completed National Register Criteria Statement form.

Use as much space as necessary to complete the following entries, allowing text to flow onto additional continuation sheets.

ARCHITECTURAL DESCRIPTION:

Describe architectural features. Evaluate the characteristics of this building in terms of other buildings within the community.

This building is located at the south corner of School Street and Quessy Lane. It is a ca. 1850, 2.5-story, front gable, wood frame house. The house follows a rectangular plan. The roof is covered with asphalt shingles and the exterior walls are clad with wood clapboard with wood trim. The house rests atop a stone foundation. Two internal brick chimneys are present on the house; one is along the ridgeline at the rear gable and the other is on the south slope of the roof closer to the front gable. The primary (northeast) façade faces School Street. It is divided into three bays on the first and second stories and two on the half story. The front door is located in the first bay on the south side of the façade. The door and windows are not arranged symmetrically across the façade, as the pair of windows to the right of the door are separated from the entryway by about one bay in width. This offset pattern is repeated on the second story. The pair of windows under the gable in the half story are arranged symmetrically. The fenestration consists of six-over-six double-hung windows. A wraparound one-story porch extends the full length of the primary façade as well the south side of the house. The porch has a shed roof that is supported by a series of narrow Doric columns. The building appears to retain its original design and most of its original materials, including siding and windows. The wraparound porch is likely a later addition but probably dates to the early history of the house.

A later two-story garage building is located to the south of the house. The garage has an asymmetrical front gable roof, is covered with wood shingles, and has a vertical plank garage door on its northeast wall.

The house is a good example of a mid-nineteenth century residence that retains all historic integrity.

HISTORICAL NARRATIVE

Discuss the history of the building. Explain its associations with local (or state) history. Include uses of the building, and the role(s) the owners/occupants played within the community.

The building appears on the 1856 map of Chelmsford as owned by William Hill. The 1855 Massachusetts Census lists William Hill (born ca. 1798) living in West Chelmsford with wife Agnes (born ca. 1801) with William employed as a wool assorter. By 1875, the Beers map of Chelmsford shows that George Mills had assumed ownership of the property. The 1870 census lists Mills (born ca. 1812) living in Chelmsford with wife Margaret (born ca. 1815) and farming. The 1880 census lists the same information, but niece Bertha Heathwood was then also living with them while she was employed in the woolen mill. In 1892 the Mills sold the property to Charles Andrews. The 1896 city directory lists Andrews living on School Street and working as a farmer. In 1898 he sold the property to James Brown. The 1905 city directory notes that Brown died in 1904. That year his estate transferred the property to Margaret Quist. In 1910 Margaret was living on School Street with husband Paul (both born ca. 1882) and brother Benjamin Brown (born ca 1884). In 1910 Paul was working in a quarry and Benjamin in the woolen mill. Paul died in 1914 and Margaret remarried in 1915 to William C. Edwards, Jr. In 1917 she sold the property to Charles Lull. The 1920 census lists Charles (born ca. 1855) living on School Street with wife Jennie (ca. 1861-1950), brother Frank, and a lodger named Joseph Murphy. In 1920 Charles was a janitor in the public school. Charles died in 1923 and Jennie retained the property until 1928. That year she sold it to Hiram Richardson, whose family kept it until 1951. The 1940 census lists Richardson living on School Street with step father Norman Provencher (born ca. 1869 in French Canada) and working as a poultryman. Richardson was born ca. 1901 in Illinois; therefore, he was an uncommon west-to-east migrant. In 1951 Richardson sold the property to Robert Egan, whose family retains ownership of the property.

INVENTORY FORM B CONTINUATION SHEET

CHELMSFORD

59 SCHOOL STREET

MASSACHUSETTS HISTORICAL COMMISSION
220 MORRISSEY BOULEVARD, BOSTON, MASSACHUSETTS 02125

Area(s) Form No.

	CLM.411
--	---------

BIBLIOGRAPHY and/or REFERENCES

Beers, F.W. *County Atlas of Middlesex, Massachusetts*. J.B. Beers & Co., New York. 1875.

Genealogical research, including U.S. and Massachusetts census records; birth, marriage, and death records; and city directory records from ancestry.com.

Geo. H. Walker & Co. *Atlas of Middlesex County, Massachusetts*. Geo. H. Walker & Co., Boston, MA. 1889.

Merriam, Fred. *Images of America: North and West Chelmsford*. Arcadia Publishing, Charleston, South Carolina. 2016.

Middlesex North Registry of Deeds. www.lowelldeeds.com.

Walling, Henry F. *Map of Middlesex County, Massachusetts*. Smith & Bumstead, Boston, MA. 1856.



Garage, facing west. November 2015.

INVENTORY FORM B CONTINUATION SHEET

CHELMSFORD

59 SCHOOL STREET

MASSACHUSETTS HISTORICAL COMMISSION
220 MORRISSEY BOULEVARD, BOSTON, MASSACHUSETTS 02125

Area(s) Form No.

	CLM.411
--	---------

National Register of Historic Places Criteria Statement Form

Check all that apply:

- Individually eligible Eligible **only** in a historic district
- Contributing to a potential historic district Potential historic district

Criteria: **A** **B** **C** **D**

Criteria Considerations: **A** **B** **C** **D** **E** **F** **G**

Statement of Significance

The area of West Chelmsford is eligible for inclusion in the National Register of Historic Places as a locally significant historic district under Criterion A for the development of this area around the Roby Manufacturing Company and Chelmsford Woolen Mills as well as under Criterion C for its intact examples of mid-nineteenth through early twentieth century residential architecture. The boundary of the proposed district would include resources built during the period of significance along Main Street from approximately Loiselle Lane in the north to the Westford Town Line, as well as resources along School Street between Main Street and Graniteville Road. This building at 59 School Street would be a contributing resource to that district as an example of residential architecture constructed during its period of significance that retains historic integrity.

59 School Street
Tax Summary

YEAR	DIST/ PREC	PG/LN	LAST NAME	FIRST NAME	DESCRIPTION	VALUE	PROPERTY	SIZE/ ACRE	LAND VALUE	NOTES
1931		201/47	Richardson	Hiram I.	Dwelling & Shed Barn & Shed Hen House & Shop Water Tannk	\$1,750.00 \$350.00 \$50.00 \$50.00	School St	7	\$850.00	
1930	P3	148/1	Richardson Provencher	Hiram I. Norven J.	Dwelling & Shed Barn & Shed Hen House & Shop Water Tannk	\$1,750.00 \$350.00 \$50.00 \$50.00	School St	7	\$850.00	
1929	P3	140/2 201/6	Richardson Richardson	Hiram I. Hiram I.	Dwelling & Shed Barn & Shed Hen House & Shop Water Tank	\$1,750.00 \$350.00 \$50.00 \$50.00	School St	7	\$850.00	see Lowell + set property should be in pres 2
1928	3	95/41	Lull	Jennie			Westford Rd, Butterfield	22	\$1,000.00	Lot
1927	3	93/46 -48	Lull Fisher	Jennie Alec				32	\$1,000.00	see Alec Fisher set to Jennie Lull, West Rd., Butterfield Lot
1925	3	127/26	Lull	Charles A. Frank E.	Dwelling & Shed Barn & Shed Hen House & Shop Water Tank	\$1,700.00 \$350.00 \$50.00 \$50.00	School St. Butterfield/Westford Rd	7 32	\$1,000.00 \$1,000.00	set to Jennie Lull, Lowell
1920	D9	106/11	Lull	Frank E. Charles A.	Dwelling & Shed Hen House & Shop Barn Tank	\$1,600.00 \$50.00 \$300.00 \$90.00	Home Improved Land Butterfield/Westford Rd	7 32	\$1,000.00 \$960.00	

59 School Street
Tax Summary

YEAR	DIST/ PREC	PG/LN	LAST NAME	FIRST NAME	DESCRIPTION	VALUE	PROPERTY	SIZE/ ACRE	LAND VALUE	NOTES
1919	10	104/36	Lull	Frank E. + Charles A.	Dwelling + Shed	\$1,200.00	Home Improved Land	7	\$700.00	
					Hen House & Shop Barn	\$50.00 \$300.00	Butterfield Lot	32	\$1,000.00	
					Tank	\$90.00				
1918	8	100/42	Lull	Frank E. + Charles A.	Dwelling + Shed	\$1,200.00	Home Improved Land	7	\$800.00	
					Hen House & Shop Barn	\$50.00 \$300.00	Butterfield Lot	32	\$960.00	
					Tank	\$90.00				
1917		101/43	Lull	Frank E. Charles A.	Dwelling & Shed Barn	\$1,200.00 \$300.00	Home Improved Land	7	\$800.00	see Luzern Safford, Dist 7 set Butterfield Imp. Land
					Hen House & Shop Water Tank	\$50.00 \$90.00				
1917	D7	/4	Safford	Luzern						set Butterfield Imp Charles A. and Frank E. Lull, Dist 9
1916	D9	101/43	Lull	Charles A. Frank E.	Dwelling & Shed Barn	\$1,200.00 \$300.00	Home Improved Land	7	\$800.00	
					Hen House & Shop Tank	\$50.00 \$70.00				see Luzern Safford Dist 7
1916	7	51/39	Edwards	Margaret L. Mrs.	Dwelling & Shed	\$1,100.00	Home Improved Land	7		set to Charles A. & Frank E. Lull, Dist 9
					Barn	\$300.00				
					Hen House & Shop Tank	\$50.00 \$70.00				

59 School Street
Tax Summary

YEAR	DIST/ PREC	PG/LN	LAST NAME	FIRST NAME	DESCRIPTION	VALUE	PROPERTY	SIZE/ ACRE	LAND VALUE	NOTES
1915	D 6 D 7	-25 133/22	Edwards Quist	Margaret Margaret, Mrs.						see Maragaret Quist set to Margaret L. Edwards in 1916
1914	D7	131/24	Quist	Margaret, Mrs.	Dwelling & Shed	\$1,100.00	Home Improved Land	6	\$750.00	
					Barn	\$300.00				
					Hen House & Shop	\$50.00				
					Tank	\$90.00				
1910	D7	103/20	Quist	Maragaret D. Mrs	Dwelling & Shed	\$1,100.00	Home Improved Land	6	\$750.00	
					Barn	\$300.00				
					Hen House & Shop	\$50.00				
					Tank	\$90.00				
1905	D7	73/32	Quist	Andrew J.	Dwelling	\$900.00	Home Improved Land	7	\$350.00	
					Barn	\$1,000.00			\$200.00	
					Barn #2	\$150.00	Butterfield Imp Landd	22A	\$1,000.00	
					Hen House	\$75.00	Corigan Imp Land	.75	\$100.00	

YEAR	DIST/ PREC	PG/LN	LAST NAME	FIRST NAME	DESCRIPTION	VALUE	PROPERTY	SIZE/ ACRE	LAND VALUE	NOTES
1904	9/3	83/10	Quist	Maragaret	Dwelling	\$1,000.00	Home Improved Land	6	\$500.00	
					Barn	\$300.00				
					Hen House	\$30.00				
					Windmill & Tank	\$80.00				
1903	7/3	79/12	Quist	Andrew J.	Dwelling	\$800.00	Home Improved Land	7	\$300.00	
					Barn #1	\$1,000.00	Unimproved Land	7	\$200.00	
					Hen House	\$75.00	Corigan Lot	.75	\$100.00	

59 School Street
Tax Summary

YEAR	DIST/ PREC	PG/LN	LAST NAME	FIRST NAME	DESCRIPTION	VALUE	PROPERTY	SIZE/ ACRE	LAND VALUE	NOTES
1903	7/3	79/12	Brown	James	Dwelling	\$700.00	Home Improved Land	16	\$1,200.00	property set to Margaret Quist
					Barn	\$1,000.00	Home Wood Land	3	\$100.00	
					Hen House	\$50.00				
					Shed	\$200.00				
					Wiindmill+Tank	\$180.00				
1900	7	11/36	Brown	James	Dwelling	\$1,000.00	Home Improved Land	6	\$450.00	
					Barn	\$300.00				
					Hen House	\$30.00				
					Windmill & Tank	\$30.00				
1899	7/2	10/32	Brown	James	Dwelling	\$1,000.00	Home Improved Land	6	\$450.00	
					Barn	\$300.00				
					Hen House	\$30.00				
					Windmill+Tank	\$30.00				
1898	7	30/2	Drury + Brown	John A. + James			Improved Land +Sprout	37		
1898	7	30/2	Brown + Drury	James + John A.	Dwelling	\$1,000.00	Home Improved Land	12.5	\$700.00	
					Barn	\$500.00	Improved Land	2	\$50.00	
					Hen House	\$25.00				
					Windmill+Tank	\$25.00	set to Loiselle, Lowell			
1897	7/3	24/41	Gammell	Pliny F.	Dwelling	\$1,000.00	Home Improved Land	12.5	\$700.00	
					Barn	\$500.00	Bonney Improved Land	2	\$150.00	Land Out to John A. Anderson
					Hen House	\$50.00	Improved Wood	2	\$50.00	
					Windmill+Tank	\$50.00	Unimproved Land	8	\$100.00	
					Barn	\$150.00	Home Wood Land	3	\$100.00	
					Shed & Hen House	\$200.00				
					Hen House	\$50.00				
					Windmill & Tank	\$180.00				

59 School Street
Tax Summary

YEAR	DIST/ PREC	PG/LN	LAST NAME	FIRST NAME	DESCRIPTION	VALUE	PROPERTY	SIZE/ ACRE	LAND VALUE	NOTES
1895	D7	2/44	Andrew	Charles A.	Dwelling	\$1,000.00	Home Improved Land	12.5	\$700.00	
					Barn	\$500.00	Bonney Improved Land	2	\$150.00	
					Hen House	\$25.00	Improved Wood Land	2	\$50.00	
						Unimproved Land & Wood	8	\$100.00		
1894	7/1	3/7	Andrews	Charles	Dwelling	\$1,000.00	Home Improved Land	13	\$700.00	
					Barn	\$500.00	Bonney Improved Land	2	\$150.00	
					Hen House	\$25.00	Improved Wood Land	2	\$50.00	
						Unimproved Land & Wood	8	\$150.00		
1893	7/1	3/34	Andrews	Charles	Dwelling	\$100.00	House Improved Land	13	\$700.00	
					Barn	\$500.00	Bonney Improved Land	2	\$150.00	
							Unimproved Land & Wood	8	\$150.00	

YEAR	DIST/ PREC	PG/LN	LAST NAME	FIRST NAME	DESCRIPTION	VALUE	PROPERTY	SIZE/ ACRE	LAND VALUE	NOTES
1892	7/1	3/7	Andrews	Charles	Dwelling	\$1,000.00	House Improved Land	13	\$700.00	
					Barn	\$250.00	Bonney Improved Land	2	\$150.00	
							Improved Wood Land	2	\$100.00	
						Unimproved Land & Wood Land	8	\$150.00		

59 School Street
Tax Summary

YEAR	DIST/ PREC	PG/LN	LAST NAME	FIRST NAME	DESCRIPTION	VALUE	PROPERTY	SIZE/ ACRE	LAND VALUE	NOTES	
1891	7/3	38/9	Mills	Geo.	Dwelling	\$1,000.00	House Improved Land	13	\$700.00	set lot 8 to Charles Andrews	
					Barn	\$250.00	Bonney Improved Land	2	\$150.00		
							Wood Improved Land	2	\$100.00		set to Charles Andrews
							Unimproved Land & Wood	8	\$200.00		set to Charles Andrews
1889	7/3	38/6	Mills	Geo	Dwelling	\$1,000.00	Home Improved Land	13	\$700.00		
					Barn	\$250.00	Unimproved Land	9	\$270.00		
							Wood Land	2	\$80.00		set to Charles Andrews
							Bonney Improved Land	2.5	\$200.00		
1888	7/3	37/35	Mills	Geo	Dwelling	\$1,000.00	Home Improved Land	13	\$700.00		
					Barn	\$250.00	Unimproved Land	9	\$270.00		
							Wood Land	2	\$80.00		set to Charles Andrews
							Bonney Improved Land	2.5	\$200.00		
1887	7/3	40/17	Mills	Geo	Dwelling	\$1,000.00	Home Improved Land	13	\$700.00		
					Barn	\$250.00	Unimproved Land	9	\$270.00		
							Wood Land	2	\$80.00		set to Charles Andrews
							Bonney Improved Land	2.5	\$200.00		
1886	7	34/12	Mills	Geo	Dwelling	\$300.00	Home Improved Land	11	\$500.00		
					Barn	\$200.00	Spaulding	4	\$100.00		
1885	7	26/24	Mills	Geo	Dwelling	\$1,000.00	Home Improved Land	13	\$700.00		
					Barn	\$250.00	Unimproved Land	9	\$270.00		
							Bonney Improved Land	2.5	\$250.00		

59 School Street
Tax Summary

YEAR	DIST/ PREC	PG/LN	LAST NAME	FIRST NAME	DESCRIPTION	VALUE	PROPERTY	SIZE/ ACRE	LAND VALUE	NOTES
1884	7	42/3	Mills	Geo	Dwelling	\$1,000.00	Home Improved Land	13	\$700.00	
					Barn	\$250.00	Unimproved Land	9	\$270.00	
							Bonney Improved Land	2.5	\$250.00	
1880	7	29/6	Mills	Geo	Dwelling	\$1,000.00	Home Improved Land	13	\$650.00	
					Barn	\$250.00	Unimproved Land	9	\$275.00	
					Dwelling Bonney	\$250.00	Wood Land	2	\$70.00	
							Bonney Improved Land	3	\$300.00	
1879	7	32/2	Mills	Geo	Dwelling	\$1,000.00	Home Improved Land	13	\$650.00	
					Barn	\$250.00	Unimproved Land	9	\$275.00	
					Dwelling Bonney	\$35.00	Wood Land	2	\$70.00	
							Bonney Improved Land	3	\$300.00	
1875	7	32/5	Mills	Geo	Dwelling	\$1,000.00	Home Improved Land	13	\$650.00	
					Barn	\$250.00	Unimproved Land	9	\$275.00	
					Dwelling Bonney	\$35.00	Wood Land	2	\$70.00	
							Bonney Improved Land	3	\$300.00	
1874	7	33/12	Mills	Geo	Dwelling	\$1,000.00	Home Improved Land	9	\$360.00	
					Barn	\$250.00	Unimproved Land	3	\$250.00	
					Dwelling Bonney	\$550.00	Bonney Improved Land	3	\$250.00	
							Farrar Improved Land	3	\$250.00	
							Fuller Improved Land	3	\$250.00	
							Spalding Improved Land	4	\$200.00	

59 School Street
Tax Summary

YEAR	DIST/ PREC	PG/LN	LAST NAME	FIRST NAME	DESCRIPTION	VALUE	PROPERTY	SIZE/ ACRE	LAND VALUE	NOTES
1873	8	33/23	Mills	George	Dwelling House	\$500.00	Home Improved Land			
					Barn	\$375.00	Home Unimproved Land	8	\$230.00	
1870	7	37/18	Mills	George	Corn Barn	\$35.00	Home Wood Land	7	\$300.00	
					Dwelling House	\$750.00	Improved Land	7	\$360.00	
					Barn	\$225.00	Unimproved Land	3	\$110.00	
					Bonney Dwelling House	\$250.00	Bonney Improved Land	3	\$250.00	
							Ferrar Improved Land	3	\$250.00	
							Fuller Improved Land	1.5	\$200.00	
							Spaldinig Improve Land	4	\$200.00	
1865	7	33/25	Mills	George	Dwelling House	\$725.00	Improved Land	7	\$350.00	
					Barn	\$225.00	Unimproved Land	3	\$90.00	
					Bonney Dwelling House no 110	\$250.00	Improved Land Bonney	3A	\$225.00	
							Improved Land J Farrar	3	\$250.00	
1864	7	32/29	Mills	George	Dwelling House (Hill)	\$725.00	Improved Land (Hill)	7	\$350.00	
					Barn	\$225.00	Unimproved Land (Hill)	3	\$90.00	
					Dwelling (Bonney)	\$250.00	Improved Land	3	\$225.00	
							Improved Land (Farrar)	3	\$250.00	
1863	7	29/8	Mills	George	Poll Tax	\$2.00				
	7	22/48	Hill	William	Dwelling House	\$725.00	Improved Land	7	\$350.00	residence unknown
					Barn	\$225.00	Unimproved Land	3	\$90.00	
1858		-/30	Hill	William	House + Barn	\$1,100.00	Improved Land	6.5	\$300.00	
1856		116	Hill	William	House + Barn	\$1,100.00	Improved Land	6.5	\$600.00	
1855		52	Hill	William	House + Barn	\$1,100.00	Improved Land	6.5	\$600.00	
1853		21	Hill	William	House + Barn	\$1,000.00	Improved Land	6.5	\$300.00	
1852		19	Hill	William			Land	6.5	\$300.00	

59 School Street
 Tax Summary

YEAR	DIST/ PREC	PG/LN	LAST NAME	FIRST NAME	DESCRIPTION	VALUE	PROPERTY	SIZE/ ACRE	LAND VALUE	NOTES
1851		21	Hill	William			Improved Land	12	\$500.00	
							Unimproved Land	3	\$75.00	
1847		26	Hill	William	Poll Tax	\$1.20				

59 School Street
Resident List

YEAR	PUBLICATION	PG	LAST NAME	FIRST NAME	OCCUPATION	AGE	NOTES
1955	Chelm Voter	16	Egan	Robert	Stationary Foreman	37	
				Evelyn	House Wife	31	
1954		14	Egan	Robert	Stationary Foreman	36	
		15		Evelyn	House Wife	30	
1953		15	Egan	Robert	Stationary Foreman	29	
		15		Evelyn	House Wife	29	
1952		n15	Egan	Robert	Stationary Foreman	34	
		15		Evelyn	House Wife	28	
1951		n39	Richardson	Hiriam L.	Interene	50	
1950		n36	Richardson	Hiriam L.	Interene	49	
1949		n35	Richardson	Hiriam L.	Interene	48	
1948		n35	Richardson	Hiriam L.	Chemist	48	
1947		n34	Richardson	Hiriam L.	Chemist	46	
1946		n34	Richardson	Hiriam L.	Chemist	46	
1945		n35	Richardson	Hiriam L.	Chemist	44	
1944		n34	Richardson	Hiriam L.	Chemist	43	
1943		n34	Richardson	Hiriam L.	Army	42	
1942		n33	Richardson	Hiriam L.	Army	41	
1941		n32	Richardson	Hiriam L.	Poultryman	40	
1940		n32	Richardson	Hiriam L.	Poultryman	39	
1939	Voter List	32	Richardson	Hiriam L.	Poultryman	38	
1932	Lowell Subu.	187	Richardson	Hiriam L.	Chemist		
		187	Provencher	Norvan J.	Farmer		b Hiriam L. Richardson's
1925-26	Lowell Subu.	226	Lull	Jennie L.	wid Charles H.		rem to Lowell
		278	Lull	Charles A.	Farmer + Janitor		h School n Lowell + Westford rd.WC
1921				Jennie L.	wife		
1917		191	Lull	Charles A.	Farmer		Jennie L. wife
		159	Brown	James	James died Oct 6 1904		
1905		190	Quist	Andrew G.	stonecutter		
1898		167	Gammell	Pliny F.	Farmer		
		154	Andrews	Charles A.	rem to Lowell		
1896		176	Andrews	Charles A.	Farmer		

DATE	BK/PG	NAMES	DESCRIPTION
Feb 27 1992	5835/119	Egan to Egan Trust	Robert F. and Evelyn R. Egan, both of Chelmsford to Robert F. and Evelyn R. Egan, both of 59 School Street, Chelmsford and Richard P. Egan of 12 Blood Street, Pepperell, Trustees of the Egan Trust the land and buildings located on the Westerly side of School Street in West Chelmsford and being Lot #1 on PB 173/71. Containing 40,274 sq. ft.
May 1 1951	1166/555	Richardson to Egan	Hiram L. Richardson, unmarried and Mary E. Moody, both of Chelmsford to Robert F. and Evelyn R. Egan, husband and wife as tenants by the entirety the land and buildings located in West Chelmsford on the Westerly side of School Street described as: Beginning at the corner of Chelmsford and Westford Roads; thence Westerly on Westford Road 580 ft. to a stone wall and land of the late Levi T. Fletcher; thence Northerly by wall and Fletcher land 553 ft. to land now or formerly of William C. Edwards; thence Easterly by stone wall and Edwards land 343 ft. to a stone bound now or formerly of George Snow; thence Southerly by Snow land 109.5 ft. to a stone bound; thence Easterly still by Snow land 180.5 ft. to a stone bound on road from West Chelmsford to Chelmsford Centre; thence Southerly by road 490 ft. to the beginning point. Benjamin F. Moody of said Mary E. Moody release rights. Containing 7 acres

- May 15 1946 1044/328 Richardson to Richardson Hiram I. Richardson, unmarried of Chelmsford to Hiram L. Richardson of Chelmsford and Mary E. Moody of Raymond, New Hampshire, as joint tenants, the land and buildings located in West Chelmsford on the **Westerly** side of School Street described as: Beginning at the corner of Chelmsford and Westford Roads; thence **Westerly** on Westford Road 580 ft. to a stone wall and land of the late Levi T. Fletcher; thence **Northerly** by wall and Fletcher land 553 ft. to land now or formerly of William C. Edwards; thence **Easterly** by stone wall and Edwards land 343 ft. to a stone bound now or formerly of George Snow; thence **Southerly** by Snow land 109.5 ft. to a stone bound; thence **Easterly** still by Snow land 180.5 ft. to a stone bound on road from West Chelmsford to Chelmsford Centre; thence **Southerly** by road 490 ft. to the beginning point. Containning 7 acres.
- Feb 20 1931 799/598 Hodnet to Richardson et al. Mary E. Hodnet, unmarried of Lowell to Hiram L. Richardson and Norven J. Provencher, both of Chelmsford, as joint tenants the land and buildings located in West Chelmsford on the **Westerly** side of School Street described as: Beginning at the corner of Chelmsford and Westford Roads; thence **Westerly** on Westford Road 580 ft. to a stone wall and land of the late Levi T. Fletcher; thence **Northerly** by wall and Fletcher land 553 ft. to land now or formerly of William C. Edwards; thence **Easterly** by stone wall and Edwards land 343 ft. to a stone bound now or formerly of George Snow; thence **Southerly** by Snow land 109.5 ft. to a stone bound; thence **Easterly** still by Snow land 180.5 ft. to a stone bound on road from West Chelmsford to Chelmsford Centre; thence **Southerly** by road 490 ft. to the beginning point. Containing 7 acres

Feb 20 1931 799/597 Richardson to Hodnet Hiram L. Richardson, unmarried of Chelmsford to Mary E. Hodnet of Lowell the land and buildings located in West Chelmsford on the **Westerly** side of School Street described as: Beginning at the corner of Chelmsford and Westford Roads; thence **Westerly** on Westford Road 580 ft. to a stone wall and land of the late Levi T. Fletcher; thence **Northerly** by wall and Fletcher land 553 ft. to land now or formerly of William C. Edwards; thence **Easterly** by stone wall and Edwards land 343 ft. to a stone bound now or formerly of George Snow; thence **Southerly** by Snow land 109.5 ft. to a stone bound; thence **Easterly** still by Snow land 180.5 ft. to a stone bound on road from West Chelmsford to Chelmsford Centre; thence **Southerly** by road 490 ft. to the beginning point. Containing 7 acres

May 5 1928 762/402 Lull to Richardson Jennie L. Lull, unmarried of Nashua, New Hampshire to Hiram L. Richardson, of Lowell, the land and buildings located in West Chelmsford on the **Westerly** side of School Street described as: Beginning at the corner of Chelmsford and Westford Roads; thence **Westerly** on Westford Road 580 ft. to a stone wall and land of the late Levi T. Fletcher; thence **Northerly** by wall and Fletcher land 553 ft. to land now or formerly of William C. Edwards; thence **Easterly** by stone wall and Edwards land 343 ft. to a stone bound now or formerly of George Snow; thence **Southerly** by Snow land 109.5 ft. to a stone bound; thence **Easterly** still by Snow land 180.5 ft. to a stone bound on road from West Chelmsford to Chelmsford Centre; thence **Southerly** by road 490 ft. to the beginning point. Containing 7 acres. Charles A. Lull died April 6, 1932

Apr 28 1917 570/560

Grant to Lull

Florence E. Grant, unmarried of Chelmsford to Charles A. and Jennie L. Lull, wife of Charles Lull both of Chelmsford, as tenants in common by the entirety **One Undivided Half** the land and buildings located in West Chelmsford on the **Westerly** side of School Street described as: Beginning at the corner of Chelmsford and Westford Roads; thence **Westerly** on Westford Road 580 ft. to a stone wall and land of the late Levi T. Fletcher; thence **Northerly** by wall and Fletcher land 553 ft. to land now or formerly of William C. Edwards; thence **Easterly** by stone wall and Edwards land 343 ft. to a stone bound of George Snow; thence **Southerly** by Snow land 109.5 ft. to a stone bound; thence **Easterly** still by Snow land 180.5 ft. to a stone bound on road from West Chelmsford to Chelmsford Centre; thence **Southerly** by road 490 ft. to the beginning point. Containing 7 acres. Charles A. Lull died April 6, 1932

Jun 2 1927	750/275	Fisher to Lull	Alec Fisher of Westford to Jennie L. Lull of Chelmsford an One Undivided Half interest of land and buildings described as: Beginning at the corner of Chelmsford and Westford Roads; thence running Westerly on Westford Road 580 ft. to a stone wall at land, now or formerly, of Levi C. Fletcher, deceased; thence Westerly on Westford Rd. 76.64 rods to a stone bound; thence Southwesterly on same road 25.93 rods to a stone bound on the Westford-Chelmsford town Line; thence Northerly by town line 76.24 rods to a stone bound supposed to belong to Stoney Brook Railroad Corporation; thence Easterly by land of said Corporation to land now or formerly of Eagle Mill Corporation or both to land, now or formerly, of William C. Edwards; thence Easterly, Southeasterly and Southerly by a stone wall and remains of a stone wall by Edwardsd land to a corner of the wall ; thence Easterly by a stone wall on Edwards land 343 ft. to a stone bound at land formerly of George F. Snow, deceased; thence Southerly by Snow land 109.6 ft. to a stone bound; thence Easterly still by Snow land 180.5 ft. to a stone bound on the road fromm West Chelmsford to Chelmsford Centre; thence Southerly by road 490 ft. to the point of the begining. Containg 32 acres and 153 sq. rods. Francis Fisher, wife
Apr 26 1917	570/384	Edwards to Lull	Margaret D. Edwards of Chelmsford to Frank E. and Charles A. Lull both of Chelmsford as tenants in common Margaret Edwards maiden name - Margaret D. Quist.

Jan 16 1904	362/148	Brown to Quist	James Brown, unmarried, of Lowell to Margaret D. Quist of Chelmsford the land and buildings located in West Chelmsford on the Westerly side of School Street described as: Beginning at the corner of Chelmsford and Westford Roads; thence Westerly on Westford Road 580 ft. to a stone wall and land of the late Levi T. Fletcher; thence Northerly by wall and Fletcher land 553 ft. to land now or formerly of William C. Edwards; thence Easterly by stone wall and Edwards land 343 ft. to a stone bound now or formerly of George Snow; thence Southerly by Snow land 109.5 ft. to a stone bound; thence Easterly still by Snow land 180.5 ft. to a stone bound on road from West Chelmsford to Chelmsford Centre; thence Southerly by road 490 ft. to the beginning point. Containing 7 acres.
May 19 1989	297/548	Gammell to Brown	Pliny F. and Lydia A. Gammell, husband and wife, equal owners, of Chelmsford to James Brown of Chelmsford the land and buildings located in West Chelmsford on the Westerly side of School Street described as: Beginning at the corner of Chelmsford and Westford Roads; thence Westerly on Westford Road 580 ft. to a stone wall and land of the late Levi T. Fletcher; thence Northerly by wall and Fletcher land 553 ft. to land now or formerly of William C. Edwards; thence Easterly by stone wall and Edwards land 343 ft. to a stone bound now or formerly of George Snow; thence Southerly by Snow land 109.5 ft. to a stone bound; thence Easterly still by Snow land 180.5 ft. to a stone bound on road from West Chelmsford to Chelmsford Centre; thence Southerly by road 490 ft. to the beginning point. Containing 7 acres.

Mar 4 1897	283/147	Andrews to Gammell	Charles Andrews of West Chelmsford to Pliny F. and Lydia Amelia Gammell, wife of Pliny, of Lowell a certain lot of land in West Chelmsford being Lot #1: Beginning on the Westerly side of School Street described as: Beginning at the corner of Chelmsford and Westford Roads; thence Westerly on Westford Road 580 ft. to a stone wall and land of the late Levi T. Fletcher; thence Northerly by wall and Fletcher land 553 ft. to land now or formerly of William C. Edwards; thence Easterly by stone wall and Edwards land 343 ft. to a stone bound now or formerly of George Snow; thence Southerly by Snow land 109.5 ft. to a stone bound; thence Easterly still by Snow land 180.5 ft. to a stone bound on road from West Chelmsford to Chelmsford Centre; thence Southerly by road 490 ft. to the beginning point. Containing 7 acres.
------------	---------	--------------------	---