

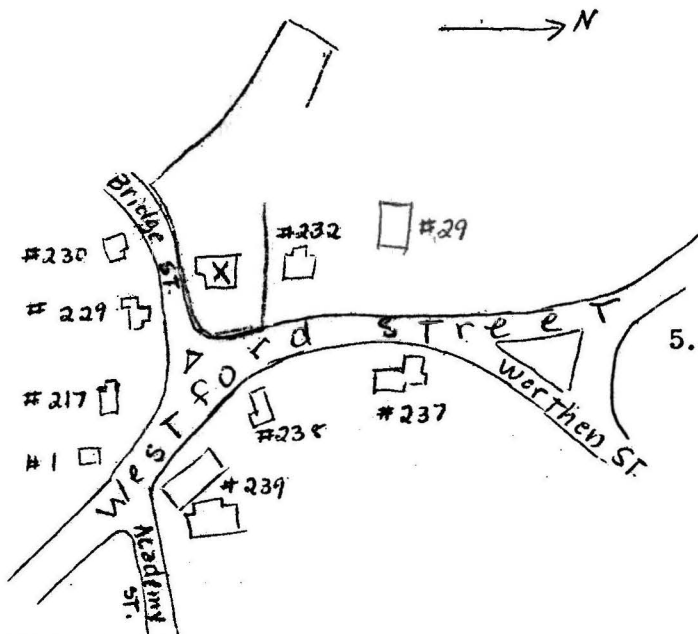

own Chelmsford
 address 8 Westford Street
 name Day House
 present use residence
 present owner Paul & Joyce Caniff
 description
 date 1908
 Source Lowell Courier-Citizen
 style Georgian Revival

4. Map. Draw sketch of building location in relation to nearest cross streets and other buildings. Indicate north.



DO NOT WRITE IN THIS SPACE
 USGS Quadrant _____
 MHC Photo no. _____

Architect _____
 Exterior wall fabric clapboard
 shed
 Outbuildings (describe) garage (1910) - at rear
 Other features hip roof

Altered see attached Date _____
 Moved no Date _____

5. Lot size 1.15 acres
 One acre or less _____ Over one acre X
 Approximate frontage 73 ft. - Westford St.
242 ft. - Bridge St.
 Approximate distance of building from street
 ca. 45 ft. from Bridge St.
 ca 110 ft. from Westford St.

6. Recorded by Jane B. Drury
 Organization Chelmsford Hist. Commission
 Date February 9, 1977

Builder: W.A. Mitchell

(over)

7. Original owner (if known) George W. Day

Original use residence

Subsequent uses (if any) and dates funeral home (1961 - 1969)

8. Themes (check as many as applicable)

Aboriginal		Conservation	Recreation
Agricultural		Education	Religion
Architectural	<u>x</u>	Exploration/ settlement	Science/ invention
The Arts		Industry	Social/ humanitarian
Commerce	<u>x</u>	Military	Transportation
Communication		Political	
Community development			

9. Historical significance (include explanation of themes checked above)

This house was built on the site of the Tufts estate, which had been erected in 1873 or 74 and burned down about 20 years later.

The present building had no architect but did have a contractor, W.A. Mitchell, who compiled ideas from the earlier houses at 12 & 16 Westford St. (#232 & 29) and added features appropriate to the time. Batters for the residence were set in March, 1908. In November, 1908 George W. Day and his bride moved into their recently completed home. Mr. Day was an owner of the successful firm Sweetser & Day, a mill complex located on Beaver Brook in the center of town. He also served as a selectman.

The house was sold out of the Day family in 1937. It remained a residence except for an 8 year period during the 1960s, when it became a funeral parlor under the firm name of William A. Mack & Son.

10 Bibliography and/or references (such as local histories, deeds, assessor's records, early maps, etc.)

Lowell Courier-Citizen: 3/15/1908; 6/22/1908; 11/22/1908; 7/29/1910
Margaret R. & Enslie Mills
Chelmsford Assessors' records
Middlesex North District Registry of Deeds: Bk.1901, p.26 Bk.412, p.150;
Plan Bk.M, Plan 76; Plan Bk. 56, Plan 74
Chelmsford Directory: 1915-16; 1922
Waters, "History of Chelmsford" (1917), pg. 664

INVENTORY FORM CONTINUATION SHEET

MASSACHUSETTS HISTORICAL COMMISSION
Office of the Secretary, Boston

Community: Chelmsford	Form No: 231
Property Name: Day House	

Indicate each item on inventory form which is being continued below.

3. Description
Altered:

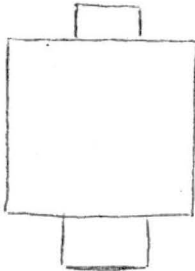

1912 Plan

Scale: 1 inch = 40 ft.

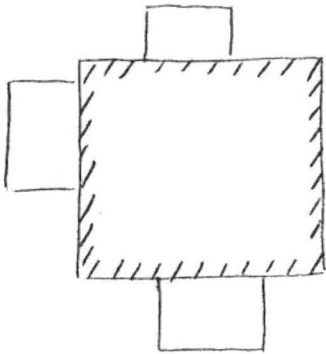

1926 Plan

Scale: 1 inch = 30 ft.

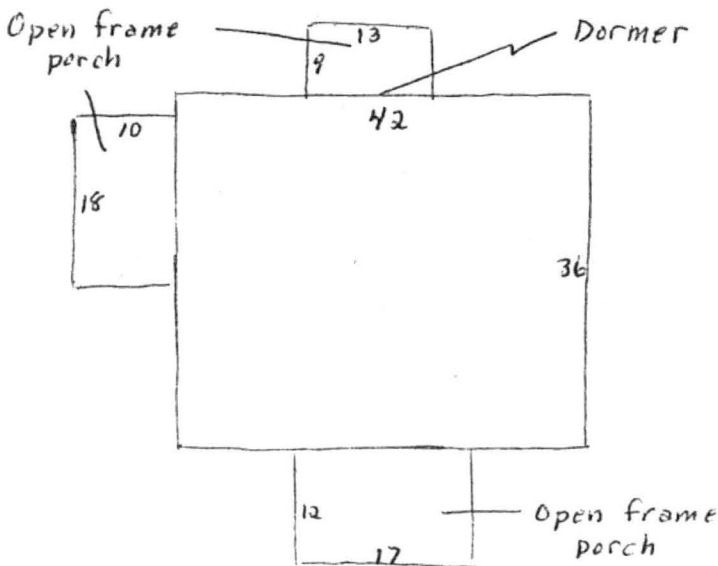

Assessors's Records
1971

Kitchen remodelled - 1969

note by J. Drury:
porch on left side was
enclosed ca 1975

Outside open stairway on right (north) side) added in 1960s.

Staple to Inventory form at bottom

8 Westford Street Lot 100
Middlesex North District Registry of Deeds

Compiled by J. Drury
1/4/1975

Book 1901, Page 26 September 26, 1969	William A. Mack, Jr. to Paul J. & Joyce D. Canniff Buildings thereon 1 acre Subject to \$35944.41 mortgage
Book 1804, Page 253 July 17, 1967	William A. Mack, Jr., surviving partner to William A. Mack, Jr., individually Buildings thereon 1 acre
Book 1542, Page 77 December 27, 1961	William A. Mack, Jr. & Gertrude E. Mack to William A. Mack, Sr. & William A. Mack, Jr. Buildings thereon 1 acre
Book 1535, Page 169 November 1, 1961	Harold E. Clayton to William A. Mack, Jr. & Gertrude E. Mack Buildings thereon 1 acre
Book 1329, Page 433 March 22, 1956	Ruth G. Clayton to Herself and Harold E. Clayton Buildings thereon 1 acre
Book 903, Page 291 August 31, 1937	Daisy L. Day to Ruth G. Clayton Buildings thereon 1 acre
Book 810, Page 364 January 8, 1932	George W. Day to Daisy L. Day Land and buildings thereon
Book 412, Page 150 November 13, 1907	Minnie Dobbins, Lowell, to George W. Day Land
Book 385, Page 227 November 15, 1905	Fred A. Buttrick, Lowell, to Minnie Dobbins \$1 Land
Book 368, Page 535 July 16, 1904	Ira H. Bickford, Boston to Fred A. Buttrick \$800 Public auction, mortgage default Land
Book 327, Page 221 February 1, 1901	William A. & Tessa M. Hoyt to Ira H. Bickford, Boston Mortgage Land
Book 296, Page 106 March 4, 1898	Elmer H. White, Lowell, to Tessa M. Hoyt, \$1 Land
Book 296, Page 104 March 4, 1898	William A. Hoyt, Lowell to Elmer H. White, Lowell \$1 Land
Book 158, Page 419 February 6, 1883	Clara E. Russell to William A. Hoyt \$4000 plus \$2000 mortgage principal Buildings thereon

Book 137, Page 324
January 3, 1880

Burnham C. Benner, Lowell to
Clara E. Russell, wife of James C. Russell,
of Lowell
\$5000

Book 136, Page 55
September 22, 1879

Rebecca S. Tufts, Cambridge, to
Burnham C. Benner, Lowell
\$6500

Middlesex County Probate Office:

Docket #
May 4, 1879

Estate (will) of Edward Tufts to
Rebecca S. Tufts

Book 136; Page 21
August 1, 1873

David A. Bussell to Edward Tufts, Lowell
\$450
Land

Sources:

5. Lowell Citizen-Courier

March 15, 1908. Batters were set on Friday for George W. Day's new residence at the corner of Bridge & Westford streets. W.A. Mitchell has the contract.

June 22, 1908. Mr. & Mrs. George W. Day reached town Friday following a brief wedding trip, and pending the completion of their new home at the corner of Bridge and Westford streets are located at C.A. Aiken's on Westford street.

Nov. 22, 1908. Mr. & Mrs. George W. Day are now occupying their new residence, recently completed at the corner of Westford and Bridge streets.

6. Mrs. Margaret Mills: 8/18/1974 & 3/13/1972

The Caniff's house at 8 Westford Street was built in 1908 by George Day; he had it built by a contractor. It replaced the Tufts house which burned down.

This house had no architect but a contractor instead, and he compiled ideas from these other two houses (#12 & #16 Westford St.). Here notice plate glass windows, piazza out of proportion to the whole with a preponderance of pillars, which goes along with the plate glass, showing more affluence probably. Look back at #16 Westford Street and see what 200 years can do in the manner of architecture. #8 & #13 are built on land that originally went with #16 Westford Street.

Chelmsford Newsweekly May 12, 1977

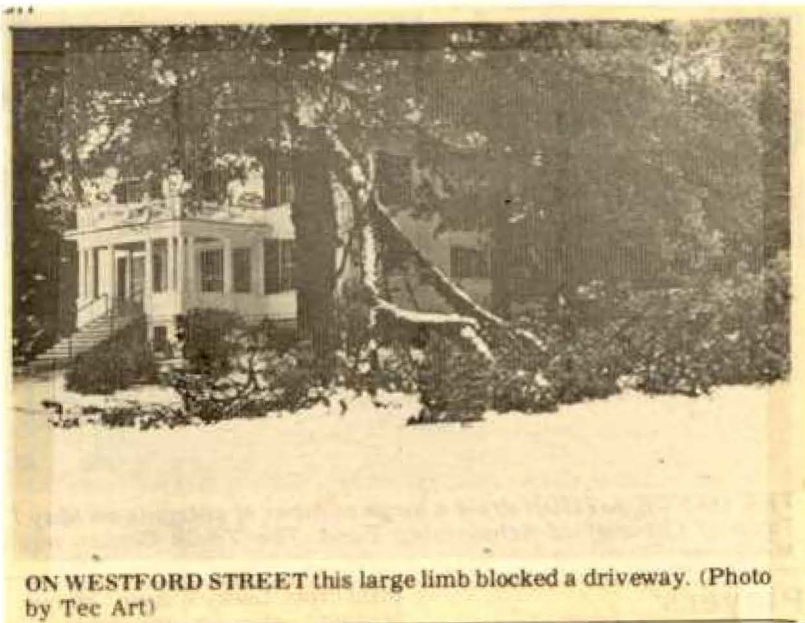

ON WESTFORD STREET this large limb blocked a driveway. (Photo by Tec Art)

8 Westford Street

"Past Glimpses of Westford Street", by Arnold Perham:

....."On the other corner of Bridge Street was a large 2½ story house owned by Mrs. Hoyt; the lot was enclosed by a wooden slat fence with gates, as most all homes were, to keep animals away from home gardens or flower beds. One Sunday noon, just as church services were over, the church bells were rung, and people came from all directions to help save what they could, which was not much as the place was soon ablaze and burned to the ground, about 1892."

Lowell Courier-Citizen:

July 29, 1910 - Garages for Geroge W. Day and Edward J. Robbins at the rear of their residences on Westford street are nearly completed

Chelmsford Directory:

1915/16

Day, George W.-(Sweetser & Day) off Boston road near Central sq., house Westford st. corner Bridge.

1922

Day, George W. (Daisy L.) - selectman, house Westford rd. corner Bridge.

Waters, History of Chelmsford, pg. 664:

:David Perham sold the mill to Edwin E. Dutton in 1884. He operated it in partnership with his brother Lewis M. until 1899, when it was sold to H.C. Sweetser. The firm name was for some years, Sweetser & Day. George W. Day is now the owner. The grist-mill was burned and rebuilt in the early years of its ownership by Mr. Wood."

Enslie Mills, telephone conversation, 2/23/1977:

Dr. Caniff enclosed the porch on the Bridge St. side of the house and made it into a room - within a year or so after he moved in.

Mrs. Margaret Mills - this occurred about 1975.

Margaret Mills, telephone conversation 3/28/1977:

The outside stairway (right side) was added when Mack's were there, so the daughters could go upstairs to their room after school, even if a funeral service were in progress - therefore sometime in the 1960s

From Herbert E. Ellis
to Edward J. Robbins

April 15, 1915.

Mr. Edward J. Robbins,
Denver, Colorado.

Dear Ed:-

Your letter of April 6th came to us in due course of time and found us in about the same condition that you left us. If anything new has happened worth telling when you reach home we will unload in return for some of the vivid descriptions we expect to hear from you.

The postal cards we anticipated receiving giving us some idea of the places you have visited have thus far been a dream only. No doubt it is like many other good things they will come in bunches when they once start to materialize

Father and mother planned to go home today but on receiving word from down east that the weather is uncomfortable and the roads bad, hence they decided to remain at least for another week.

I see Margaret about every day. She seems happy and contented and I think she is having as good a time as you are having. George Day is building a piazza on the Bridge St. side of his house. He has not said so but I think he has done so that he might be able to sit out of doors and not hear you talking when you get home. It can't be on account of the size of his family that he needs more piazza room as so far as I know the only addition is Henry and about twenty chickens.

Florence Colpitts has gone back to work but she is far from being able to do so. She was so unhappy elsewhere, however, they thought it best to allow her to go back. Miss Sinnett is still there helping with the work.

Harry Clapp is well into the work of changing his stable over but finds it fully as much of a job as he anticipated owing to the fact that the old stable was pretty well gone. I am afraid it will cost him dollars where he expected dimes.

The Mill House standing near the middle of Central Square served as a dwelling for the various mill owners throughout much of its history. In early days people usually also used their homes as their office, and that is the situation in this case. During the last half of 1877 Deacon David Perham, the then mill owner and resident in the house, enlarged it at the rear and moved the office into the new section of the house. In 1993 that is the 1 story section with ridge roof, located between the rear chimney and the small 1 story section with fairly flat roof added ca 1943 to the very rear (by Ruby Emery).

The first mill on Beaver Brook was a saw mill erected by John Parker in 1698. Remains of that mill could still be seen when Wilson Waters wrote his history, published in 1917. The entrance to that mill at the upper dam was through what is now Bridge Street, just west of Forefathers' Cemetery. By 1794 it was both a saw mill and a grist mill.

In 1826 the saw & grist mills were moved by Jonathan Parker to the lower location and a new mill erected. The mill pond extended west from behind the house at 24 Central Square, behind and well beyond the ginger ale factory. Railroad tracks were located built on its northern bank. This mill building burned in 1861, was replaced the following year and remained until 1923, when it was torn down. It was replaced by store houses of the J. Cushing Co. The mill pond is well remembered by older residents of Chelmsford, who recall many pleasant hours of skating on it.

Although not the first mill erected in town, this complex located at the center of town served a vital part in the development of Chelmsford. To quote the Lowell Sun (1923), "Our forefathers were very dependent on the miller and consequently anxious to have a mill established as a part of the industries" in the center of town. "The mill yard was filled with the fragrant fresh sawed boards....Loads of corn and other grains were also brought to the old mill by the farmers who raised them, to be ground into meal and flour." During the late 1800s and early 1900s Chelmsford center experienced a huge real estate boom when many, many new houses and some commercial buildings were erected. Billerica Road, Littleton Road, the Westlands, Warren Avenue area, High Street, are just a few areas which were developed at that time. People were flocking out from Lowell to live in the "country", taking the train into the city for their work. The mill, with its office/residence, played an indispensable part in providing lumber for much this construction. Ice to cool many local ice boxes came from the pond until replaced by electricity in the Twentieth Century.

Moses Hale, a part owner, ran the mills in the 1820s (he also erected and ran carding & powder mills on the Concord River in what is now Lowell). George S. Wood, a Billerica man, purchased the mill property in 1849 and moved into the house. It was he who rebuilt the mill burned in 1861. A company called the Chelmsford Mill Co. operated the business for about twenty years and consisted of Deacon David Perham (deacon of the Central Baptist Church, miller, & resident of the house), Dr. Levi Howard, Benjamin Minot Fiske, and E. King Parkhurst, all very prominent men in Chelmsford. He gave up the property in 1884 because of advanced age. The Dutton Brothers, Edwin E. & Lewis M., bought it from Mr. Perham. Herbert Sweetser later owned it with George W. Day, and they ran it under the name of Sweetser & Day, for 21 years. Mr. Day also dealt with poultry feeds, roofing, farm machinery and tools. He put in power grinding at the mill, "operating a saw mill in the winter, to which many logs were drawn. He employed many men, and his teams covered a wide territory, his specialty being the Town's trade."



8 Westford Street (far left)

1974





