

# FORM B – BUILDING

MASSACHUSETTS HISTORICAL COMMISSION  
 MASSACHUSETTS ARCHIVES BUILDING  
 220 MORRISSEY BOULEVARD  
 BOSTON, MASSACHUSETTS 02125

Assessor's Number USGS Quad Area(s) Form Number

13/33/6	Tyngsboro		314
---------	-----------	--	-----

**Town** Chelmsford  
**Place** (*neighborhood or village*) North Chelmsford  
**Address** 25 – 27 Wright Street  
**Historic Name** John Bradley House  
**Uses: Present** residence, 2 family  
**Original** residence  
**Date of Construction** 1874  
**Source** tax/real estate valuation records

## Photograph



MA\_Chelmsford\_WrightStreet\_25-27\_IMG\_0179 CHC\_05

**Style/Form**

**Architect/Builder**

**Exterior Material:**

**Foundation** cut granite blocks ca 6-10" & concrete addition at left rear: concrete  
**Wall/Trim** clapboard  
**Roof** front: ridge, front to back rear: ridge, left to right  
**Outbuildings/Secondary Structures** no

## Sketch Map

Draw a map showing the building's location in relation to the nearest cross streets and/or major natural features. Show all buildings between inventoried building and nearest intersection or natural feature. Label streets including route numbers, if any. Circle and number the inventoried building. Indicate north.

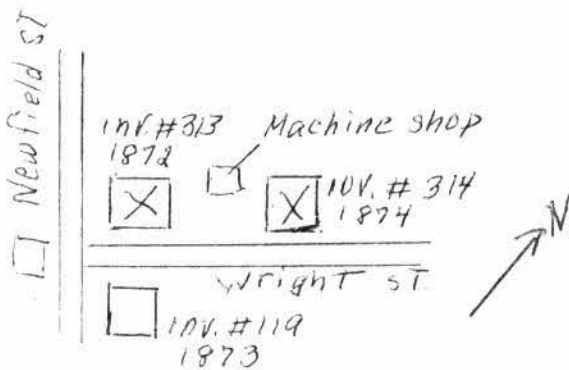

## Major Alterations (with dates)

ca 1937: "restored to liveable condition"; piazzas added to east side; soon after piazza enclosed & windows installed.  
 before 1988: piazza removed

1976: 1½ story addition behind bay window, left side

**Condition** good

**Moved**  no  yes **Date**

**Acreage** 11,200 sq. ft.

**Setting** This is in a thickly residential area. To the right is a church with parking lot & playground, & other house. In back is a house on Shaw St. A dirt drive leads up along the left side.

**Recorded by** Jane B. Drury

**Organization** for Chelmsford Historical Commission

**Date** (month year) July 2007

## BUILDING FORM

### ARCHITECTURAL DESCRIPTION *see continuation sheet*

*Describe architectural features. Evaluate the characteristics of this building in terms of other buildings within the community.*

This two family residence is typical of many other houses of similar age in Chelmsford. Many of its exterior architectural features were removed or hidden by new siding probably in the 1930s, when it was restored from its then "dilapidated" condition.

### HISTORICAL NARRATIVE *see continuation sheet*

*Discuss the history of the building. Explain its associations with local (or state) history. Include uses of the building, and the role(s) the owners/occupants played within the community.*

Otis D. Wright owned the land for both this house at 25-27 Wright Street, and the house next to it at 37-39 Wright Street at the corner of Newfield St.. Benjamin Fletcher purchased the property numbered 25-27 Wright St. and constructed this residence 1874, but sold it the following year to the North Chelmsford mill owner, George C. Moore. In 1886 Ellen G. Bradley bought the property, and she and her husband, John Bradley, became the first owners to actually live here. In April 1896 Ellen's son George Hodge married Mamie Huntoon in Boston, and the newly weds with their infant son Harold Bradley born in 1897 lived at 25-27 Wright St. with the Bradleys until moving next door to 37-39 Wright St. in 1898. John Bradley was an inventor and in 1900 his "new machine shop" was built in the lot between the two houses. The machine shop is still in existence on the property of 37-9 Wright St. It is not known what he invented there, however. The shop was not moved; its location was on a separate lot between the two houses. During the night of February 3, 1907 John Bradley died of influenza.

Ellen Bradley lived in and retained ownership this house until 1921. However, the Hodge family moved back with her in 25-27 Wright St. In addition to their first child, Harold, George Y. and Mamie Hodge came with Helma Louise, born in 1899, and Millard, born in 1901, when George was working as a milkman. However, he soon became an iron moulder, an occupation he held until shortly before his retirement. As a grown woman, Hilma became a nurse, and her brother Millard joined the US Navy, but Harold remained a student until he became a surveyor and married Rena. In 1921 Ellen Bradley died at age 78 years and 8 months and was buried with her husband in the Edson Cemetery in Lowell. The Hodge family remained here until the early 1930s, when they moved back next door to 37-39 Wright St.

This house remained empty for several years and became dilapidated. Neighboring children played in it and called it the "haunted house", although it wasn't, of course. In 1937 Stewart MacKay purchased the property. He restored the house to a livable condition, although he never resided here. He put piazzas on the east side, and shortly before his death they were enclosed and windows installed. The piazzas have since been removed. Stewart MacKay was a professor at Lowell Technological School (now part of U MA Lowell). As a hobby, he made rock maple looms for hospital therapy in the separate workshop located at the rear of the lot between the two houses, which is John Bradley's old machine shop, built in 1900. The Mackay looms were very popular, and he couldn't make enough to keep orders supplied. The finished product were loaded into Mr. MacKay's car and driven down to the railroad station to be shipped. Mr. MacKay and his sister, Anna, lived in what later became the MacKay Library on Newfield Street, and for many years Mrs. Essie Young was the housekeeper. Mrs. Young inherited the two houses in 1947.

### BIBLIOGRAPHY and/or REFERENCES *see continuation sheet*

Middlesex North District Reg. of Deeds: Bk.95, pg. 558; 1873; Probate records  
Chelmsford Assessors' records; Building Inspector records; Town Clerk's records (vital records)  
Raymond G. Gauthier, 14 Shaw St., 12/21/1988  
Chelmsford street directories  
Obituaries

Recommended for listing in the National Register of Historic Places. *If checked, you must attach a completed National Register Criteria Statement form.*

# INVENTORY FORM CONTINUATION SHEET

Town  
CHELMSFORD

Property Address  
25-27 WRIGHT ST.

MASSACHUSETTS HISTORICAL COMMISSION  
MASSACHUSETTS ARCHIVES BUILDING  
220 MORRISSEY BOULEVARD  
BOSTON, MASSACHUSETTS 02125

Area(s) Form No.

	314
--	-----

## HISTORY

Apparently by 1943 the house had been fixed up sufficiently for Thomas & Helen Gibbons to live living there in one apartment, and Thomas & Ruth Broscombe in the other apartment with his mother, Lucy Broscome. Thomas & Ruth Broscombe were both bookkeepers. Thomas Gibbons was a salesman. In 1949 or 50 Essie Young, the owner, moved in with her granddaughter, Alva, the Gibbons having left. The Youngs stayed here about 7 years. In 1969 Mrs. Young sold the property to to Carl & Donna Stanley, who moved into 27 Wright St., from 21 Diamond St. The Stanleys rented out the other apartment. He was a senior mechanical technician. They had three children born here: Carl Jr., Cynthia, Kim and Erika. In 1999 the property was sold to the present owner. It is still a two family residence.

## ALTERATIONS

- 1937 ca House had been empty; "restored to livable condition"  
1975/6 Addition & alteration: 12" concrete block foundation: 18 ft. x 8 ft.  
Contractor: Hayden & Hayden, P.O. Box G, Billerica; C. Hays, 1209 Staples St., Lowell  
Architect: C. Hays  
wood frame addition: left side of house; pitched roof  
1988 "sidings put on before now, cover many old architectural details"

July 21, 2007





**INVENTORY FORM CONTINUATION SHEET**

Town  
**CHELMSFORD**

Property Address  
**25-27 WRIGHT ST.**

MASSACHUSETTS HISTORICAL COMMISSION  
MASSACHUSETTS ARCHIVES BUILDING  
220 MORRISSEY BOULEVARD  
BOSTON, MASSACHUSETTS 02125

Area(s) Form No.

	314
--	-----

*July 21, 2007*

*Right side of house*



# INVENTORY FORM CONTINUATION SHEET

CHELMSFORD 25-27 WRIGHT ST.

MASSACHUSETTS HISTORICAL COMMISSION  
MASSACHUSETTS ARCHIVES BUILDING  
220 MORRISSEY BOULEVARD  
BOSTON, MASSACHUSETTS 02125

Area(s) Form No.

	314
--	-----

## Locational Information

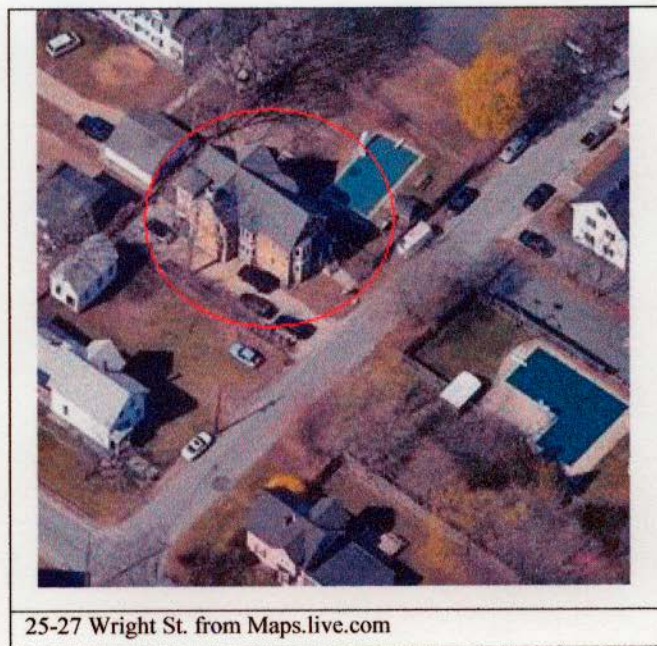
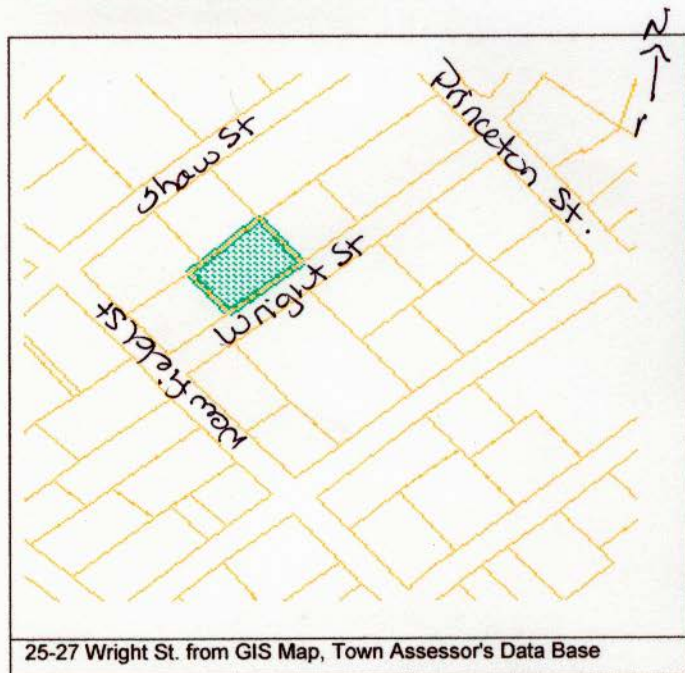

27 Wright Street

Bk. 10047, pg. 27	3/30/1999	Carl T. & Donna J. Stanley to Burk C. Wright, 25-27 Wright St. 160,000 11,200 sq. ft & buildings: northwest side Wright St. Lots 3,4 on 1937 Central Savings Bank plan, Bk. Plans 60, plan 51 same: 1969 Young plan, bk. 1898, pg. 785
Bk. 1898, pg. 785	9/20/1969	Essie L. Young, unmarried, to Carl T. & Donna J. Stanley, 21 Diamond St., North Chelmsford land & buildings: northwest side of Wright St. 11,200 sq/ ft.: Lots 3 & 4 - 1937 bank plan
Middlesex Probate Docket #279678	Will 1947	Estate Stewart MacKay to Essie L. Young
Bk. 905, pg. 144	10/1/1937	Central Savings Bank, Lowell, to Stewart MacKay Lots 3,4,5: 1937 bank plan
Bk. 182, pg. 459	7/21/1886	George C. Moore to Ellen G. Bradley \$3000 land & buildings
Bk. 109, pg. 79	4/1/1875	Benjamin Fletcher to George C. Moore \$2500 land & buildings
Bk. 95, pg. 56	7/29/1873	Albert R. Choate to Benjamin Fletcher \$300 land: some of lot3, Lot 4, &? same: Adams to Choate 1871
Bk. 80, pg. 484	6/30/1871	Benjamin Adams to Albert R. Choate land
Bk. 95, pg. 558	7/31/1873	Otis D. Wright to Benjamin Fletcher \$125 land same as part of: Adams to Wright
Bk. 81, pg. 136	6/30/187	Benjamin Adams to Otis D. Wright land: Lots 1,2, & most of 3





